

LEASEHOLD - SHARE OF
FREEHOLD



Flat

3 CRESCENT ROAD, SIDCUP, DA15 7HN

Guide price

£260,000

FEATURES

- TWO DOUBLE BEDROOM SPLIT-LEVEL MAISONETTE
- CHRISTCHURCH CONSERVATION AREA
- SHARE OF FREEHOLD
- GUIDE PRICE £260,000 - £280,000
- NO FORWARD CHAIN
- SPLIT BETWEEN FIRST AND SECOND FLOORS



Westwood
PROPERTY SERVICES

2 Bedroom Flat located in Sidcup

Call us on
020 8301 5511
sales@westwoodpropertyservices.co.uk

Guide Price £260,000 - £280,000

Located within the highly sought after "Christchurch Conservation Area" is this two double bedroom split-level maisonette. The property has it's own front door with stairs leading to the accommodation which is split over the first and second floors and although in need of modernisation this maisonette offers a great opportunity. In brief the maisonette comprises entrance hall, living room, kitchen dining room, two second floor double bedrooms and a three piece bathroom. Additional points to note are a garage en-bloc, double glazing and no forward chain.

Council Tax Band
C

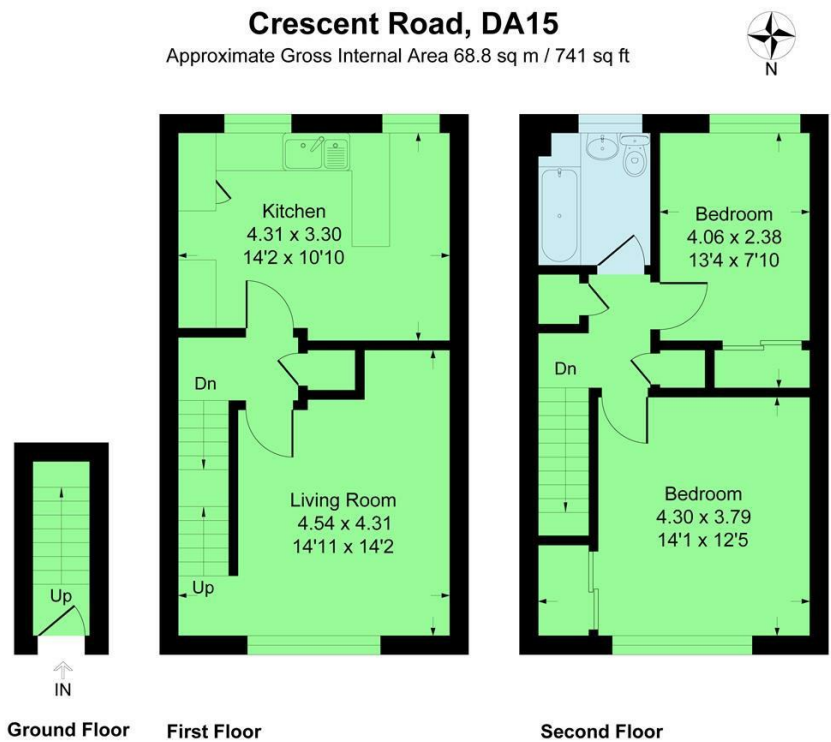

This plan is for layout guidance only. Not drawn to scale unless stated. Windows and door openings are approximate. Whilst every care is taken in the preparation of this plan, please check all dimensions, shapes and compass bearings before making any decisions reliant upon them.
Produced By Planpix

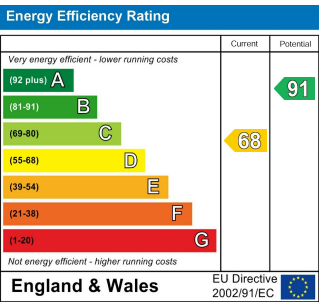

Agents Note: Whilst every care has been taken to prepare these particulars, they are for guidance purposes only. All measurements are approximate and are for general guidance purposes only and whilst every care has been taken to ensure their accuracy, they should not be relied upon and potential buyers are advised to recheck the measurements.

