



House (EPC Rating: B)

FLAT 92 TABBARD APARTMENTS, EAST ACTON LANE, LONDON, W3 7LA

£3,000

2 Bedroom House located in London

AVAILABLE BEGINNING JULY

Nestled in the vibrant area of East Acton Lane, London, this contemporary house offers a perfect blend of modern living and comfort. Built in 2022, the property boasts a fresh and stylish design, making it an ideal choice for those seeking a new home in a bustling urban environment.

Spanning an impressive 753 square feet, the house features two well-proportioned bedrooms, providing ample space for relaxation and rest. The two bathrooms are thoughtfully designed, ensuring convenience and privacy for residents and guests alike. The inviting reception room serves as a welcoming space for entertaining or unwinding after a long day, enhancing the overall appeal of this delightful home.

The location is particularly advantageous, with excellent transport links and local amenities within easy reach. Residents can enjoy the vibrant community atmosphere, with a variety of shops, cafes, and parks nearby, making it a perfect setting for both families and professionals.



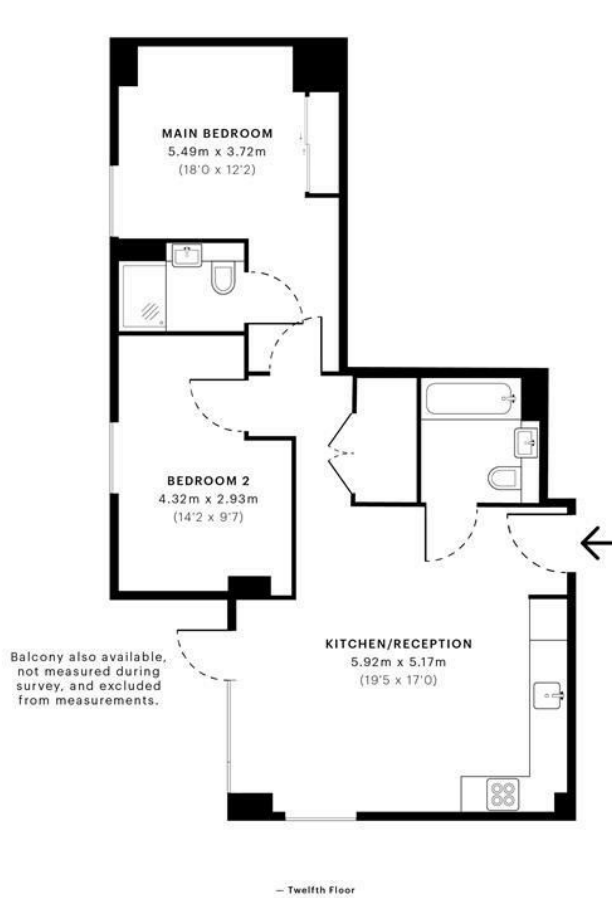

Legend for floor plan symbols:

- Overall Internal Area (shaded area): 68.44 sqm / 736.68 sqft
- Net Internal Area (dashed outline): 65.62 sqm / 706.33 sqft
- Optional Structural Features (grid pattern): 0.00 sqm / 0.00 sqft
- Restricted Area (person icon): 0.00 sqm / 0.00 sqft

Logos: spec Verified, RICS Certified Property Measurer

Spec Verified floor plans are produced in accordance with:
 Royal Institution of Chartered Surveyors' Property Measurement Standards.
 Plans and graphics are illustrative only and excluded from all area calculations.
 Due to rounding, numbers may not add up precisely.
 All measurements shown for the individual room lengths and widths are the maximum points of measurements captured in the scan.

Spec ID: 563ad821e5de3cd0de5378b5f

Council Tax Band

Energy Performance Graph

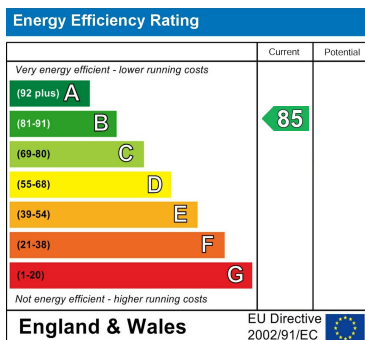

Call us on
07366 611 667
 bernie@wreality.co.uk
 wreality.co.uk

Agents Note: Whilst every care has been taken to prepare these particulars, they are for guidance purposes only. All measurements are approximate and are for general guidance purposes only and whilst every care has been taken to ensure their accuracy, they should not be relied upon and potential buyers are advised to recheck the measurements.