

64 Chiswick Village, London, W4 3BZ  
£2,150 Per month  
Council Tax Band: C



A beautifully presented two double bedroom apartment situated on the second floor of this well-maintained private purpose-built development.

The accommodation comprises a spacious reception room with an area for dining, fully fitted modern kitchen, two bedrooms and family bathroom.

Further benefits to this property include access to well-kept communal gardens, lift and secure entrance.

Chiswick Village is located moments away from both Kew Bridge and Gunnersbury Stations, A4/M4 and Heathrow. The River Thames is also within close proximity along with an array of amenities along the Chiswick High Road.



Building 7, Chiswick Park  
566 Chiswick High Road  
London  
W4 5YG  
02082260189  
oliver@addisongrove.co.uk

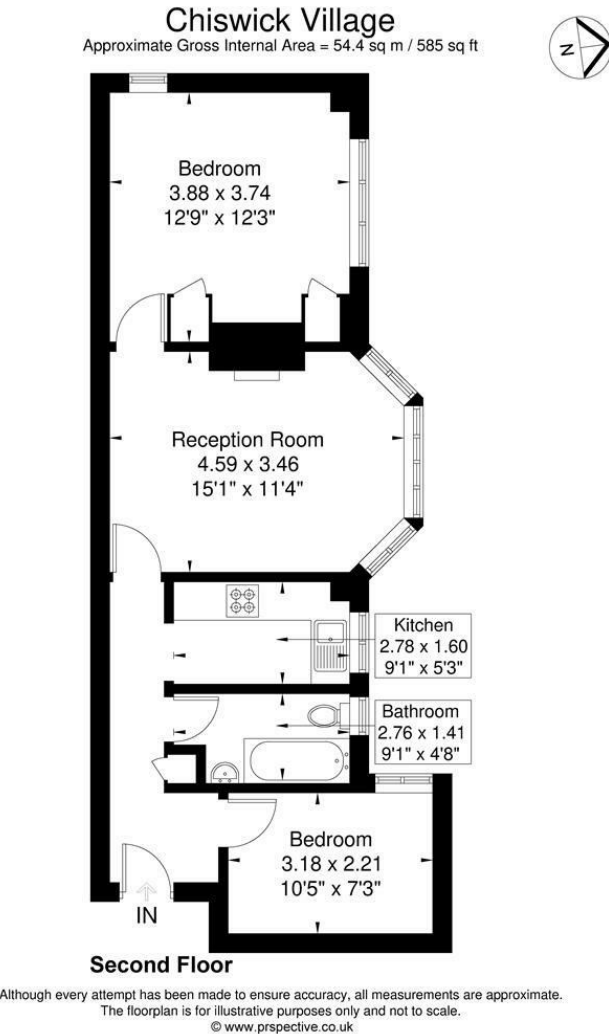

Energy Efficiency Rating		
	Current	Potential
Very energy efficient - lower running costs		
(92 plus) <b>A</b>		
(81-91) <b>B</b>		
(69-80) <b>C</b>		
(55-68) <b>D</b>		
(39-54) <b>E</b>		
(21-38) <b>F</b>		
(1-20) <b>G</b>		
Not energy efficient - higher running costs		
<b>England &amp; Wales</b>	EU Directive 2002/91/EC	