

# The Alverton

at Victoria Mews

2 bedroom home



Contact our team for  
more information today

0151 290 7891

info@livvhomes.com

livvhomes.com

**Livv**  
homes

# The Alverton

at Victoria Mews

## Ground floor

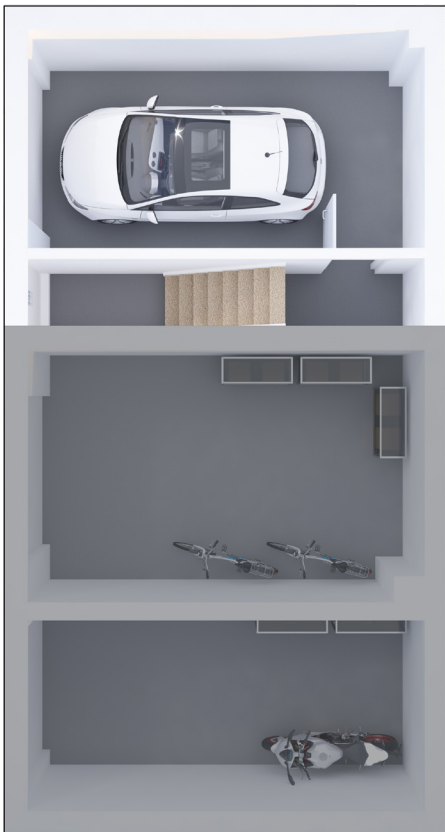

Garage 5.49m x 2.99m | 18' x 9'9"

## First floor



Lounge/kitchen/dining	5.44m x 3.7m   17'10" x 12'1"
Master bedroom	3.95m x 3.03m   12'11" x 9'11"
Ensuite	2.05m x 1.42m   6'8" x 4'7"
Bedroom 2	2.66m x 3.78m   8'8" x 12'5"
Bathroom	1.72m x 1.83m   5'8" x 6'

All measurements are to the widest point

[livvhomes.com](https://www.livvhomes.com)

Computer generated images and floor plans are for illustrative purposes only. They depict a typical layout and style of the individual plot, and do not constitute a contract, part of a contract or warranty. Features and finishes vary from plot to plot. For exact plot specifications please contact our sales team. All dimensions are approximate and you should undertake your own measurements before ordering any flooring, fixtures, fittings or furniture.

