

Spyglass House

Loxbury Rise, Torquay, Devon, TQ2 6RT





Spyglass House

Loxbury Rise, Torquay, Devon, TQ2 6RT

**Detached 4 Bed Bungalow in Need of Some Modernisation
Occupying a Generous Corner Plot with Large Driveway & Garage
Nestled in the Quiet Residential Location of Cockington Overlooking Fields
Development Potential Subject to Planning Permission
Offered for Sale with No Onward Chain**

LOCATION

Located at the top end of Chelston, the bungalow sits on a large corner plot above Cockington Village with views across fields and woodland. Although located in a quiet residential location, the bungalow is still close to local amenities at Walnut Road and rail & road links.

DESCRIPTION

Spyglass is well appointed with a good size kitchen, 'L' shaped dining & living room making the most of the views, 4 bedrooms, modern shower room and utility room. The bungalow has a room located to the side known as the playroom which is accessed from the front of the property. This area could be utilised as an annex for Air BnB or as a Granny Flat or to create Ensuite bathrooms to 2 of the bedrooms. The large driveway and car port off Loxbury Rise offers parking for circa 4 cars. The garage is accessed from Loxbury Road with steps leading up to the front garden. The Bungalow has lawned gardens to the side and front and a wrap round patio.

The property would benefit from a degree of modernisation and remodelling making this the perfect opportunity for any buyer looking to put their own stamp on a property. Alternatively, there is potential for extending the property further to create a house over 2 floors or for complete redevelopment subject to planning permission.

Ref No: 5090

£450,000 Freehold

Interested in this property?
T.01803 21 20 21 [bettesworths.co.uk](https://www.bettesworths.co.uk)





Spyglass House

Loxbury Rise, Torquay, Devon, TQ2 6RT

The property comprises:-

The Bungalow can be accessed via the Driveway & Carport and also from the Garden Entrance.

DRIVEWAY & CARPORT

With entrance to:-

UTILITY ROOM

6' 5" x 13' 11" (1.963m x 4.252m)

Wall & floor mounted cupboards, sink with drainer, plumbing for washing machine and tumble drier. Shower room and separate WC.

KITCHEN

12' 1" x 12' 3" (3.673m x 3.729m)

Tile effect laminate flooring, wall & floor mounted cupboards, roll top work surfaces, sink with drainer, external extraction, larder cupboard. Window overlooking the car port.

DINING ROOM / SITTING ROOM

Dining room section - 8' 11" x 13' 3" (2.73m x 4.028m)

Sitting room section - 21' 4" x 11' 3" (6.514m x 3.427m)

'L' shaped room accessed via the kitchen or central hallway. Glass sliding door providing access to the patio, garden and driveway. Picture window to the front.

CENTRAL HALLWAY

With access to:-

BEDROOM 1

12' 11" x 10' 10" (3.942m x 3.299m)

Good size double with rear aspect.

BEDROOM 2

12' 11" x 8' 11" (3.931m x 2.721m)

Double with front aspect.

BEDROOM 3

8' 7" x 9' 7" (2.611m x 2.931m)

Single with front aspect.

FAMILY SHOWER ROOM

8' 6" x 9' 10" (2.6m x 2.992m)

Newly fitted with walk in shower, WC & wash hand basin.

BOILER ROOM

LINEN CUPBOARD

Steps down to:-

BEDROOM 4

10' 3" x 8' 10" (3.122m x 2.68m)

Twin with front aspect.

Main door access to both sides of the property and:-

Interested in this property?

T.01803 21 20 21 bettesworths.co.uk



Spyglass House

Loxbury Rise, Torquay, Devon, TQ2 6RT

PLAYROOM

7' 2" x 23' 7" (2.187m x 7.2m)

Currently used for storage. Access to rear yard.

OUTSIDE

Level lawned garden accessed via the driveway and dining area. Wrap round Patio. Garage off Loxbury Road. Slopped front garden with potential to terrace.

Rear yard off utility room.

GENERAL INFORMATION

The property is fitted uPVC windows & external doors and gas central heating.

TENURE

Freehold.

UTILITIES

The property is connected to all mains services.

COUNCIL TAX BAND E

EPC AWAITED

VIEWING

Viewing is highly recommended and can be arranged by prior appointment with the Sole Agents, Bettesworths. Tel. 01803 212021.



Interested in this property?

T.01803 21 20 21 [bettesworths.co.uk](https://www.bettesworths.co.uk)



Spyglass House

Loxbury Rise, Torquay, Devon, TQ2 6RT



Interested in this property?
T.01803 21 20 21 bettesworths.co.uk





Spyglass House

Loxbury Rise, Torquay, Devon, TQ2 6RT



Interested in this property?
T.01803 21 20 21 bettesworths.co.uk



Spyglass House

Loxbury Rise, Torquay, Devon, TQ2 6RT



Interested in this property?
T.01803 21 20 21 bettesworths.co.uk





Spyglass House

Loxbury Rise, Torquay, Devon, TQ2 6RT



Interested in this property?
T.01803 21 20 21 bettesworths.co.uk





Spyglass House

Loxbury Rise, Torquay, Devon, TQ2 6RT



Interested in this property?
T.01803 21 20 21 [bettesworths.co.uk](https://www.bettesworths.co.uk)



Spyglass House

Loxbury Rise, Torquay, Devon, TQ2 6RT



Interested in this property?
T.01803 21 20 21 [bettesworths.co.uk](https://www.bettesworths.co.uk)





Spyglass House

Loxbury Rise, Torquay, Devon, TQ2 6RT

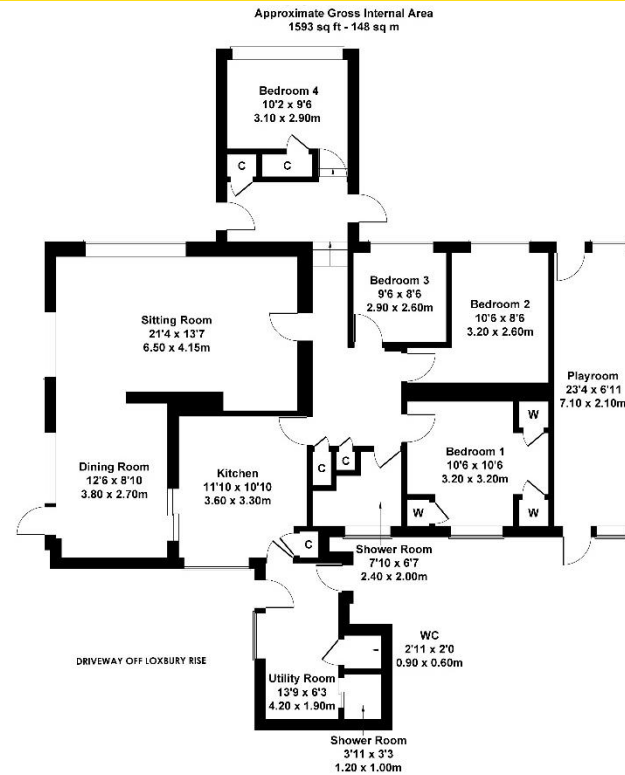

Not to Scale. Produced by The Plan Portal 2025
For Illustrative Purposes Only.

www.bettesworths.co.uk
29/30 Fleet Street
Torquay
Devon
TQ1 1BB



IMPORTANT NOTE: Messrs Bettesworths for themselves and for the vendors or lessors of this property whose agents they are give notice that: (i) the particulars are produced in good faith, are set out as a general guide only and do not constitute any part of a contract; (ii) no person in the employment of Messrs Bettesworths has any authority to make or give representation or warranty whatever in relation to this property. The fittings, equipment and services have not been tested by the agents.

Interested in this property?
T.01803 21 20 21 bettesworths.co.uk

