



310 Whelley, Wigan

In Excess of £150,000



310 Whelley

Wigan, Wigan

Exquisite 3-bed end of terrace in New Springs. Modern family home with spacious open plan living area, fitted breakfast kitchen, 3 bedrooms, family bathroom, low maintenance rear garden. Conveniently close to Wigan Town Centre and Haigh Woodland Park. Ideal blend of comfort and contemporary living.

Council Tax band: A

Tenure: Leasehold

EPC Energy Efficiency Rating: D

EPC Environmental Impact Rating: D

- Beautifully presented modern family home
- Extended to the rear to provide open plan living
- Close to Wigan Town Centre & Haigh Woodland Park
- Modern fitted breakfast kitchen with family room
- Two double bedrooms plus a single
- Contemporary family bathroom with four piece suite in white
- Fully enclosed low maintenance rear garden

Living room

Kitchen diner / family room

Bed 1

Bathroom

Bed 2

Bed 3





GARDEN





GROUND FLOOR
491 sq.ft. (45.7 sq.m.) approx.

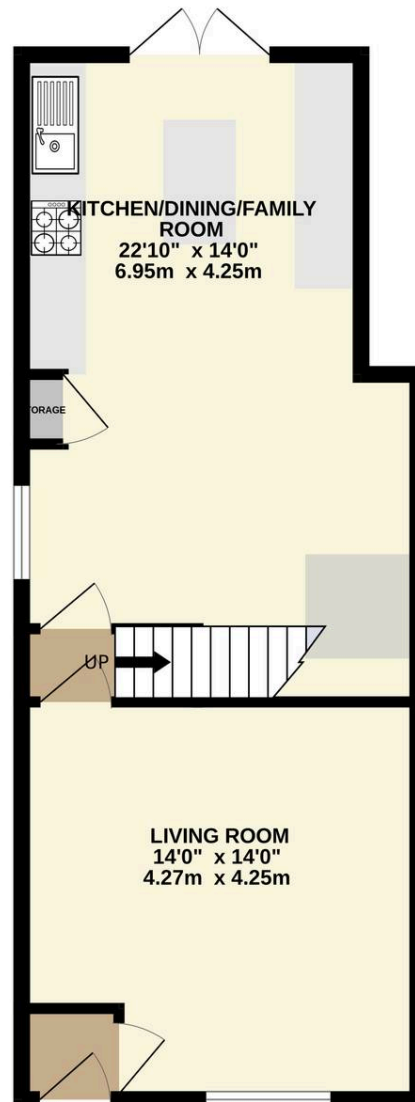

1ST FLOOR
412 sq.ft. (38.2 sq.m.) approx.

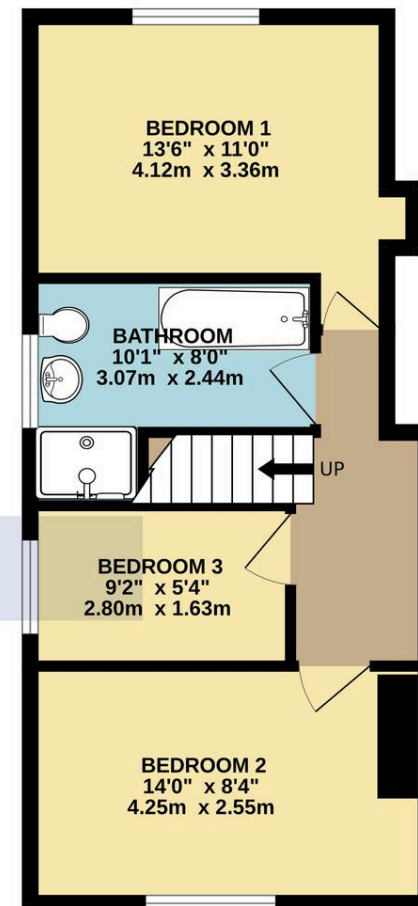

TOTAL FLOOR AREA : 903 sq.ft. (83.9 sq.m.) approx.

Whilst every attempt has been made to ensure the accuracy of the floorplan contained here, measurements of doors, windows, rooms and any other items are approximate and no responsibility is taken for any error, omission or mis-statement. This plan is for illustrative purposes only and should be used as such by any prospective purchaser. The services, systems and appliances shown have not been tested and no guarantee as to their operability or efficiency can be given.
Made with Metropix ©2024

Batt

Alan

You can include any text here. The text can be placed upon the image.

— SALES & LETTINGS —