



**51 MANSFIELD ROAD
CHESSINGTON
KT9 2PX
£325,000**

FIRST FLOOR MAISONETTE

TWO BEDROOMS

14'6 X 11' LIVING ROOM

12'8 X 7'5 KITCHEN BREAKFAST ROOM

WHITE BATHROOM SUITE

DOUBLE GLAZED WINDOWS

GAS CENTRAL HEATING

SOUTH WESTERLY FACING GARDEN

AN IDEAL FIRST TIME BUY

VIEWINGS HIGHLY RECOMMENDED

1st Floor
60.0 sq.m. (646 sq.ft.) approx.

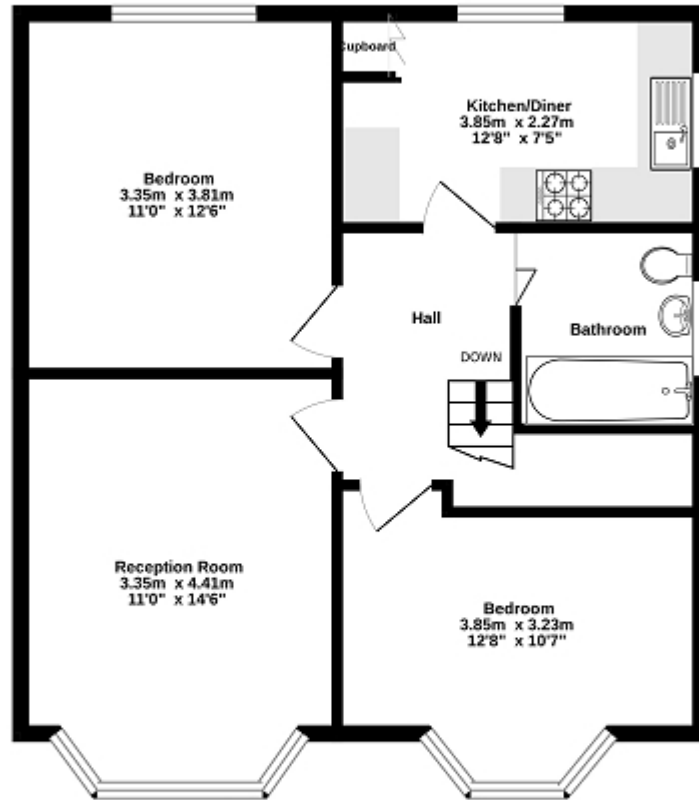

TOTAL FLOOR AREA : 60.0 sq.m. (646 sq ft.) approx.
While every effort has been made to ensure the accuracy of the floorplan contained herein, measurements of doors, windows, rooms and any other items are approximate and no responsibility is taken for any error, omission or misstatement. This plan is for illustrative purposes only and should be used as such by any prospective purchaser. The services, systems and appliances shown have not been tested and no guarantee as to their operability or efficiency can be given.
Made with floorplan 12/2020



Energy Efficiency Rating

	Current	Potential
Very energy efficient - lower running costs		
(92+) A		
(81-91) B		
(69-80) C	69	74
(55-68) D		
(39-54) E		
(21-38) F		
(1-20) G		
Not energy efficient - higher running costs		
England, Scotland & Wales EU Directive 2002/91/EC		

The energy efficiency rating is a measure of the overall efficiency of a home. The higher the rating the more energy efficient the home is and the lower the fuel bills will be.