



**106 FRIMLEY ROAD
CHESSINGTON
SURREY
KT9 1QT
£340,000**

FIRST FLOOR MAISONETTE

TWO BEDROOMS

13'9 X 13'2 LIVING ROOM

9'8 X 9'1 MODERN KITCHEN

MODERN WHITE BATHROOM SUITE

GAS CENTRAL HEATING

DOUBLE GLAZED WINDOWS

35' X 39' WELL MAINTAINED GARDEN

SUMMER HOUSE TO REAR

AN IDEAL FIRST TIME BUY



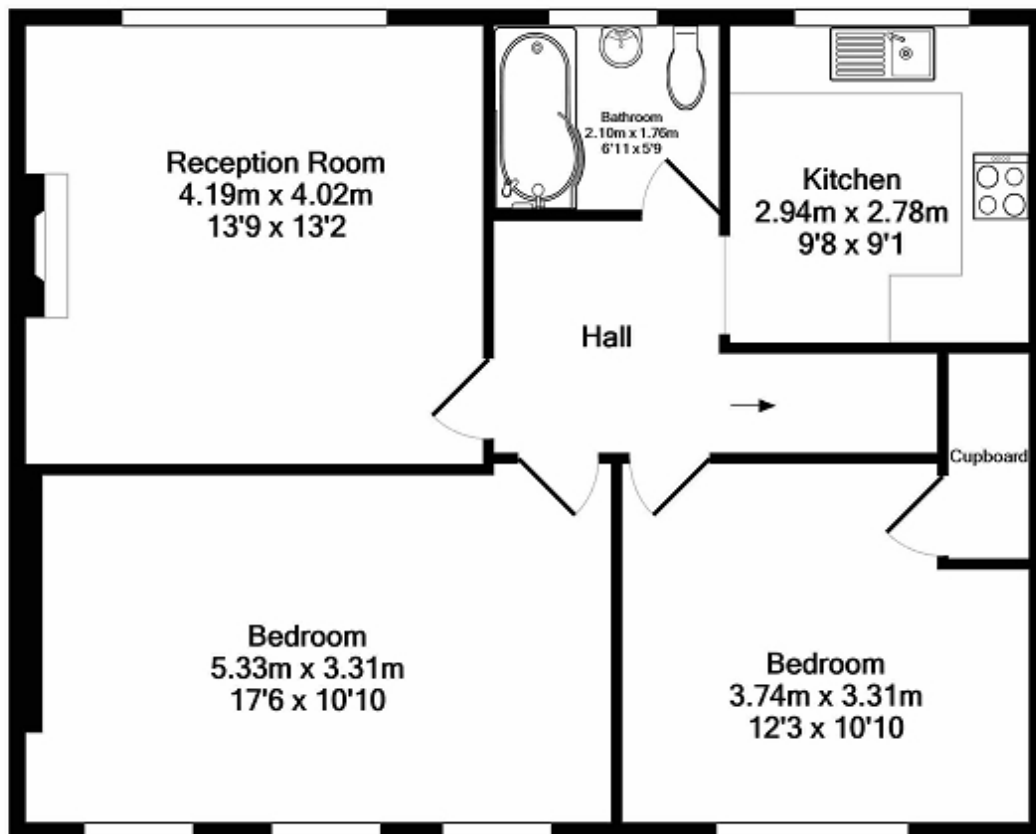

Total Approx. Floor Area 65.0 Sq.M. (700 Sq.Ft.)

Whilst every attempt has been made to ensure the accuracy of the floor plan contained here, measurements of doors, windows, rooms and any other items are approximate and no responsibility is taken for any error, omission, or mis-statement. This plan is for illustrative purposes only and should be used as such by any prospective purchaser. The services, systems and appliances shown have not been tested and no guarantee as to their operability or efficiency can be given
Made with Metropix ©2020

Energy Efficiency Rating		
	Current	Potential
Very energy efficient - lower running costs		
(92+) A		
(81-91) B		
(69-80) C		
(55-68) D	64	64
(39-54) E		
(21-38) F		
(1-20) G		
Not energy efficient - higher running costs		
England, Scotland & Wales EU Directive 2002/91/EC 		

The energy efficiency rating is a measure of the overall efficiency of a home. The higher the rating the more energy efficient the home is and the lower the fuel bills will be.