



Pennine Drive,
Cannock, WS11 1JX

£280,000

£280,000



Paul Carr Estate Agents are delighted to market this chain free two bedroom detached Bungalow of Hednesford Road, Cannock with excellent access to local amenities, transport links and schools.

This property briefly comprises an Entrance Hall, Lounge-Diner, Kitchen, Family Bathroom, two Bedrooms, Utility and Porch.

Situated on a generous plot, the property frontage features both tarmac and blockpaved driveways with space for multiple vehicles. The generous rear garden is predominantly laid to lawn with mature trees and shrubbery in addition to a storage shed, greenhouse with side gated access.





Property Specification

Large Fitted Kitchen & Adjacent Utility
22ft+ Lounge
Two Double Bedrooms
Detached Garage
Generous Frontage For Five Vehicles

Hall

Lounge

11' 11" x 22' 1" (3.63m x 6.74m)

Kitchen

17' 9" x 8' 2" (5.42m x 2.48m)

Porch

8' 2" x 6' 3" (2.49m x 1.91m)

Utility

9' 5" x 6' 3" (2.88m x 1.91m)

Bedroom 1

11' 11" x 12' 0" (3.63m x 3.65m)

Bedroom 2

11' 11" x 9' 10" (3.63m x 2.99m)

Shower Room

Garage

Agent's Note:

Every care has been taken with the preparation of these Sales Particulars but they are for general guidance only and complete accuracy cannot be guaranteed. If there is any point which is of particular importance, professional verification should be sought. The mention of any fixtures, fittings and/or appliances does not imply they are in full efficient working order as they have not been tested. All dimensions are approximate. Photographs are reproduced for general information and it cannot be inferred that any item shown is included in the sale. These Sales Particulars do not constitute a contract or part of a contract.
Came on the market: 31st January 2025

Services connected: Gas, Electricity, Water, Drainage
Council tax band: D
Tenure: Freehold

Floor Plan

This floor plan is not drawn to scale and is for illustration purposes only

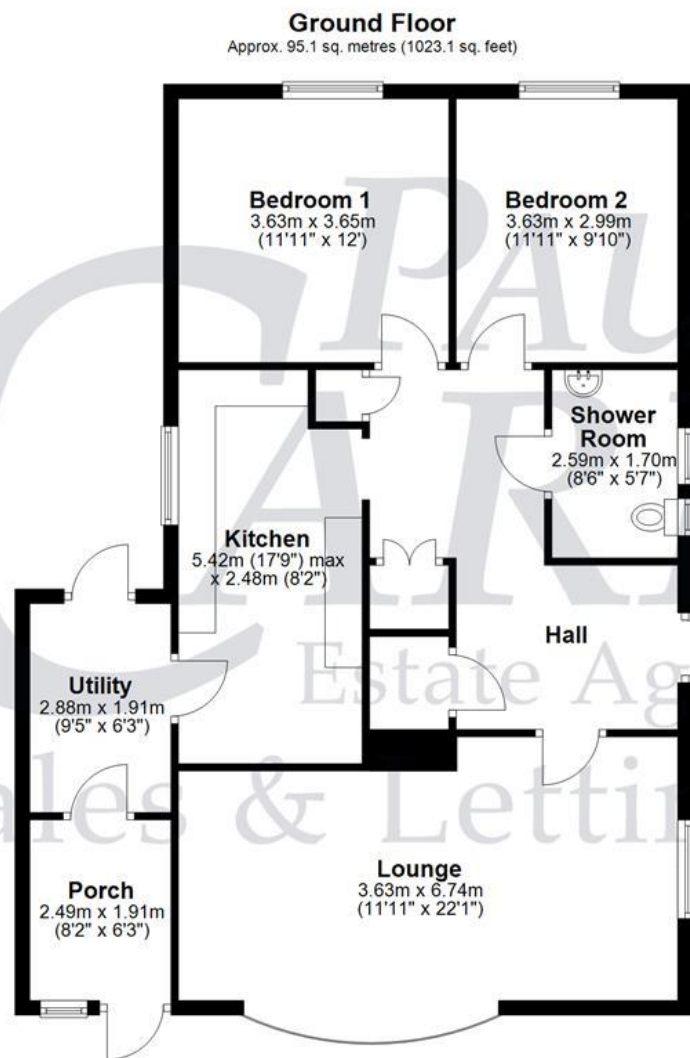

Energy Efficiency Rating

Score	Energy rating	Current	Potential
92+	A		
81-91	B		
69-80	C		80 C
55-68	D	62 D	
39-54	E		
21-38	F		
1-20	G		

Map Location

