



3 Bed  
House - End  
Terrace  
located in

Offers in excess of  
£250,000



**MN**  
**MaddoxNoel**  
ESTATE & LETTINGS AGENTS

## Trenchard Drive

Approximate Gross Internal Area  
991 sq ft - 92 sq m

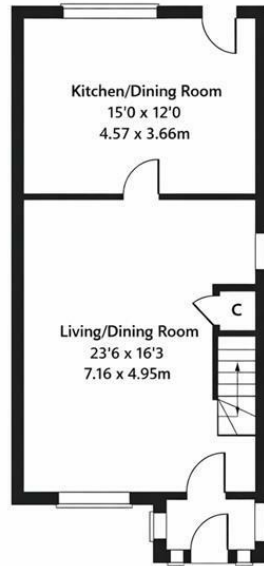

GROUND FLOOR

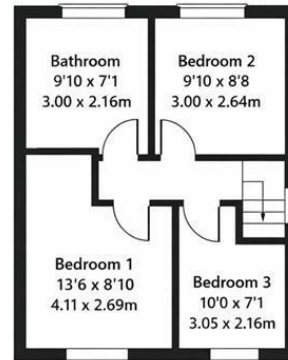

FIRST FLOOR

## DIRECTIONS

The property is well positioned for commuters, with Manchester Airport approximately 1.5 miles away, offering both domestic and international travel. The area is served by regular bus routes and nearby Metrolink tram services at Manchester Airport, providing direct connections into Manchester city centre and across Greater Manchester. Road users benefit from easy access to the

## CONTACT

Colony One  
Suite 1.24 1 Silk Street  
Ancoats  
Manchester

E: [hello@maddoxnoel.com](mailto:hello@maddoxnoel.com)  
T: 0161 543 3406  
[www.maddoxnoel.com](http://www.maddoxnoel.com)

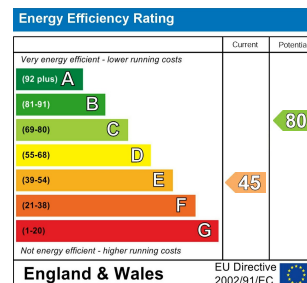

MaddoxNoel

ESTATE & LETTINGS AGENTS