



2 Bed  
House  
located  
in Haslingden

£725 Per month



**MN**  
**MaddoxNoel**  
ESTATE & LETTINGS AGENTS

GROUND FLOOR  
588 sq.ft. (54.6 sq.m.) approx.



1ST FLOOR  
930 sq.ft. (86.4 sq.m.) approx.

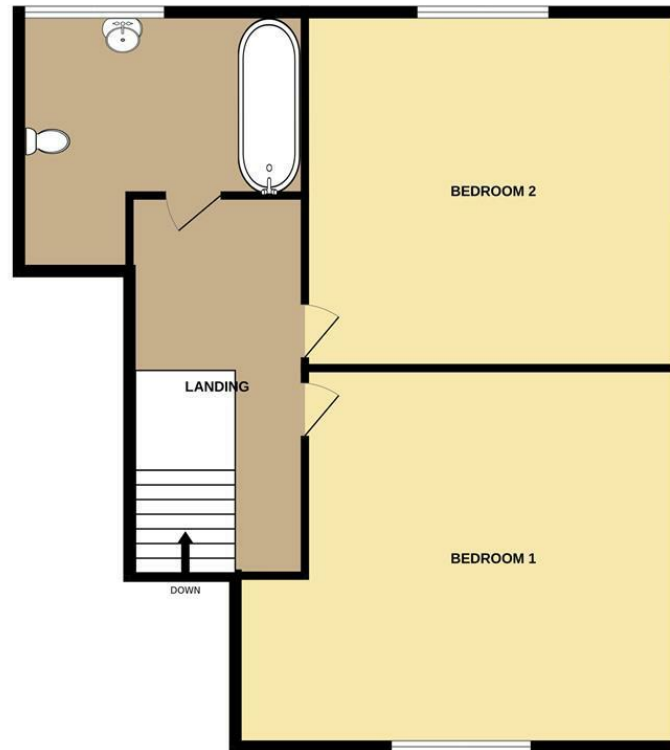

TOTAL FLOOR AREA : 1518 sq.ft. (141.0 sq.m.) approx.

Whilst every attempt has been made to ensure the accuracy of the floorplan contained here, measurements of doors, windows, rooms and any other items are approximate and no responsibility is taken for any error, omission or mis-statement. This plan is for illustrative purposes only and should be used as such by any prospective purchaser. The services, systems and appliances shown have not been tested and no guarantee as to their operability or efficiency can be given.  
Made with Metropix ©2025

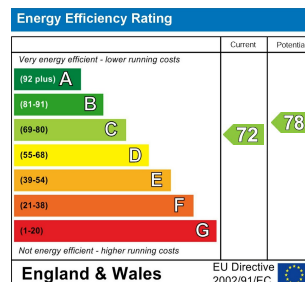

## DIRECTIONS

The nearest public transport options to 5 Grane Road, Haslingden, BB4 5EB include several bus stops within 200?m, with the closest being Highfield Street (Grane Road, by) at approximately 0.1?miles, followed by Bowling Green (Helmshore Road, by) at 158?m. For rail travel, the nearest mainline station is Accrington, around 6.3?km away, while other nearby stations include

## CONTACT

Colony One  
Suite 1.24 1 Silk Street  
Ancoats  
Manchester  
M4 6LZ

E: [hello@maddoxnoel.com](mailto:hello@maddoxnoel.com)  
T: 0161 543 3406  
[www.maddoxnoel.com](http://www.maddoxnoel.com)



MaddoxNoel

ESTATE & LETTINGS AGENTS