



WIKE RIDGE FARM WIKE RIDGE LANE

NORTH LEEDS, LS17 9JF

£1,250,000
FREEHOLD

Wike Ridge Farmhouse presents a rare opportunity to acquire a chain-free, six-bedroom, four-bathroom stone-built farmhouse dating back to the 1700s. This redeveloped home also benefits from impressive South Facing gardens and a garage.

MONROE

SELLERS OF THE FINEST HOMES

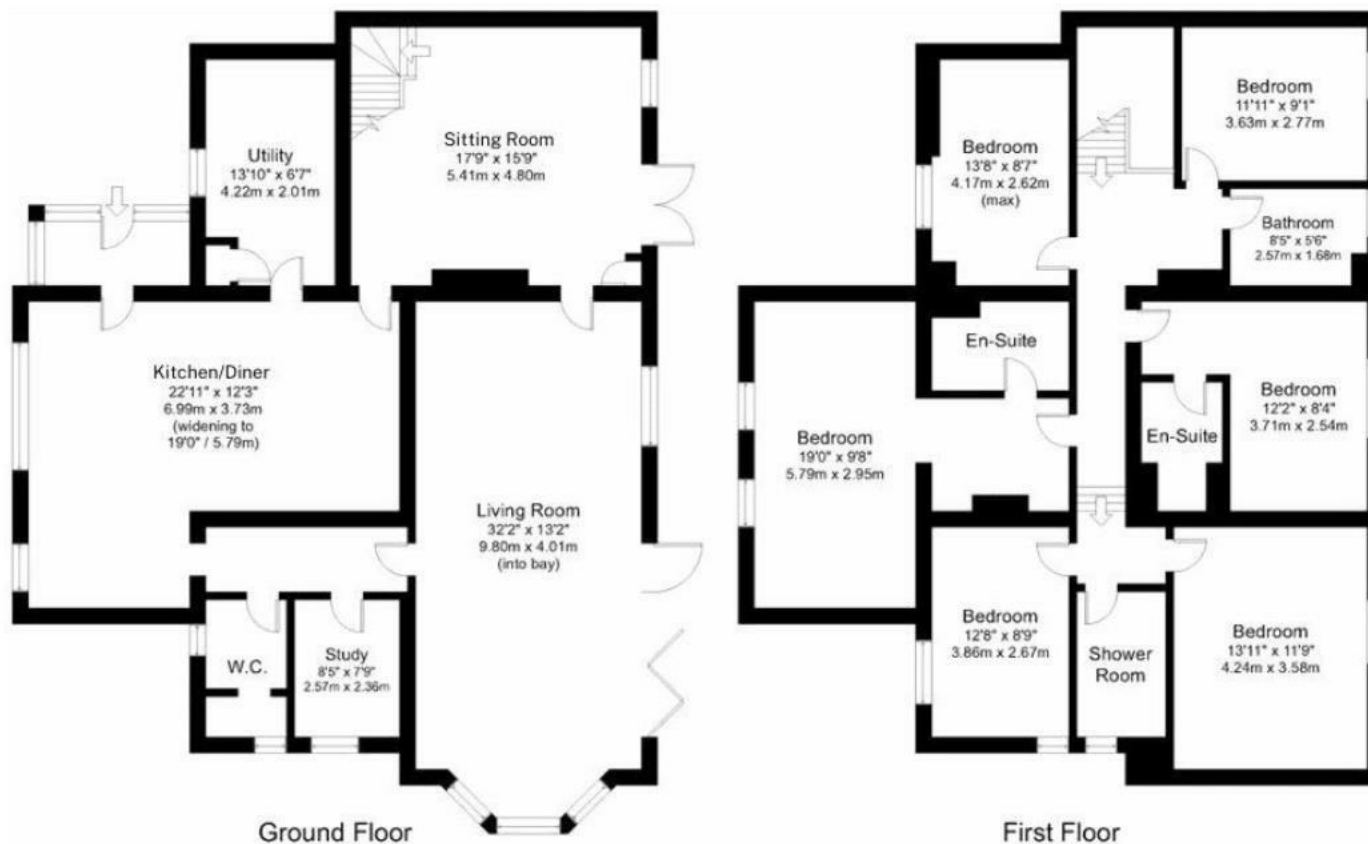

Gross internal floor area (approx.): 266.7 sq m (2,871 sq ft)

First Floor

Not to Scale. Copyright © Apex Plans.
For illustrative purposes only.



Energy Efficiency Rating		
	Current	Potential
Very energy efficient - lower running costs		
(92 plus) A		93
(81-91) B		
(69-80) C	72	
(55-68) D		
(39-54) E		
(21-38) F		
(1-20) G		
Not energy efficient - higher running costs		
England & Wales	EU Directive 2002/91/EC	

Agents Note: Whilst every care has been taken to prepare these particulars, they are for guidance purposes only. All measurements are approximate and are for general guidance purposes only and whilst every care has been taken to ensure their accuracy, they should not be relied upon and potential buyers/tenants are advised to recheck the measurements

Land & New Homes
1-3 The Avenue
Alwoodley
Leeds
West Yorkshire
LS17 7BD

0113 350 1444
landandnewhomes@monroestateagents.com
www.monroestateagents.com

MONROE

SELLERS OF THE FINEST HOMES