



GFF 2 Dundonald Road

Redland, Bristol, BS6 7LW

£2,400 Per month



* Student Property - Available July 2026 *

Nestled in the desirable Redland area of Bristol, this charming flat on Dundonald Road offers an ideal living space for students.

The property comprises of a spectacular, bright and airy large reception room with impressive bay window, a separate modern fully fitted kitchen/diner with access to the rear private garden, three generous double bedrooms and a large family bathroom. The kitchen is equipped with an oven/hob, washing machine and fridge freezer.

The property is located in the very desirable area of Redland (BS6) just a stone's throw away from Durham Downs and a short walk to Whiteladies Road and Henleaze High Street on either side with all the shops, restaurants and supermarkets.



- Lounge
- Kitchen/Diner
- Bedroom1
- Bedroom2
- Bedroom3
- Bathroom

Area Map



Floor Plans

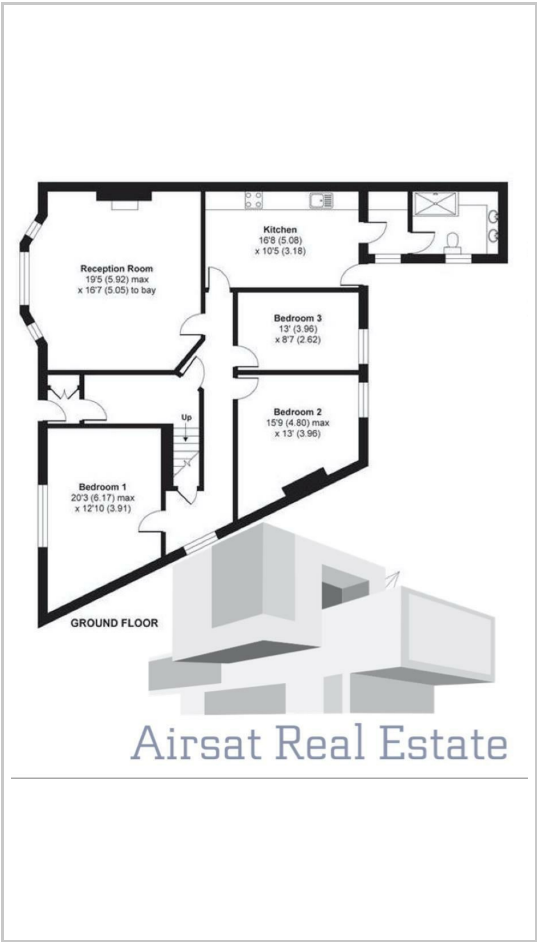

Energy Efficiency Graph

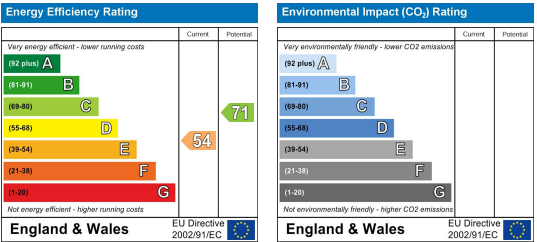

These particulars, whilst believed to be accurate are set out as a general outline only for guidance and do not constitute any part of an offer or contract. Intending purchasers should not rely on them as statements of representation of fact, but must satisfy themselves by inspection or otherwise as to their accuracy. No person in this firms employment has the authority to make or give any representation or warranty in respect of the property.

