

# DELISA MILLER



**2 Double Bedrooms**

**Modern Kitchen and Bathroom**

**Recently Refurbished**

**Fantastic Location**

**Close to Transport Links**



**124 Hulme High Street**  
Manchester, M15 5JP

**Monthly Rental Of**  
**£1,100**

GROUND FLOOR

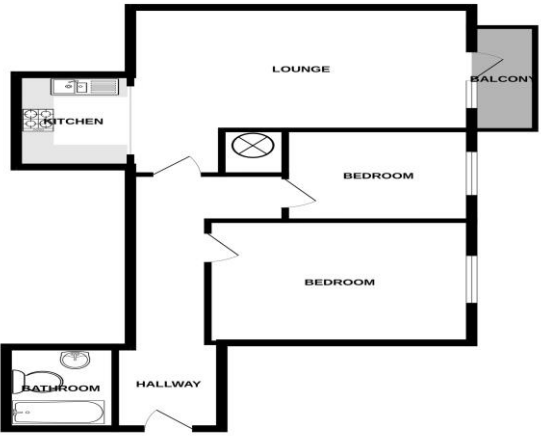

While every attempt has been made to ensure the accuracy of the floorplan contained here, measurements of plots, buildings, contents and any other items are approximate and no responsibility is taken for any error, omission or mis-statement. This plan is for illustrative purposes only and should not be used as a legal document, professional certificate. The layout, dimensions and any other details shown are for illustrative purposes only and should not be used as a legal document. Made with Metaplan ©2025

