



1/2, 18 HYNDLAND ROAD
GLASGOW

www.domus-letting.co.uk





1 | BEDROOM

1 | BATHROOM

1 | PUBLIC ROOM

Set within a traditional red sandstone tenement, a well presented one-bedroom flat located in the heart of Hyndland, one of the West End's most sought-after locations. The property delivers a tasteful blend of period character and modern touches, with generously proportioned accommodation throughout.

The internal layout comprises welcoming reception hallway with storage off, impressive front-facing lounge with full-height bay window and original hardwood flooring, a modern fitted kitchen with integrated appliances and ample workspace, spacious double bedroom with tasteful neutral décor and quality furnishings, and a bathroom complete with walk-in shower, freestanding bath, WC and wash hand basin, all set against contemporary tiling and mirrored wall detailing. Further features include gas central heating and secure door entry. Residents enjoy on-street parking via permit and access to well maintained communal areas.

Hyndland remains one of the West End's most desirable districts, with a wide range of independent shops, cafés and restaurants within walking distance. The property is ideally positioned for Hyndland train station and a range of bus links, offering quick access to the city centre and beyond. An excellent opportunity to secure a classic West End flat in a prime location.



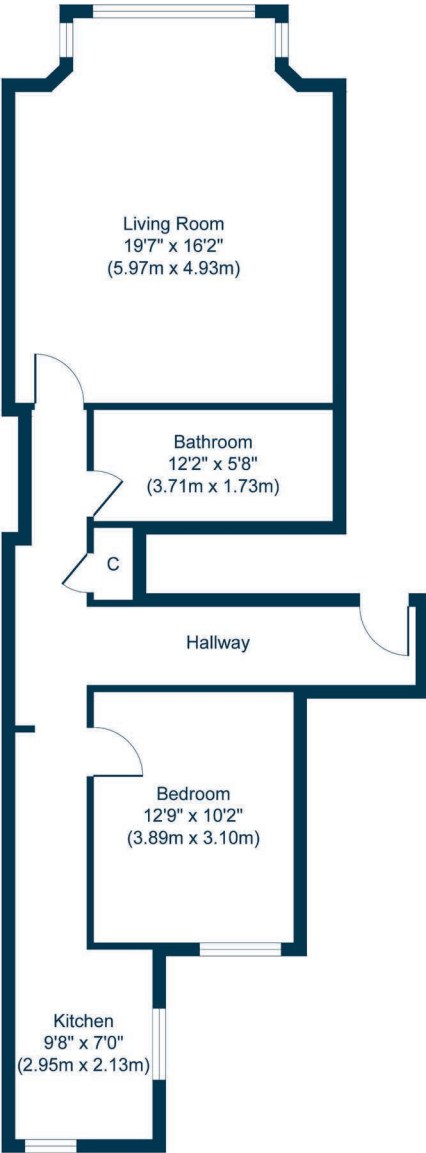

Property ID: 101 | Sat Nav: 1/2, 18 Hyndland Road, Glasgow, G12 9UP

To find out more about this property, visit www.domus-letting.co.uk

* All measurements and distances are approximate Floorplans are for illustration purposes and may not be to scale.



Domus Letting
20 Blythswood Square, Glasgow, G2 4BG

Tel: 0141 428 4422

Email: lettings@domus-letting.co.uk

www.domus-letting.co.uk

LARN:2409007



Let with confidence

www.domus-letting.co.uk