



Churchfields, Bishops Cleeve, Cheltenham, GL52
£250,000

**ADAM
HALLIWELL**
property

EXPERIENCE
exp UK

Bedrooms: 2

Bathrooms: 1

Receptions: 1

A well-presented two-bedroom terraced house in the heart of Bishops Cleeve, offering a light kitchen-diner opening to an enclosed garden, two double bedrooms, garage and parking, easy access to village amenities and transport links, and sold with no onward chain.

This two-bedroom terraced house is offered for sale in good condition in the heart of Bishops Cleeve, Cheltenham. Well-suited to first-time buyers, investors, downsizers and retired purchasers, it benefits from parking, a single garage and an enclosed garden.

The ground floor features a separate living room to the front and a kitchen/diner positioned at the rear of the property. The kitchen enjoys good natural light, provides space for dining and opens directly onto the garden, creating a practical layout for everyday living and easy access outdoors.

Upstairs, there are two double bedrooms. The main bedroom includes built-in wardrobes, providing useful storage. The bathroom is located on the first floor and is fitted with a bath with shower over.

Externally, the property includes a garden and the added convenience of a single garage and parking. The home has an EPC rating of C and falls within Council Tax Band C.

The property is very central to the shops in Bishops Cleeve, with village amenities approximately a 3-minute walk (0.1 mile) away, including everyday services, cafés and local retailers. The area offers nearby parks and established walking routes, with access to the Cotswold countryside and open green spaces around the village.

Bishops Cleeve provides convenient links to Cheltenham town centre by bus and road, where Cheltenham Spa railway station offers services to Bristol, Birmingham and London. Local schools and further amenities are available within Bishops Cleeve and the wider Cheltenham area, supporting a range of lifestyle and commuting needs.

The property is offered with no onward chain.





Property Type: Terraced House

This two-bedroom terraced house is offered for sale in good condition in the heart of Bishops Cleeve, Cheltenham. Well-suited to first-time buyers, investors, downsizers and retired purchasers, it benefits from parking, a single garage and an enclosed garden.

The ground floor features a separate living room to the front and a kitchen/diner positioned at the rear of the property. The kitchen enjoys good natural light, provides space for dining and opens directly onto the garden, creating a practical layout for everyday living and easy access outdoors.

Upstairs, there are two double bedrooms. The main bedroom includes built-in wardrobes, providing useful storage. The bathroom is located on the first floor and is fitted with a bath with shower over.

Externally, the property includes a garden and the added convenience of a single garage and parking. The home has an EPC rating of C and falls within Council Tax Band C.

The property is very central to the shops in Bishops Cleeve, with village amenities approximately a 3-minute walk (0.1 mile) away, including everyday services, cafés and local retailers. The area offers nearby parks and established walking routes, with access to the Cotswold countryside and open green spaces around the village.

Bishops Cleeve provides convenient links to Cheltenham town centre by bus and road, where Cheltenham Spa railway station offers services to Bristol, Birmingham and London. Local schools and further amenities are available within Bishops Cleeve and the wider Cheltenham area, supporting a range of lifestyle and commuting needs.

The property is offered with no onward chain.

- Central Bishops Cleeve village location
- Two double bedrooms upstairs
- Bright kitchen with dining space
- Single garage plus parking
- Built-in wardrobes to main bedroom
- No onward chain
- Excellent transport links to Cheltenham
- Modern bathroom and kitchen
- Enclosed rear garden
- End of the cul de sac location



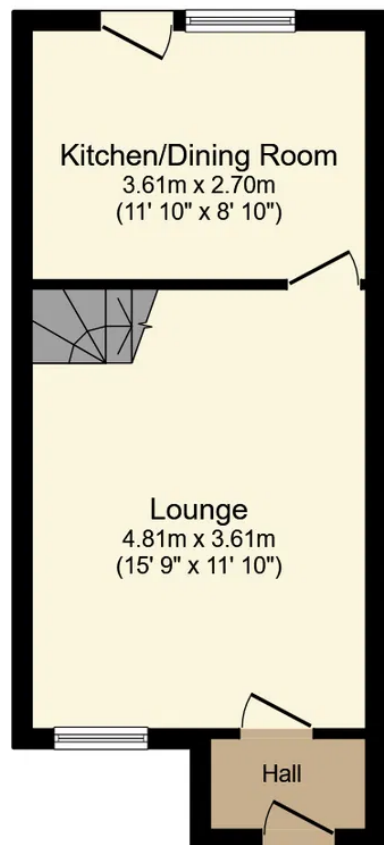

Ground Floor
Floor area 29.1 sq.m. (313 sq.ft.)

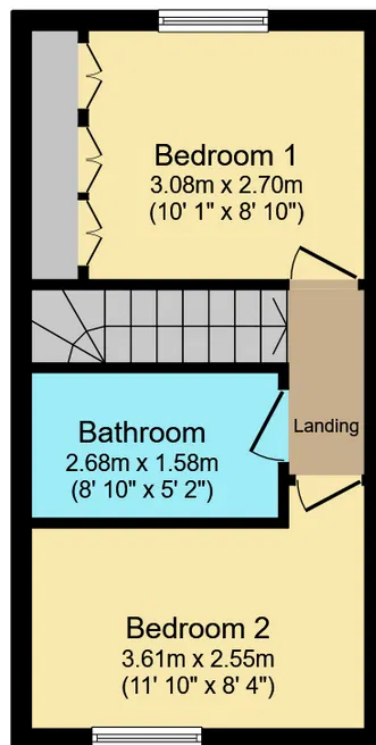

First Floor
Floor area 27.3 sq.m. (294 sq.ft.)

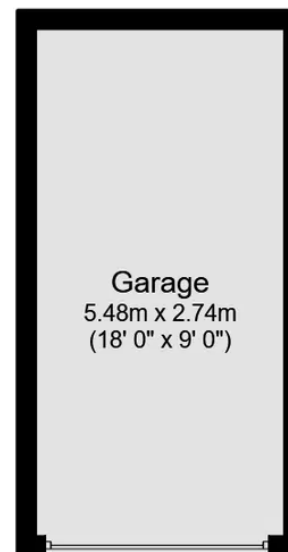

Garage
Floor area 14.7 sq.m. (158 sq.ft.)

Total floor area: 71.1 sq.m. (765 sq.ft.)

This floor plan is for illustrative purposes only. It is not drawn to scale. Any measurements, floor areas (including any total floor area), openings and orientations are approximate. No details are guaranteed, they cannot be relied upon for any purpose and do not form any part of any agreement. No liability is taken for any error, omission or misstatement. A party must rely upon its own inspection(s). Powered by www.Propertybox.io

Churchfields, Bishops Cleeve, Cheltenham, GL52
£250,000

**ADAM
HALLIWELL**
property

exp UK