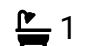

St Michaels Court Cheltenham Road, Bishops Cleeve, Cheltenham, GL52

£95,000

 1  1

A one bedroom, first floor apartment in this over 55's development within half a mile radius of Bishops Cleeve's amenities. The well presented accommodation offers a good sized lounge, kitchen with fitted appliances and bedroom with built in wardrobe. There is also a shower room with walk in shower. Communal facilities are provided, parking and grounds to enjoy. Sold with no onward chain.

Floor Area

481 sq. ft.

Tenure

Leasehold

Service Charge

£3498.6 per annum

Ground Rent

£395 per annum

- Over 55's development
- No onward chain
- Balcony
- Shower room
- Management fees apply
- Double bedroom with built in wardrobe
- First floor apartment
- Modern electric heating
- Store/airing cupboard
- Communal parking and facilities

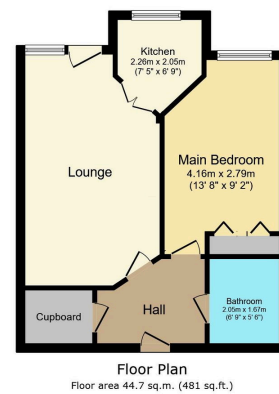

Total floor area: 44.7 sq.m. (481 sq.ft.)

This floor plan is for illustrative purposes only. It is not drawn to scale. Any measurements, floor areas (including any total floor area), openings and orientations are approximate. No details are guaranteed. They cannot be relied upon for any purpose and do not form any part of any agreement. No liability is taken for any error, omission or misstatement. A party must rely upon its own inspection(s). Powered by www.propertybox.ie