



ADAM
HALLIWELL

POWERED BY
exp UK

Cape Ruby Close, Bishops Cleeve, Cheltenham, GL52
£425,000

🛏 4 🚿 2 🚗 2



- Four bedrooms
- Open plan living space
- Cloakroom/utility room
- Garage
- Master with en-suite
- Stunning presentation
- Amazing views from the front
- Private driveway
- Solar panels
- EPC rating B



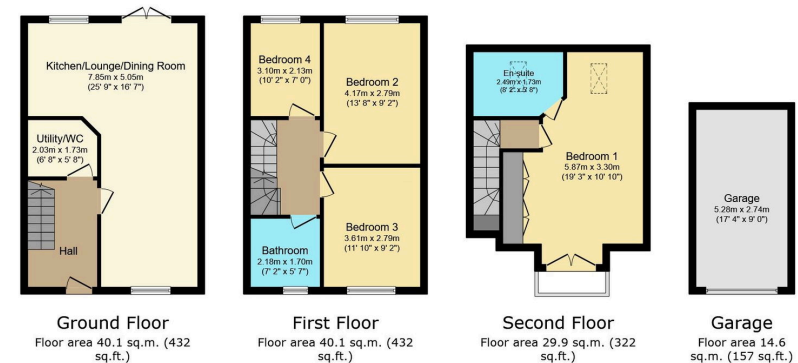

Total floor area: 124.7 sq.m. (1,342 sq.ft.)

This floor plan is for illustrative purposes only. It is not drawn to scale. Any measurements, floor areas (including any total floor area), openings and orientations are approximate. No details are guaranteed, they cannot be relied upon for any purpose and do not form any part of any agreement. No liability is taken for any error, omission or misstatement. A party must rely upon its own inspection(s). Powered by www.propertybox.io

This delightful semi-detached house offers stunning views, an open-plan layout, and four bedrooms, making it an ideal family home in a convenient location. There is a cloakroom/utility, ensuite to the master (along with balcony), garage and southerly facing rear garden. Call now for more information.

Score	Energy rating	Current	Potential
92+	A		
81-91	B	84 B	85 B
69-80	C		
55-68	D		
39-54	E		
21-38	F		
1-20	G		

Call us on

01242 906 586 | 07861 238 913

adamhalliwell@exp.uk.com

Orlando, Old Reddings Road, The Reddings, Cheltenham, GL51 6SA

adam.halliwell.exp.uk.com

Agents Note: Whilst every care has been taken to prepare these particulars, they are for guidance purposes only. All measurements are approximate and are for general guidance purposes only and whilst every care has been taken to ensure their accuracy, they should not be relied upon and potential buyers are advised to recheck the measurements.