



ADAM
HALLIWELL

POWERED BY
exp UK

Barleyfields Avenue, Bishops Cleeve, Cheltenham, GL52

£625,000

5 3 3



- Five bedroom detached
- Double Garage and double driveway
- Study
- Downstairs cloakroom
- Living room
- Two en-suites
- South west facing 33' x 65' rear garden
- Utility room
- Large kitchen/family room
- 2020 Linden homes built





This spacious and well-maintained five-bedroom detached house, constructed by Linden in 2020, sits on an extra-wide plot and features modern amenities, including a large open plan kitchen/family room, two en-suites, a study, and a south-west facing garden, all conveniently located just a 3-minute walk from local shops and ideal for families or downsizers seeking comfort and convenience in a prime area.

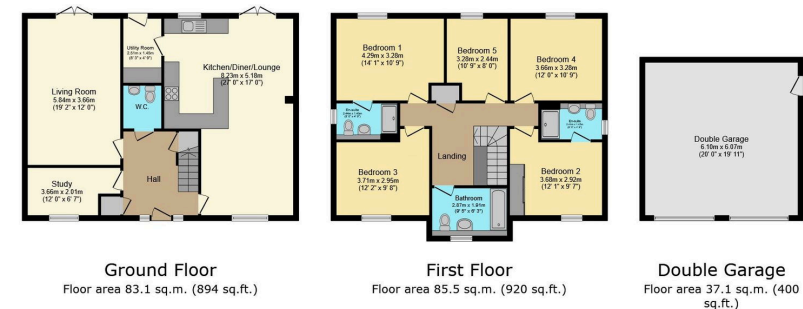

Total floor area: 205.7 sq.m. (2,214 sq.ft.)

This floor plan is for illustrative purposes only. It is not drawn to scale. Any measurements, floor areas (including any total floor area), openings and orientations are approximate. No details are guaranteed, they cannot be relied upon for any purpose and do not form any part of any agreement. No liability is taken for any error, omission or misstatement. A party must rely upon its own inspection(s). Powered by www.Propertybox.io

Score	Energy rating	Current	Potential
92+	A	98 A	99 A
81-91	B		
69-80	C		
55-68	D		
39-54	E		
21-38	F		
1-20	G		

Call us on

01242 906 586 | 07861 238 913

adamhalliwell@exp.uk.com

Orlando, Old Reddings Road, The Reddings, Cheltenham, GL51 6SA

adam.halliwell.exp.uk.com

Agents Note: Whilst every care has been taken to prepare these particulars, they are for guidance purposes only. All measurements are approximate and are for general guidance purposes only and whilst every care has been taken to ensure their accuracy, they should not be relied upon and potential buyers are advised to recheck the measurements.