



ADAM
HALLIWELL

POWERED BY
exp UK

Britannia Way, Woodmancote, Cheltenham, GL52

£525,000

4 1 2



- Detached house
- Four bedrooms
- Large re-fitted bathroom
- 19-foot kitchen
- Two expansive reception rooms
- Single garage
- Downstairs Cloakroom/WC
- Westerey garden with summer house
- Stunning hill views
- Prime location near schools





Ground Floor
Floor area 66.8 m² (719 sq.ft.)

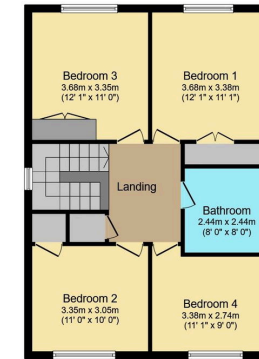

First Floor
Floor area 66.8 m² (719 sq.ft.)

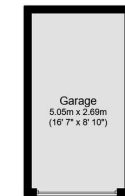

Garage
Floor area 13.6 m² (146 sq.ft.)

TOTAL: 147.1 m² (1,584 sq.ft.)

This floor plan is for illustrative purposes only. It is not drawn to scale. Any measurements, floor areas (including any total floor area), openings and orientations are approximate. No details are guaranteed, they cannot be relied upon for any purpose and do not form any part of any agreement. No liability is taken for any error, omission or misstatement. A party must rely upon its own inspection(s). Powered by www.Propertybox.io

This substantial detached house, situated in a sought-after village location, offers a spacious and well-appointed four-bedroom layout with stunning views of Cleeve Hill, a large garden with a summer house, and potential for further enhancements, making it an ideal family home close to schools and outdoor amenities.



Call us on

01242 906 586 | 07861 238 913

adamhalliwell@exp.uk.com

Orlando, Old Reddings Road, The Reddings, Cheltenham, GL51 6SA

adam.halliwell.exp.uk.com

Agents Note: Whilst every care has been taken to prepare these particulars, they are for guidance purposes only. All measurements are approximate and are for general guidance purposes only and whilst every care has been taken to ensure their accuracy, they should not be relied upon and potential buyers are advised to recheck the measurements.