



ADAM HALLIWELL POWERED BY **exp** TM UK

@ adam.halliwell@exp.uk.com

adamhalliwell.exp.uk.com

01242 906 586

Arable Place, Bishops Cleeve, Cheltenham, GL52

£385,000

🛏️ 3 🚿 2 🚗 1



- Please quote ref AH0137
- Open plan living
- Detached oversized garage
- Garden room/office
- Cloakroom
- Three double bedrooms
- Kitchen/diner with fitted appliances
- Driveway
- En-suite to master
- 2019 built



Detached property on the edge of the village with open-plan living space, three double bedrooms, energy-efficient features, garden room/office, and spacious garage, perfect for families or couples seeking modern living in a tranquil setting. Call now for more details

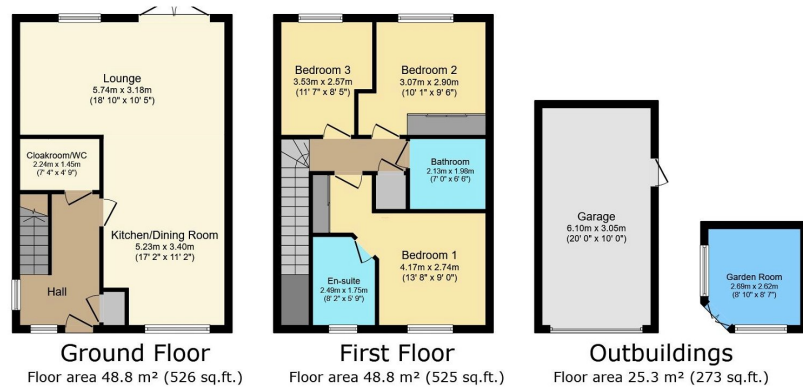

TOTAL: 123.0 m² (1,324 sq.ft.)
This floor plan is for illustrative purposes only. It is not drawn to scale. Any measurements, floor areas (including any total floor area), openings and orientations are approximate. No details are guaranteed, they cannot be relied upon for any purpose and do not form any part of any agreement. No liability is taken for any error, omission or misstatement. A party must rely upon its own inspection(s). Powered by www.propertybox.ie

Score	Energy rating	Current	Potential
92+	A	97 A	98 A
81-91	B		
69-80	C		
55-68	D		
39-54	E		
21-38	F		
1-20	G		