



ADAM HALLIWELL POWERED BY exp TM UK

@ adam.halliwell@exp.uk.com

adamhalliwell.exp.uk.com

01242 906 586

# Teddington, Tewkesbury, GL20

£525,000

3 2 1



- Please quote Ref AH0137
- Downstairs Cloakroom
- Office (via outside)
- Garage/store
- Popular village location
- Three double bedrooms
- En-suite to master
- Large open plan living space
- 50' x 50' garden backing onto fields
- Large driveway



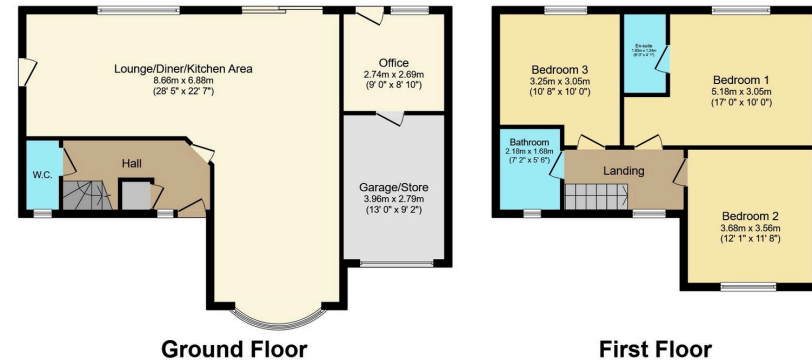

Total floor area 130.5 sq.m. (1,405 sq.ft.) approx  
 This plan is for illustration purposes only and may not be representative of the property. Plan not to scale. Powered by PropertyBox

An amazing three double bedroom home, set in a stunning position backing onto fields. Accommodation includes a cloakroom, outside accessed office, master bedroom with en-suite and breath taking open plan living space, with three flexible and natural areas: kitchen, dining and living. Doors open from the rear onto a south facing 50' x 50' rear garden with fields behind. Call now to arrange a viewing.

Score	Energy rating	Current	Potential
92+	A		
81-91	B		
69-80	C		71   C
55-68	D		
39-54	E	44   E	
21-38	F		
1-20	G		