



ADAM HALLIWELL POWERED BY **exp** TM UK

@ adam.halliwell@exp.uk.com

adamhalliwell.exp.uk.com

01242 906 586

Moonstone Grove, Bishops Cleeve, Cheltenham, GL52

£385,000

🛏️ 3 🍽️ 2 🚗 1



- Please quote ref AH0137
- Three bedrooms
- Open-plan family kitchen/ diner
- Solar panels with superb EPC rating B
- South-facing rear garden with artificial grass
- Refitted en suite in master bedroom
- Utility Room and downstairs cloakroom
- En-suite to master bedroom
- Access to charming walking routes
- Parking



A delightful detached property with three bedrooms, two bathrooms, and unique features such as solar panels and a south-facing garden, located in a vibrant community with a variety of amenities, offering a fantastic opportunity for families and couples alike.

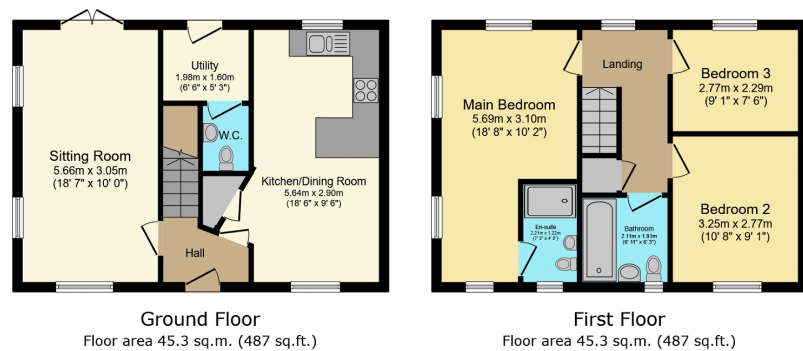

TOTAL: 90.6 sq.m. (975 sq.ft.)
This floor plan is for illustrative purposes only. It is not drawn to scale. Any measurements, floor areas (including any total floor area), openings and orientations are approximate. No details are guaranteed, they cannot be relied upon for any purpose and do not form any part of any agreement. No liability is taken for any error, omission or misstatement. A party must rely upon its own inspection(s). Powered by www.propertybox.co

Score	Energy rating	Current	Potential
92+	A		
81-91	B	86 B	87 B
69-80	C		
55-68	D		
39-54	E		
21-38	F		
1-20	G		