



ADAM HALLIWELL POWERED BY exp TM UK

@ adam.halliwell@exp.uk.com

adamhalliwell.exp.uk.com

01242 906 586

Upper Park Street, Cheltenham, GL52

£230,000

🛏️ 2 🚿 1 🚗 1



- No onward chain
- Short walk to High Street amenities
- New ground floor Bathroom
- Two double bedrooms
- Recently renovated
- Generous 45' x 12' rear garden
- New Kitchen
- Cul de sac location
- Council tax band B
- Please quote ref AH0137



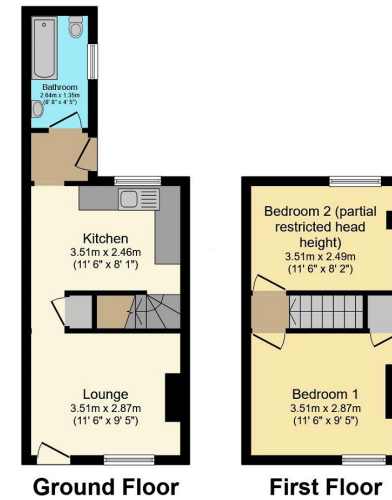

Total floor area 49.7 m² (535 sq.ft.) approx
 This plan is for illustration purposes only and may not be representative of the property. Plan not to scale. Powered by PropertyBox

Please quote ref AH0137. This immaculate terraced property in a quiet cul-de-sac, just half a mile from the town centre, offers stylish living with a smart exterior, newly refurbished kitchen and bathroom, and a generous rear garden. Two double bedrooms and sold with no onward chain. Call now for more details.

Score	Energy rating	Current	Potential
92+	A		
81-91	B		88 B
69-80	C		
55-68	D	67 D	
39-54	E		
21-38	F		
1-20	G		