

Tredyson Place, Falmouth

Guide Price £625,000

3 2 3



This bungalow sits at the head of the Tredyson Place which is an extremely popular residential cul-de-sac, ideally situated within walking distance of the vibrant Falmouth town centre and stunning coastline with selection of beaches and coastal walks. The property is also within easy reach of two well regarded primary schools, Falmouth Marine School, Woodlane university campus and Penmere train station with branch line running between Falmouth Docks and the cathedral city of Truro. NO ONWARD CHAIN.

Key Features

- Superb detached bungalow
- Three double bedroom accommodation, master ensuite
- Generously proportioned lounge, dining room & kitchen
- Spacious four piece family bathroom
- Pitched roof conservatory, GCH, UPVC double glazing
- Utility room & home office/study
- TWO garages, multiple parking facilities
- Sunny, south facing garden
- Extremely popular & convenient cul-de-sac location
- Available immediately with no onward chain

GROUND FLOOR
2155 sq.ft. (200.2 sq.m.) approx.

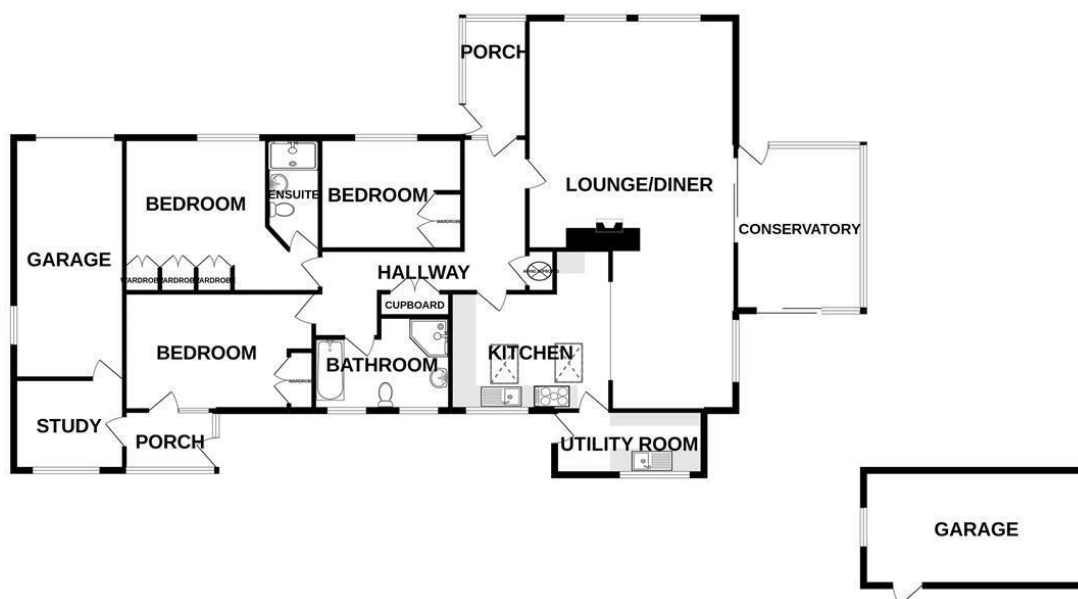

TOTAL FLOOR AREA : 2155 sq.ft. (200.2 sq.m.) approx.

Whilst every attempt has been made to ensure the accuracy of the floorplan contained here, measurements of doors, windows, rooms and any other items are approximate and no responsibility is taken for any error, omission or mis-statement. This plan is for illustrative purposes only and should be used as such by any prospective purchaser. The services, systems and appliances shown have not been tested and no guarantee as to their operability or efficiency can be given.
Made with Metropix ©2022