

Drake Street, Atherton, M46 0BP
£1,050 PCM

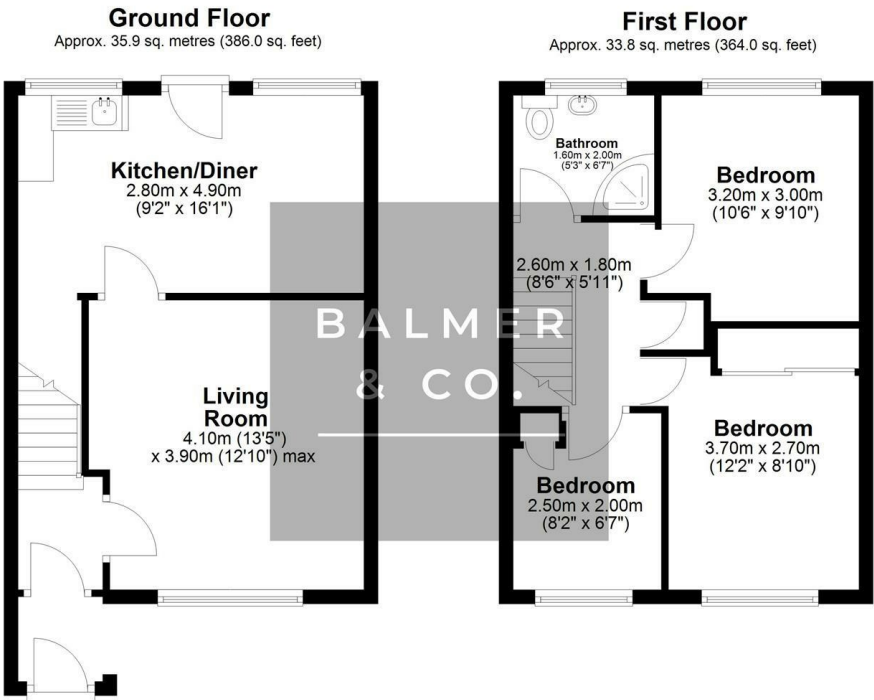

BALMER & CO are delighted to offer TO RENT his three bedroom mid terraced property, available for immediate occupancy. Ground floor accommodation comprises in brief, storm porch, living room, and kitchen dining room. To the first floor are three well proportioned bedrooms and shower room. Outside are enclosed low maintenance front and rear gardens.

Floor Plan



Area Map

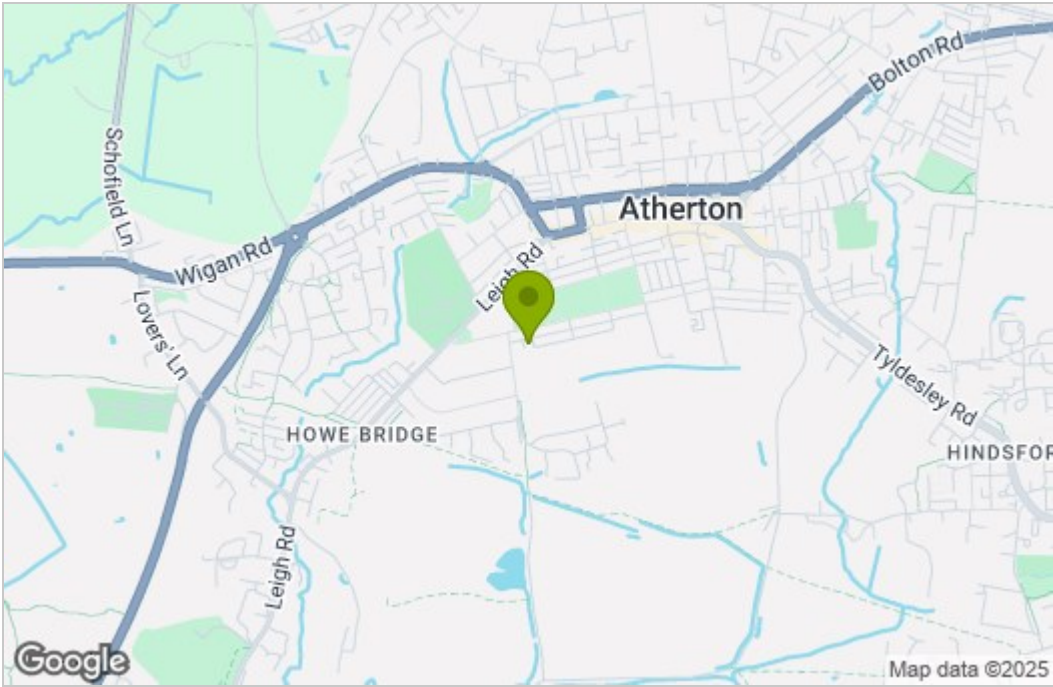

Energy Efficiency Graph

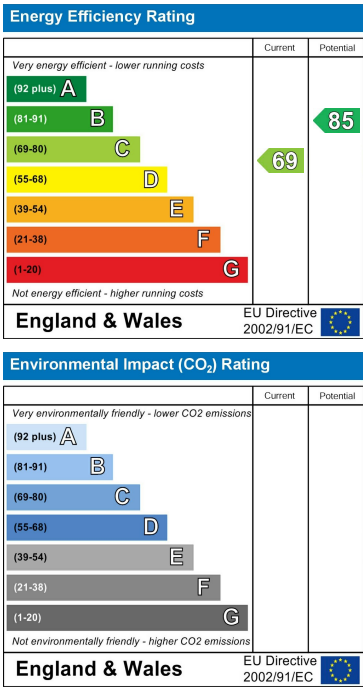

These particulars, whilst believed to be accurate are set out as a general outline only for guidance and do not constitute any part of an offer or contract. Intending purchasers should not rely on them as statements of representation of fact, but must satisfy themselves by inspection or otherwise as to their accuracy. No person in this firms employment has the authority to make or give any representation or warranty in respect of the property.