

Birley Street, Leigh, WN7 1JU
£1,150 PCM

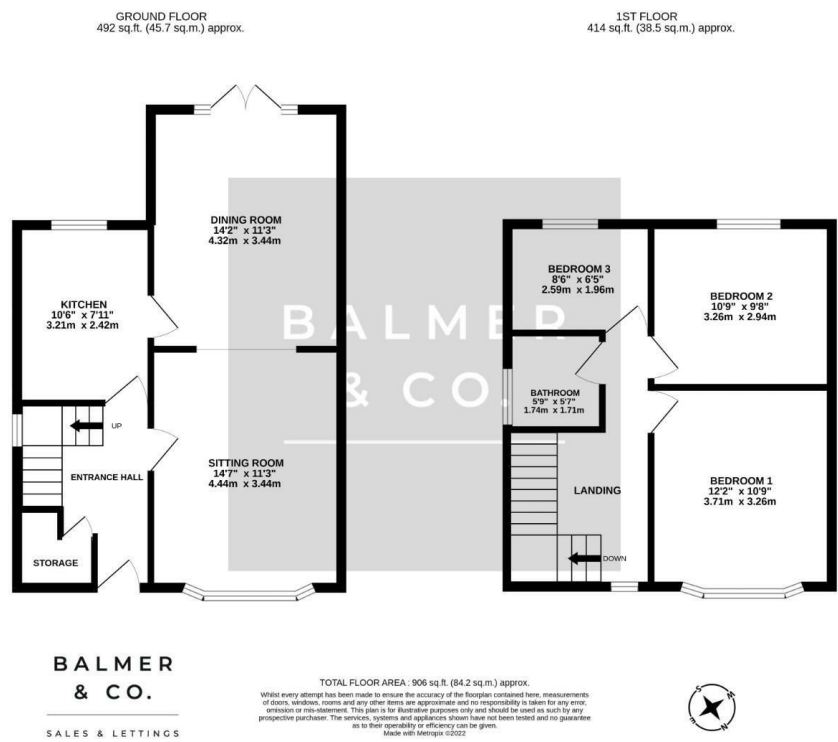

BALMER & CO are delighted to offer TO RENT this three bedroom semi detached property. Ground floor accommodation comprises in brief, entrance hallway, sitting room, dining room, fitted kitchen. To the first floor are three bedrooms and bathroom. Outside there is paved parking to the front and an enclosed garden to the rear.

Floor Plan



Area Map

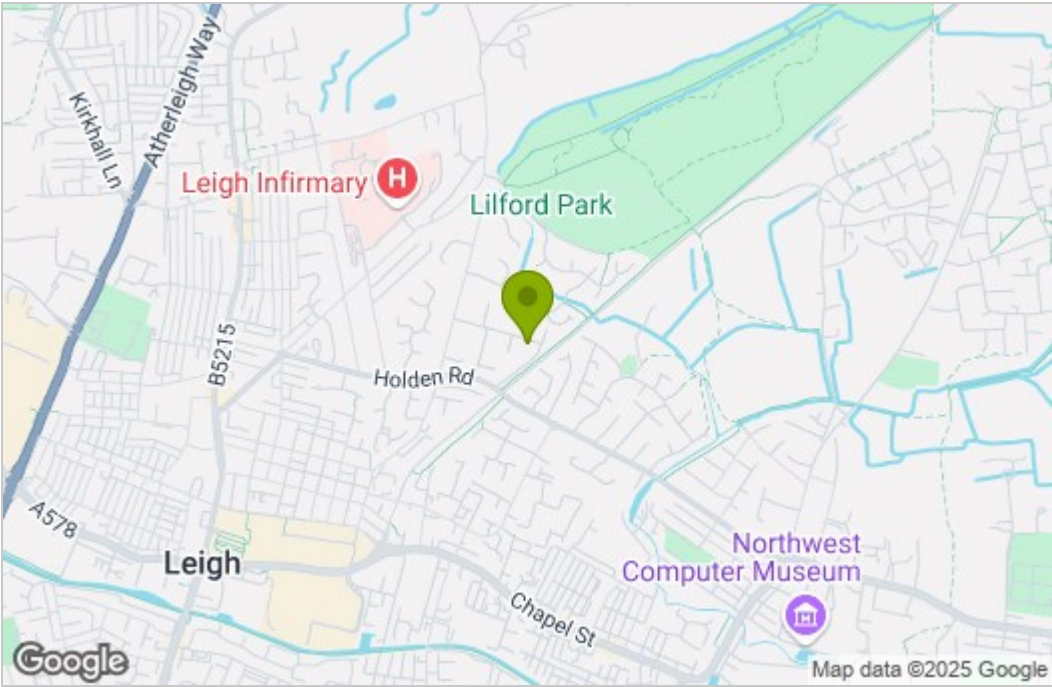

Energy Efficiency Graph

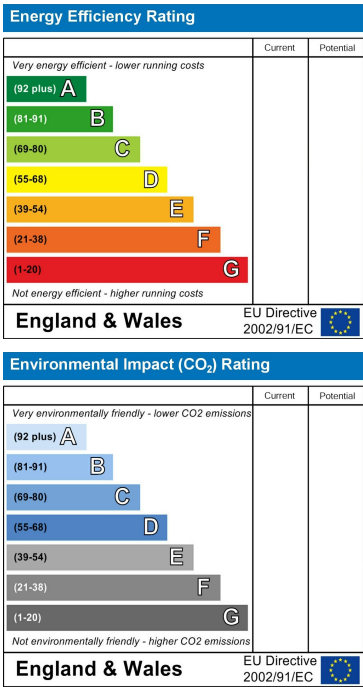

These particulars, whilst believed to be accurate are set out as a general outline only for guidance and do not constitute any part of an offer or contract. Intending purchasers should not rely on them as statements of representation of fact, but must satisfy themselves by inspection or otherwise as to their accuracy. No person in this firms employment has the authority to make or give any representation or warranty in respect of the property.