

Alexander Street, Tyldesley, M29 8DX
£795 PCM

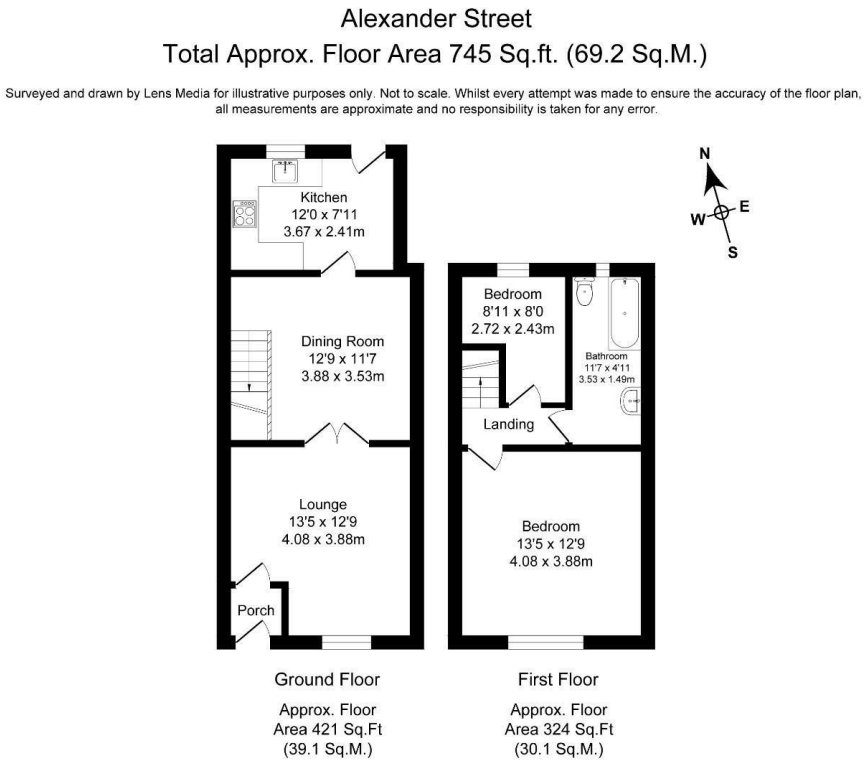

BALMER & CO are delighted to offer TO RENT this two bedroom mid terraced property, available for immediate occupancy. Ground floor accommodation comprises in brief, entrance vestibule, sitting room, dining room, and kitchen extension to rear. To the first floor are two bedrooms and bathroom. Outside is an enclosed low maintenance rear garden with gated access, and to the front the property has an elevated position via shared steps.

Floor Plan



Area Map



Energy Efficiency Graph

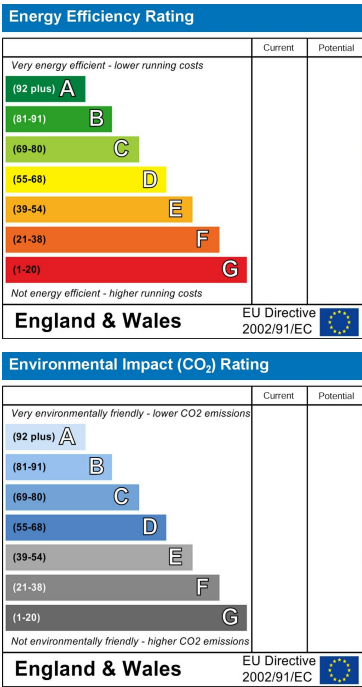

These particulars, whilst believed to be accurate are set out as a general outline only for guidance and do not constitute any part of an offer or contract. Intending purchasers should not rely on them as statements of representation of fact, but must satisfy themselves by inspection or otherwise as to their accuracy. No person in this firms employment has the authority to make or give any representation or warranty in respect of the property.