



1/2

Kirkland Street | | Glasgow | G20 6SY

Offers Over £195,000

moving

ESTATE AGENTS



## Key features

- Upgraded modern two-bedroom flat located in Kelvinside
- Newly fitted quality kitchen, upgraded bathroom and en-suite
- Engineered wood flooring throughout
- Double Glazing
- Gas Central Heating
- Excellent location ideally placed for Great Western Road, Byres Road and West End
- Well-maintained rear court/ gardens
- Council Tax Band D

## Description

This is a beautifully upgraded two-bedroomed apartment that is located on the preferred first floor of a well-maintained modern development in North Kelvinside. Originally built by Tulloch Homes, the flat is conveniently located close to the West End and University of Glasgow, as well as being close to the City Centre which can be reached by bus and subway nearby.

## Directions



This is a beautifully upgraded two-bedroomed apartment that is located on the preferred first floor of a well-maintained modern development in North Kelvinside. Originally built by Tulloch Homes, the flat is conveniently located close to the West End and University of Glasgow, as well as being close to the City Centre which can be reached by bus and subway nearby.



# Floor plans

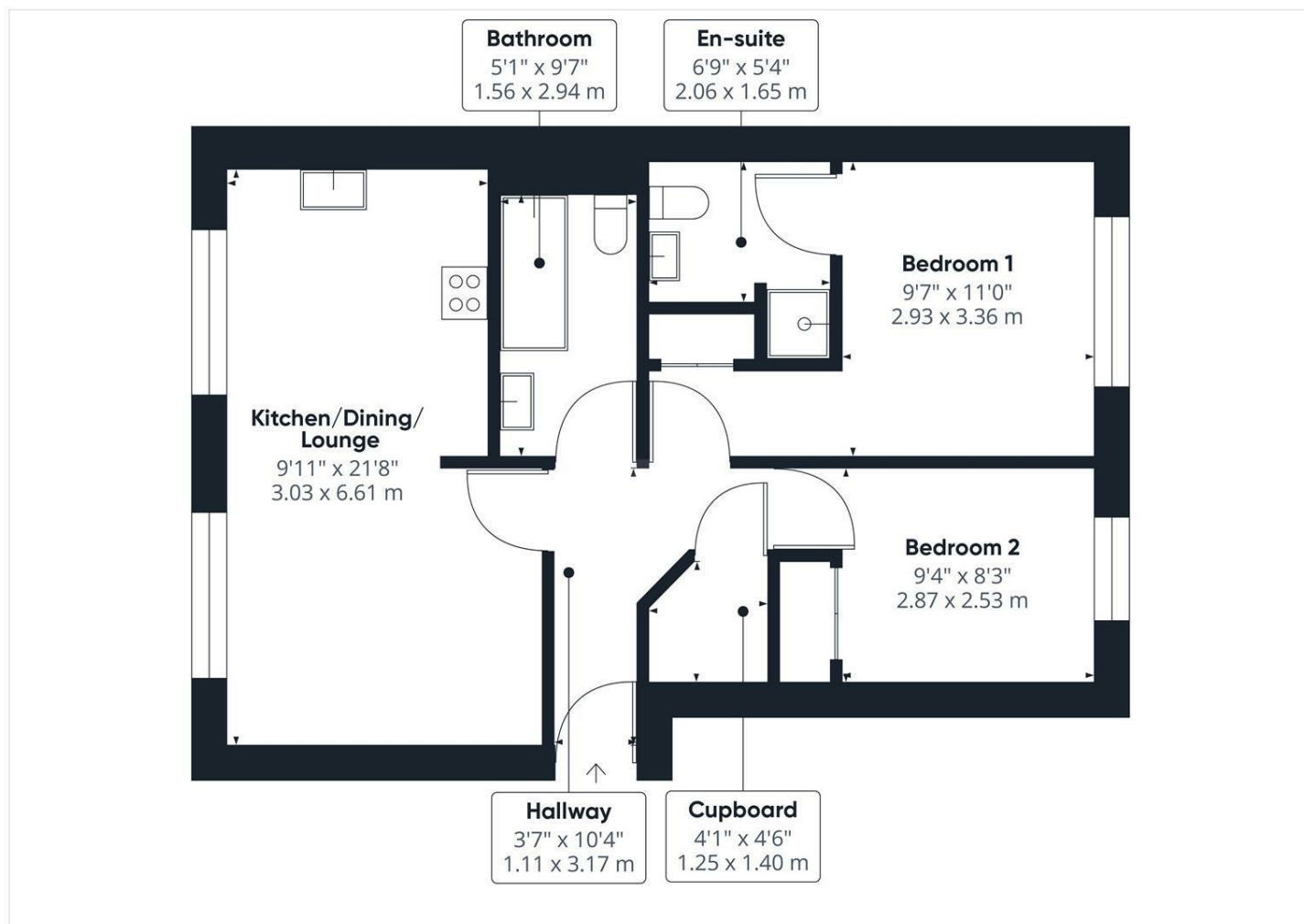

Energy Efficiency Rating		
	Current	Potential
Very energy efficient - lower running costs		
(92 plus) <b>A</b>		
(81-91) <b>B</b>	<b>83</b>	<b>83</b>
(69-80) <b>C</b>		
(55-68) <b>D</b>		
(39-54) <b>E</b>		
(21-38) <b>F</b>		
(1-20) <b>G</b>		
Not energy efficient - higher running costs		
<b>Scotland</b>	EU Directive 2002/91/EC 	

**moving**

ESTATE AGENTS

127 Byres Road

Glasgow

G12 8TT

0141 334 7000

reception@movingwestend.co.uk

movingwestend.co.uk