



JANE LEES 
Your Property Partnership

49 Croft Holm,
Guide Price £440,000

3 2 2



This extended three-bedroom detached home is tucked away at the end of a quiet cul-de-sac and offers the perfect blend of space, flexibility and location. With two generous living areas, a bright kitchen, three double bedrooms, and a sunny west-facing garden, this is a fabulous home!

Extended to both the front and rear, the layout flows beautifully, with two generous reception areas, a bright kitchen, a practical utility/boot room, and three comfortable double bedrooms upstairs — including a spacious main suite with its own dressing area and en suite shower room. There's also off-street parking, a useful garage store, and a pretty, west-facing garden that catches the afternoon and evening sun.

Whether you're upsizing, downsizing, or simply looking to live the dream in the Cotswolds, this is a well-positioned home in one of the most sought-after spots in the North Cotswolds.



49 Croft Holm, Moreton-In-Marsh

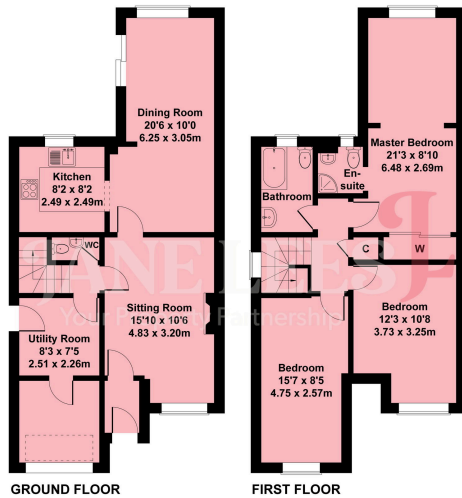

Approximate Gross Internal Area = 112 sq m / 1206 sq ft
Illustration for identification purposes only.
measurements are approximate, not to scale.

- Cotswold Lifestyle on Your Doorstep
- Extended Detached Home
- Everyday Essentials within reach
- Countryside walks
- Peaceful Cul-de-Sac Location
- Great Local Schools
- Excellent Transport Links – Direct trains to Oxford and London
- Sociable Flow
- Three Double Bedrooms



Score	Energy rating	Current	Potential
92+	A		
81-91	B		83 B
69-80	C	73 C	
55-68	D		
39-54	E		
21-38	F		
1-20	G		



W janelees.co.uk **T** 01789 576 065 **E** jane@janelees.co.uk

Buy Me, Sell Me Happy Houses Ltd Registered Office: Building 18, Gateway 1000, Whittle Way, Arlington Business Park, Stevenage, England, SG1 2FP
Trading address: 20a Chapel Street, Stratford-upon-Avon, England, CV37 6EP | Company Registration Number: 13086728 | Vat Number: 433396194

ico.
Information Commissioner's Office

The Property Ombudsman