

Upsdell Avenue
| Palmers Green | N13

PropertyTime

EST 2008



£665,000

A three bedroomed terrace house offering ample living space throughout and boasting a bright & airy reception and dining room with open plan kitchen.

With a superb location and situated on desirable turning this attractive home comprises a light and airy living room with lovely bay window and feature fireplace, real wood floors and a fitted kitchen, on the first floor there are two large double bedrooms and a small double, plus family bathroom.

The property benefits a 70ft rear garden and is ideal for the busy commuter with easy access to Wood Green Underground Station (Piccadilly Line) and the Palmers Green National Rail Station with direct access to the City.



2 3 1

020 7794 2008 www.property-time.co.uk info@property-time.co.uk

None of the information within these details can be relied upon as being an actual representation of the property

Reception Room

12'11" x 11'9" (3.94 x 3.58)

Kitchen/Dining Room

19'0" x 12'6" (5.79 x 3.81)

Master Bedroom

16'2" x 11'9" (4.93 x 3.58)

Bedroom 2

15'9" x 11'1" (4.80 x 3.38)

Bedroom 3

10'10" x 7'2" (3.30 x 2.18)

Bathroom

9'5" x 7'11" (2.87 x 2.41)

Garden

69'8" x 20'0" (21.23 x 6.10)

Area Map



Floor Plans

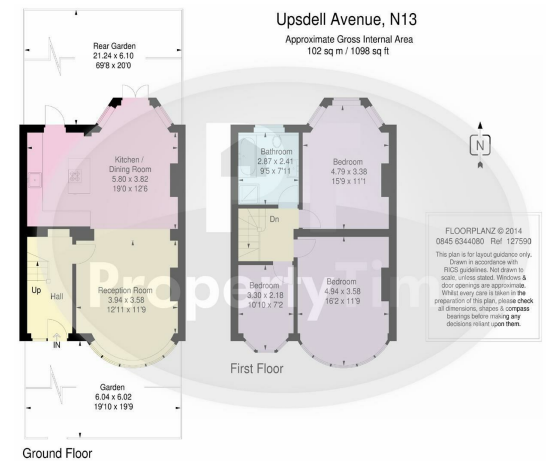

Energy Efficiency Graph

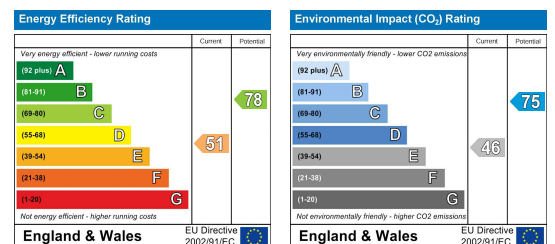

88 Belsize Lane, Hampstead, London, NW3 5BE

020 7794 2008 www.property-time.co.uk info@property-time.co.uk

None of the information within these details can be relied upon as being an actual representation of the property