



# Dulverton Road

Abington Vale, Northampton

oriordanbond  
SALES & LETTINGS





GROUND FLOOR  
612 sq.ft. (56.9 sq.m.) approx.

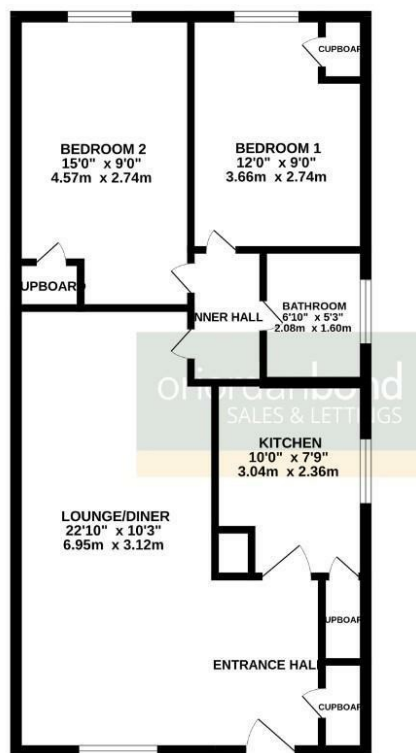

TOTAL FLOOR AREA: 612 sq.ft. (56.9 sq.m.) approx.  
Whilst every attempt has been made to ensure the accuracy of the floorplan contained herein, measurements of doors, windows, rooms and any other items are approximate and no responsibility is taken for any error, omission or misstatement. This plan is for illustrative purposes only and should be used as such by any prospective purchaser. The services, systems and appliances shown have not been tested and no guarantee as to their operability or efficiency can be given.  
Made with NetScout C5025

## Dulverton Road

Abington Vale

NN3 3AZ

PRICE £239,995

A competitively priced two double bedroom semi-detached bungalow in the highly popular area of Abington Vale. The property would benefit from some cosmetic updating but is modernised including uPVC double glazing throughout (including external soffits and fascias) and a gas radiator heating system with a three year old boiler.

The accommodation comprises entrance hall, sitting/dining room, kitchen, inner hall, two double bedrooms and a fully tiled bathroom. The property enjoys a deep open plan frontage with a driveway down one side providing off road parking for two to three cars giving access to a single garage. The rear garden is a good size and laid mainly to lawn with an extended patio area to house. This bungalow is offered for sale with no onward chain. (C/612/M)

### Additional information

- Council Tax Band: C
- Energy Efficiency Rating: D

### Viewing

Viewing strictly by appointment – details below

### Disclaimer

O'Riordan Bond Estate Agents Limited has not tested apparatus, equipment, fittings or services and so cannot verify they are in working order. The buyer is advised to obtain verification from their solicitor or surveyor.

O'Riordan Bond Abington Vale Sales

01604 639007

abingtonvale@oriordanbond.co.uk

