



Rushmere Crescent

Rushmere, Northampton

oriordanbond
SALES & LETTINGS



GROUND FLOOR
932 sq.ft. (86.6 sq.m.) approx.

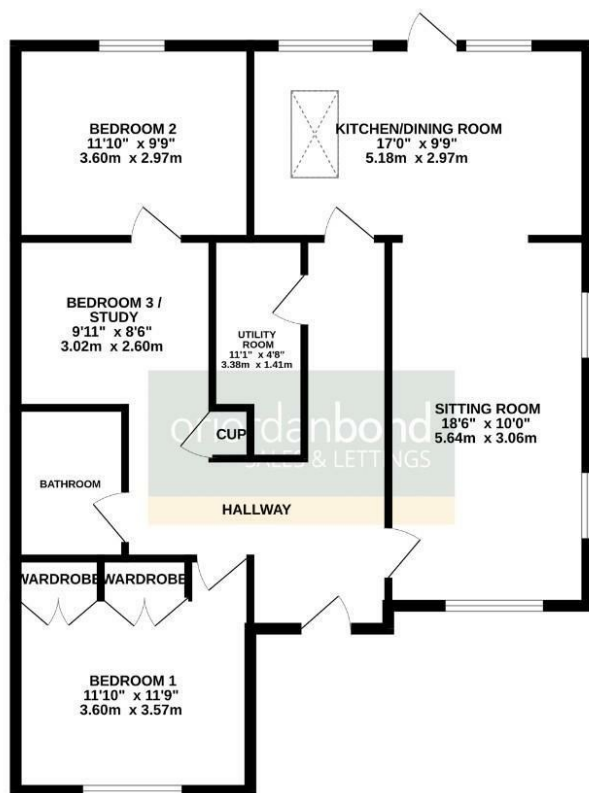

TOTAL FLOOR AREA : 932 sq.ft. (86.6 sq.m.) approx.
Whilst every attempt has been made to ensure the accuracy of the floorplan contained here, measurements of doors, windows, rooms and any other items are approximate and no responsibility is taken for any error, omission or mis-statement. This plan is for illustrative purposes only and should be used as such by any prospective purchaser. The services, systems and appliances shown have not been tested and no guarantee as to their operability or efficiency can be given.
Made with Metreplan C2025

Rushmere Crescent

Rushmere

NN1 5SA

GUIDE PRICE £430,000

An extended and fully refurbished detached bungalow situated in this highly regarded location within Rushmere. The property is offered for sale in excellent condition throughout.

Accommodation comprises entrance hall, sitting room with feature fireplace, extended and re-fitted kitchen/dining room with roof lantern and integrated appliances, utility room, three double bedrooms and a high quality re-fitted bathroom. Externally there are well maintained gardens to the front, side and rear and a driveway providing off road parking leading to a garage. Further benefits include gas radiator heating and uPVC double glazing. (A/932/M)

Additional information

- Council Tax Band: D
- Energy Efficiency Rating: C

Viewing

Viewing strictly by appointment – details below

Disclaimer

O'Riordan Bond Estate Agents Limited has not tested apparatus, equipment, fittings or services and so cannot verify they are in working order. The buyer is advised to obtain verification from their solicitor or surveyor.

O'Riordan Bond Abington Vale Sales

01604 639007

abingtonvale@oriordanbond.co.uk

