



Ridgeway

Weston Favell Village, Northampton

oriordanbond
SALES & LETTINGS



Ridgeway

Weston Favell Village
NN3 3AP

GUIDE PRICE £440,000

A rarely available two bedroom semi-detached dormer bungalow situated in one of Northampton's prime locations within sought after Weston Favell Village. The property has been much improved by the current owner and is positioned just yards away from Abington Park.

The accommodation comprises entrance hall, sitting room, dining room, re-fitted kitchen/breakfast room, utility room, a spacious double bedroom and ground floor re-fitted bathroom. To the first floor is a further double bedroom, a re-fitted shower room and study/walk-in dressing room. Externally there are well maintained front and rear gardens and a driveway providing ample off road parking. Further benefits include gas radiator heating and uPVC double glazing. (A/1209/S)

Additional information

- Council Tax Band: D
- Energy Efficiency Rating: D

Viewing

Viewing strictly by appointment – details below

Disclaimer

O'Riordan Bond Estate Agents Limited has not tested apparatus, equipment, fittings or services and so cannot verify they are in working order. The buyer is advised to obtain verification from their solicitor or surveyor.

O'Riordan Bond Abington Vale Sales
01604 639007

abingtonvale@oriordanbond.co.uk

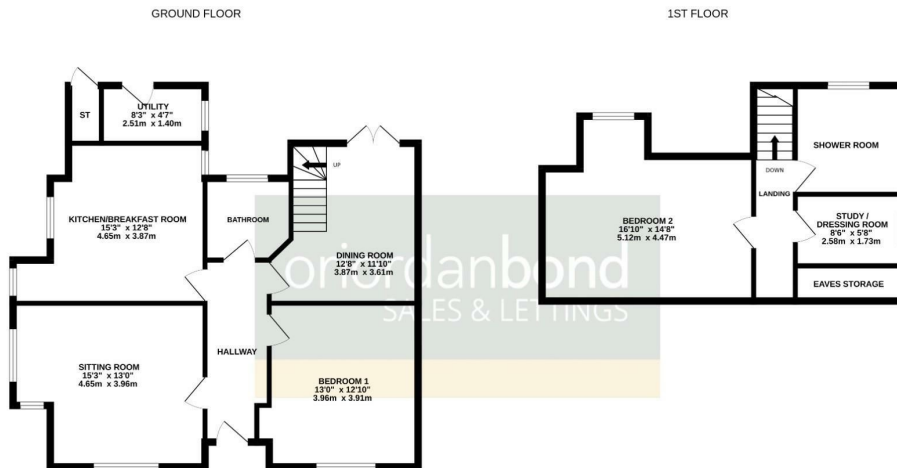

TOTAL FLOOR AREA: 1209 sq. ft. (112.3 sq.m.) approx.

Whilst every attempt has been made to ensure the accuracy of the floorplan contained here, measurements of doors, windows, rooms and any other items are approximate and no responsibility is taken for any error, omission or mis-statement. This plan is for illustrative purposes only and should be used as such by any prospective purchaser. The services, systems and appliances shown have not been tested and no guarantee as to their operability or efficiency can be given.

Made with Metropix C3524

