



CHARLES KNIGHT
ESTATE AGENTS



5a Mount Pleasant Road

, London, SE13 6RD

£1,350 Per month

Charles Knight are delighted to offer to let this one-bedroom basement flat located in Lewisham. A Victorian conversion and its own access to a shared garden. This property also comprises of a spacious lounge, great size double bedroom, fully fitted kitchen and a family bathroom.

London Borough of Lewisham

Council Tax: Band B

EPC: C

Viewing

Please contact our Lewisham Office on 02088 524441 if you wish to arrange a viewing appointment for this property or require further information.



1



1



1



C

Floor Plan

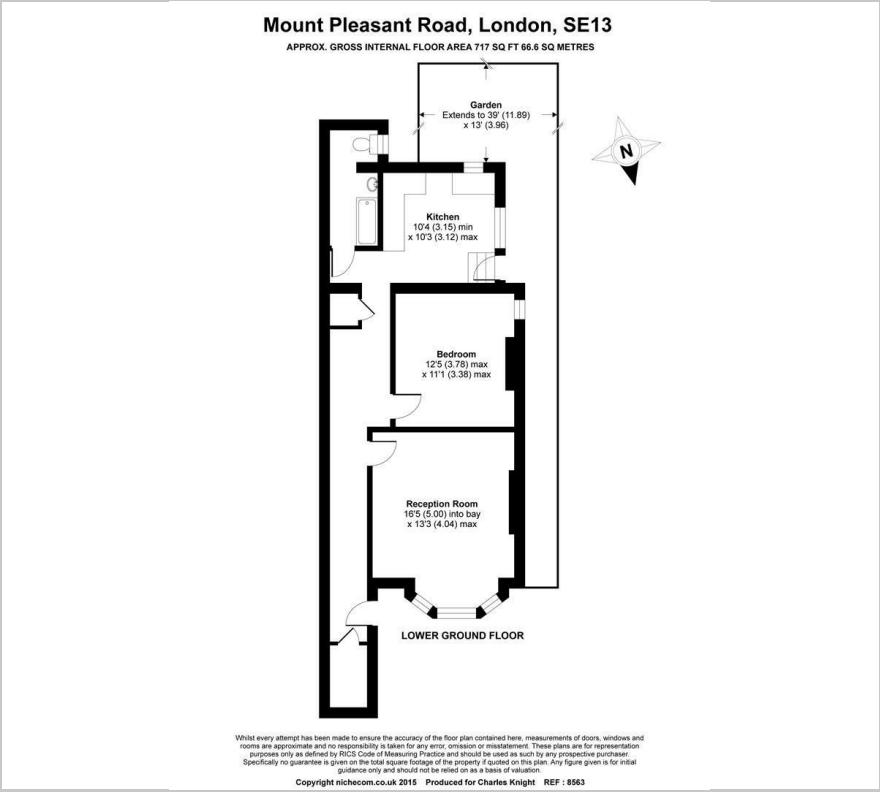

Area Map



Energy Efficiency Graph

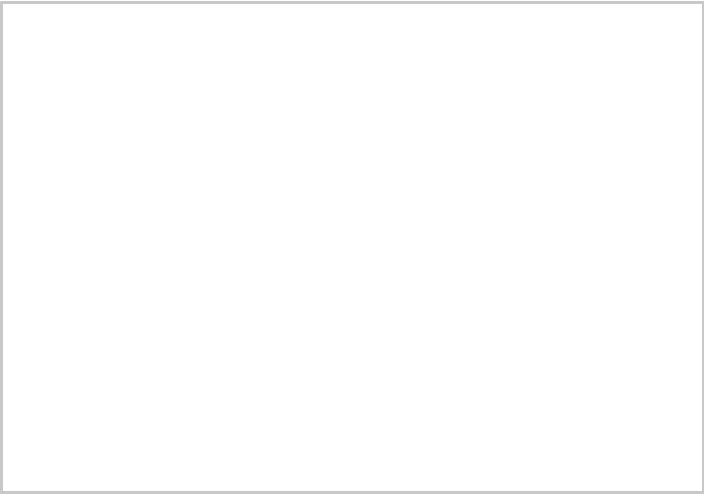
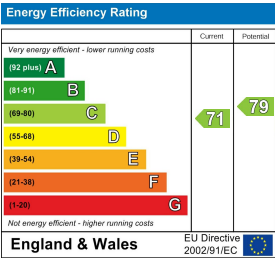

These particulars, whilst believed to be accurate are set out as a general outline only for guidance and do not constitute any part of an offer or contract. Intending purchasers should not rely on them as statements of representation of fact, but must satisfy themselves by inspection or otherwise as to their accuracy. No person in this firms employment has the authority to make or give any representation or warranty in respect of the property.