

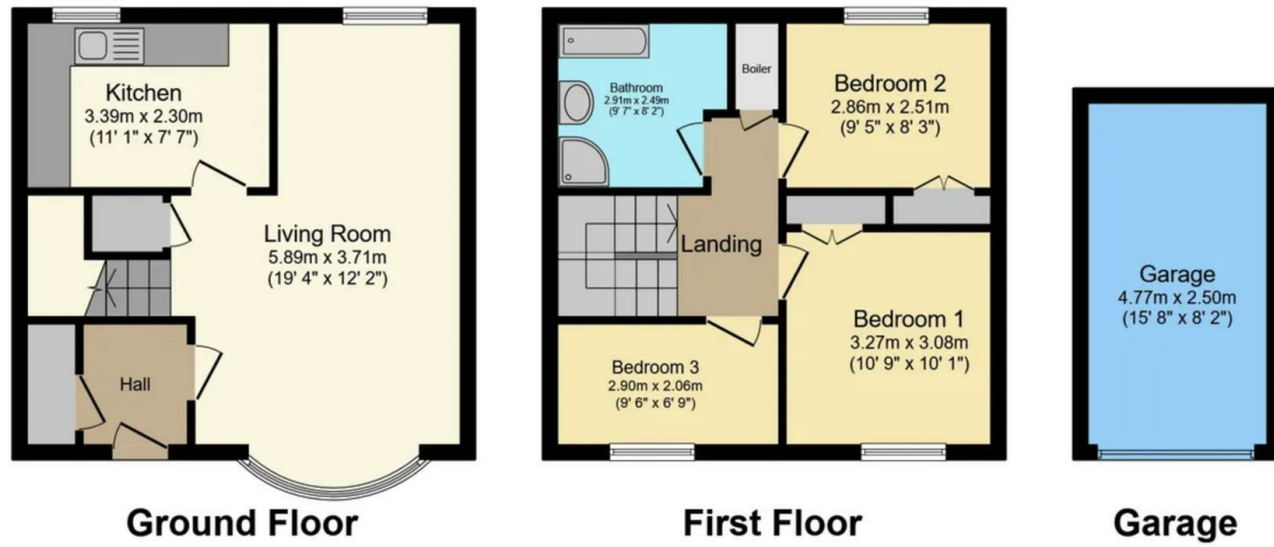

**3 Bed
House - Mid Terrace
located in**



Total floor area 84.3 sq.m. (907 sq.ft.) approx

Directions

Contact

Lodge Barn Manor Road Lambourne End
Essex
RM4 1NA

E: info@stirlingestate.com

T: 07718 232857

stirlingestate.com



12 Shillibeer Walk

Chigwell
IG7 6JA

Offers in excess of £500,000
Freehold



This charming three bedroom terraced home offers generous living space and a warm, welcoming feel throughout. The large through lounge and dining area provide an ideal setting for family gatherings and entertaining. The stylish, fully fitted kitchen comes complete with all appliances.

There’s also space in the hallway with built-in storage that can easily be converted into a downstairs W/C a popular improvement many neighbours on the road have already made.

Upstairs, the home features a contemporary bathroom with a jacuzzi bath, a separate shower. All three bedrooms are well proportioned, offering plenty of natural light and comfortable living space.

The property benefits from full central heating, a brand new boiler, and new electrics, ensuring efficiency and peace of mind. Situated on a peaceful private road, it’s just a 10 minute walk to Grange Hill Station, with bus routes to Ilford only 5 minutes away, and convenient connections to Central London in around 45–60 minutes.

Owner’s Summary:
The current owner has thoroughly enjoyed living here, describing it as “A peaceful and friendly road with great neighbours and everything close by .Transport, shops, and green spaces. It’s been a lovely, comfortable home to relax in and easy to maintain.”

