



OFFERS OVER

**£260,000**

**Bury Old Road**

Manchester, M25 3DE





**Ground Floor**  
Floor area 40.4 sq.m. (435 sq.ft.)

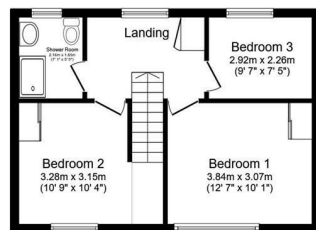

**First Floor**  
Floor area 38.8 sq.m. (418 sq.ft.)

Total floor area: 79.3 sq.m. (853 sq.ft.)

This floor plan is for illustrative purposes only. It is not drawn to scale. Any measurements, floor areas (including any total floor area), openings and orientations are approximate. No details are guaranteed, they cannot be relied upon for any purpose and do not form any part of any agreement. No liability is taken for any error, omission or misstatement. A party must rely upon its own inspection(s). Powered by www.Propertybox.io

3



1



1

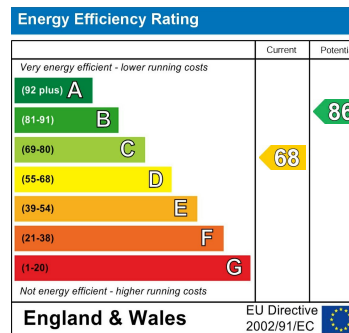

Agents Note: Whilst every care has been taken to prepare these particulars, they are for guidance purposes only. All measurements are approximate and are for general guidance purposes only and whilst every care has been taken to ensure their accuracy, they should not be relied upon and potential buyers/tenants are advised to recheck the measurements



**OFFICE ADDRESS**  
24 Mountbatten Close  
Unsworth  
Bury  
BL9 8PU

**OFFICE DETAILS**  
01617061915  
info@atobeeproperty.com