

Melrose Avenue, Leigh, WN7 5PQ
£160,000

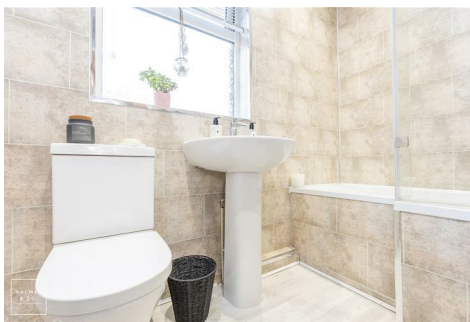

BALMER & CO in LEIGH are delighted to offer FOR SALE this fantastic three bedroom mid-terrace house in Leigh. Very nicely presented throughout this property comprises in brief of entrance hallway, large living room with feature log burner stove, modern fitted kitchen/dining room with French doors leading to the rear garden, with a W.C, completing the ground floor. To the first floor is a large master bedroom, second large double bedroom, storage area, with a modern fitted, three piece bathroom completing the accommodation on offer. Externally there is a driveway to the front providing off-road parking, whilst to the rear there is a private, fully enclosed, West facing garden with an open aspect beyond. Early viewings highly recommended, all enquiries welcome.

Floor Plan

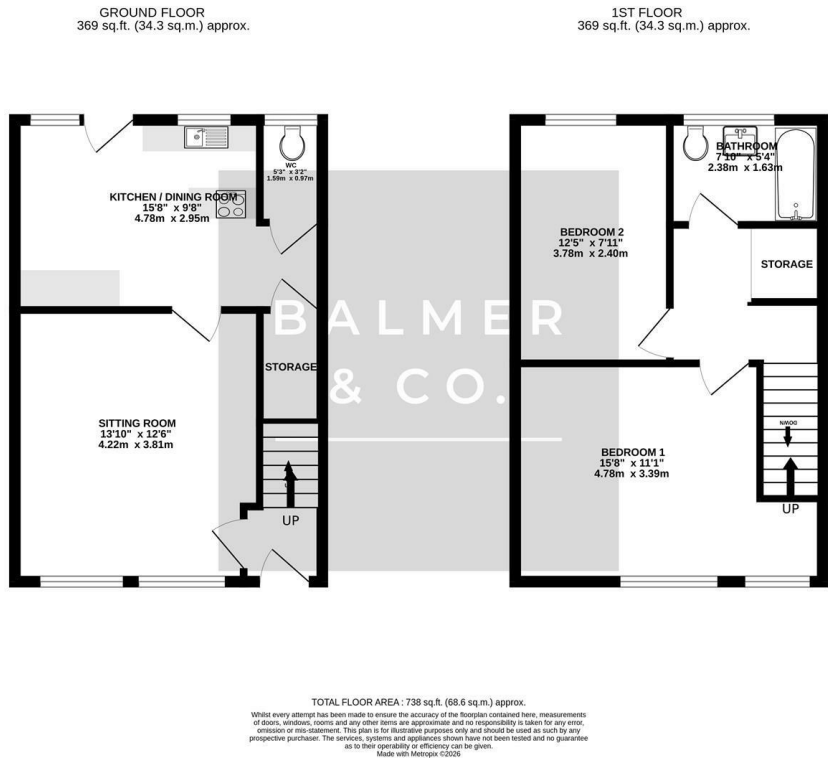

Area Map

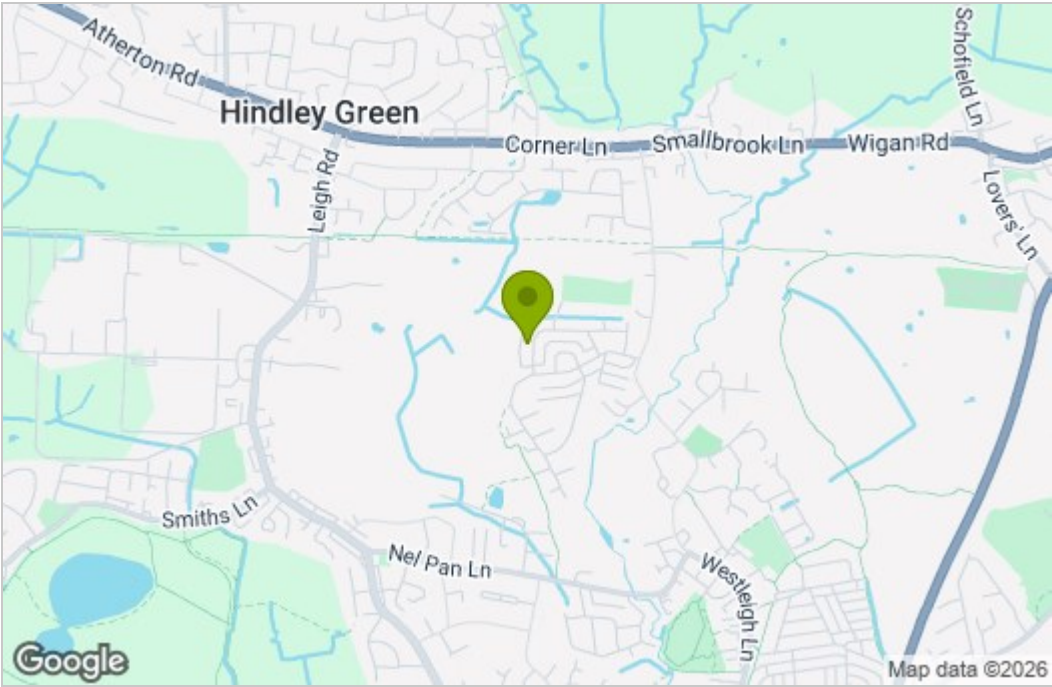

Energy Efficiency Graph

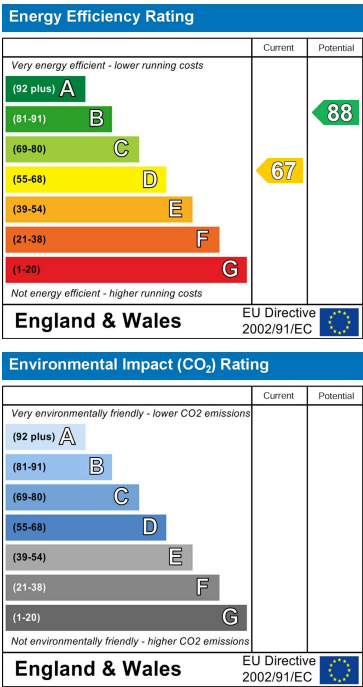

These particulars, whilst believed to be accurate are set out as a general outline only for guidance and do not constitute any part of an offer or contract. Intending purchasers should not rely on them as statements of representation of fact, but must satisfy themselves by inspection or otherwise as to their accuracy. No person in this firms employment has the authority to make or give any representation or warranty in respect of the property.