

Chilton Close, Leigh, WN7 1SW
Offers Over £250,000

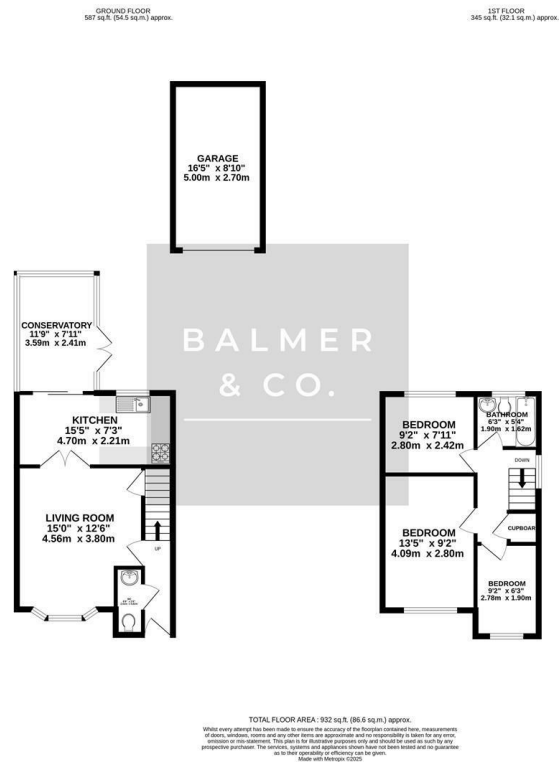

BALMER & CO in LEIGH are delighted to offer FOR SALE this fantastic three bedroom detached home, tucked away on the highly popular Chilton Close in Leigh. Conveniently placed between Leigh & Atherton, offering access to a wide range of amenities, plus ideally offered with no onward chain, it would suit a wide range of buyers. The ground floor comprising in brief; entrance hall, living room, fitted kitchen/diner, conservatory and w.c. To the first floor are two double bedrooms, one single bedroom and a three piece family bathroom suite. Externally, the property is garden fronted with a gated driveway to the side. To the rear there is an enclosed low maintenance garden, with extra land beyond the fence and completed with detached single garage. Early viewings highly recommended, all enquiries welcome.

Floor Plan



Area Map

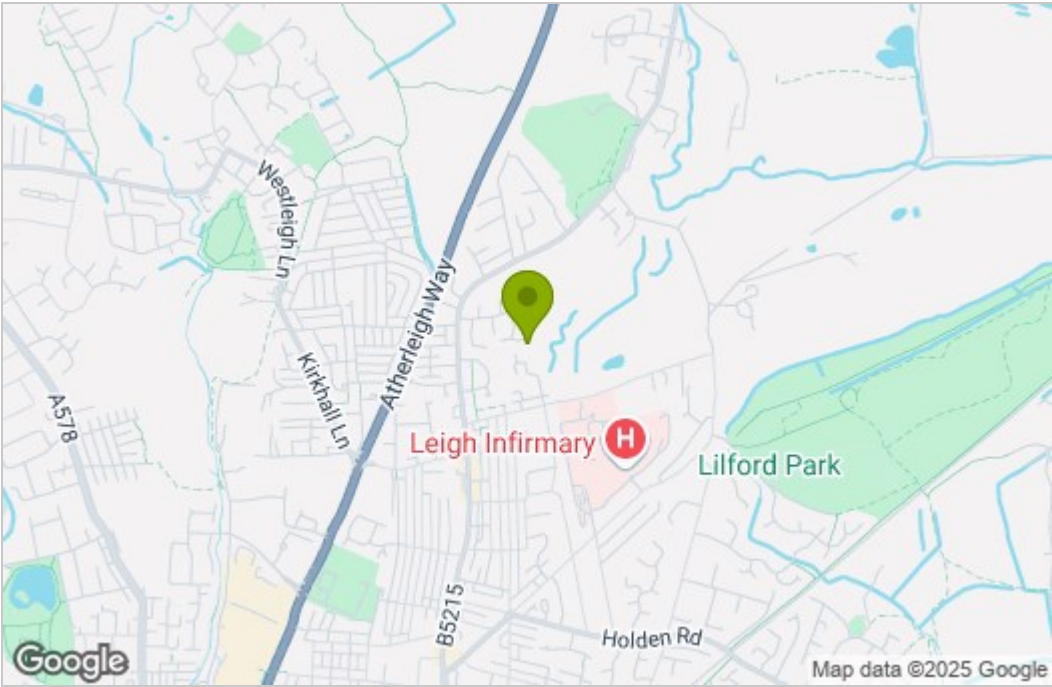

Energy Efficiency Graph

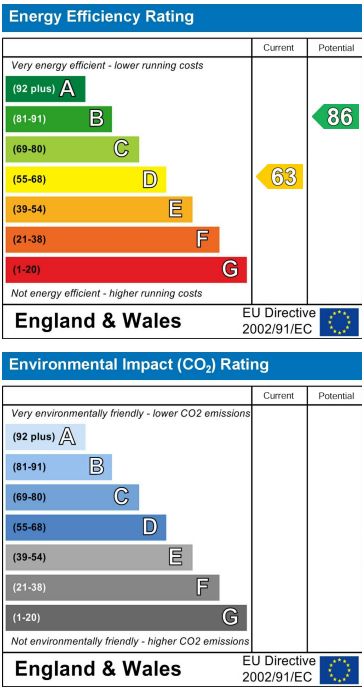

These particulars, whilst believed to be accurate are set out as a general outline only for guidance and do not constitute any part of an offer or contract. Intending purchasers should not rely on them as statements of representation of fact, but must satisfy themselves by inspection or otherwise as to their accuracy. No person in this firm's employment has the authority to make or give any representation or warranty in respect of the property.