

Wigan Road, Leigh, WN7 5DF  
£139,950





BALMER & CO in LEIGH are delighted to offer FOR SALE this fantastic two bedroom mid-terrace house in Leigh. Offered with no onward chain this property is very nicely presented throughout and comprises in brief of large living room, with a modern fitted kitchen/dining room completing the ground floor. To the first floor is a large master bedroom, second single bedroom, with a three piece family bathroom completing the accommodation on offer. Externally the property is garden fronted, whilst to the rear there is a low maintenance, fully enclosed, South-West facing rear yard. Early viewings highly recommended, all enquiries welcome.

Floor Plan

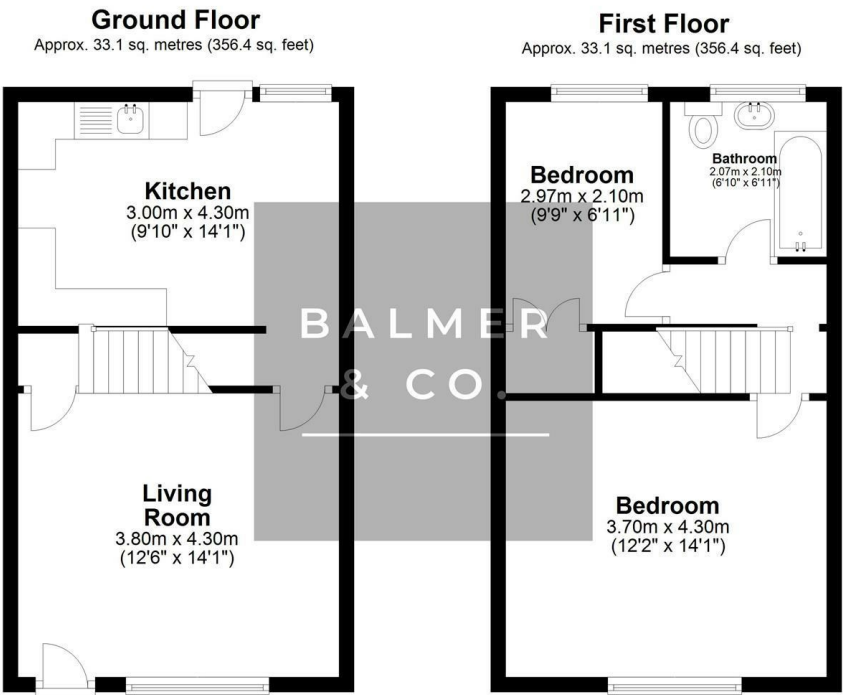

Total area: approx. 66.2 sq. metres (712.8 sq. feet)

Area Map

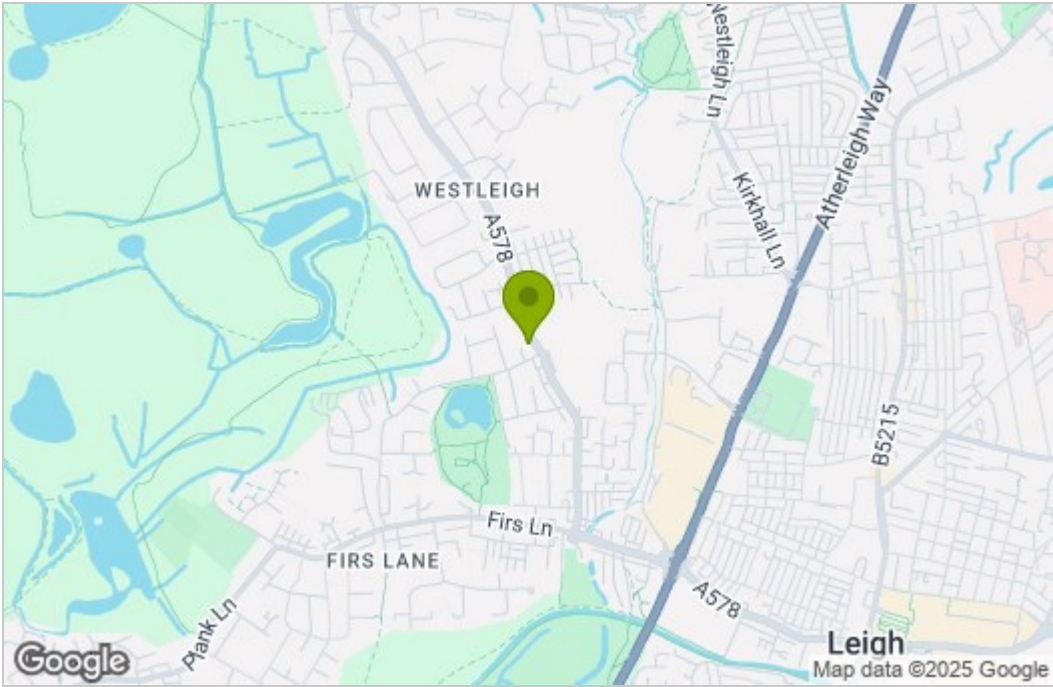

Energy Efficiency Graph

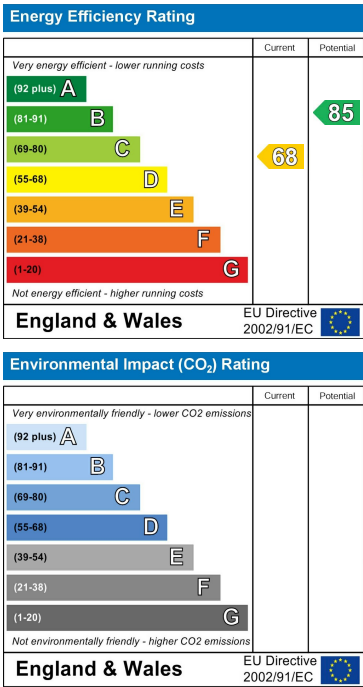

These particulars, whilst believed to be accurate are set out as a general outline only for guidance and do not constitute any part of an offer or contract. Intending purchasers should not rely on them as statements of representation of fact, but must satisfy themselves by inspection or otherwise as to their accuracy. No person in this firms employment has the authority to make or give any representation or warranty in respect of the property.