

Manchester Road, Leigh, WN7 2LL
£210,000

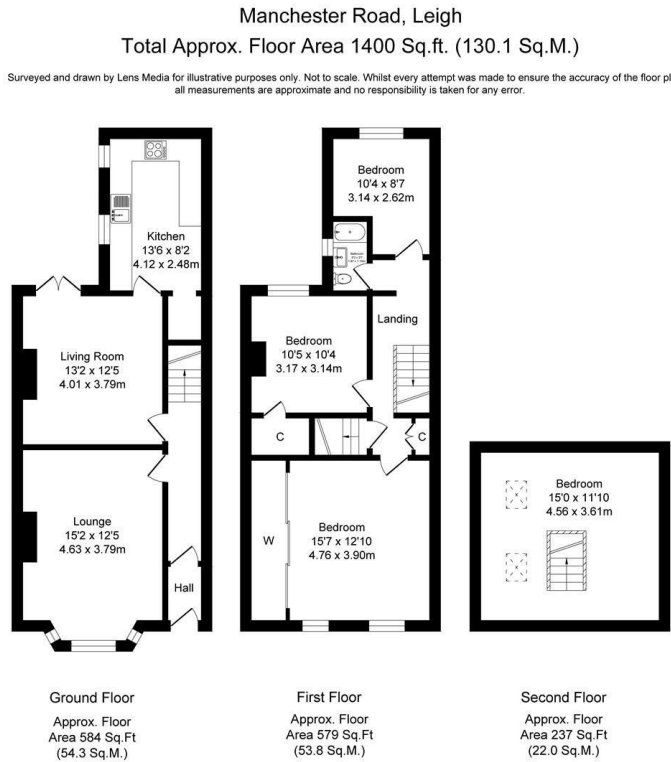

BALMER & CO in LEIGH are delighted to offer FOR SALE this fantastic three bedroom mid-terrace house in Leigh. Offering spacious living accommodation with two reception rooms and a converted loft room, this property is immaculately presented throughout and simply must be viewed. Comprising in brief of entrance porch, hallway, large bay fronted living room, sitting room with stunning brick stove fireplace and French doors leading to the rear garden, with a modern fitted kitchen to the rear with modern integrated appliances completing the ground floor. To the first floor is a large master bedroom with fitted wardrobes, second double bedroom, third single bedroom, modern three piece family bathroom, with a converted loft room with a fixed staircase completing the accommodation on offer. Externally the property is garden fronted, whilst to the rear there is a South facing landscaped garden. Early viewings highly recommended, all enquiries welcome.

Floor Plan



Area Map

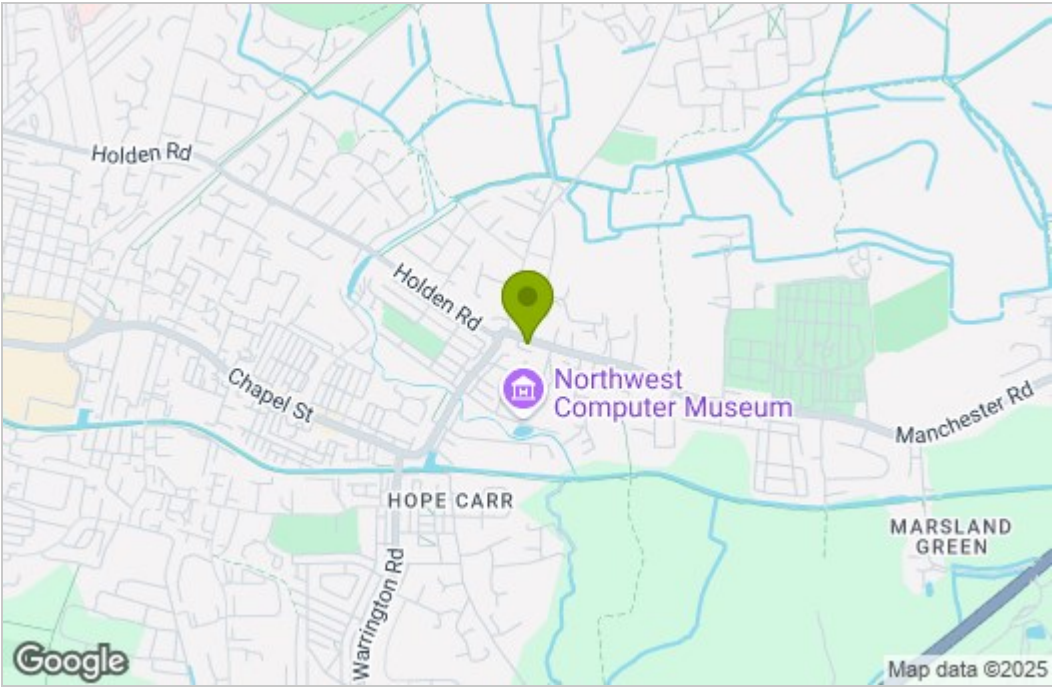

Energy Efficiency Graph

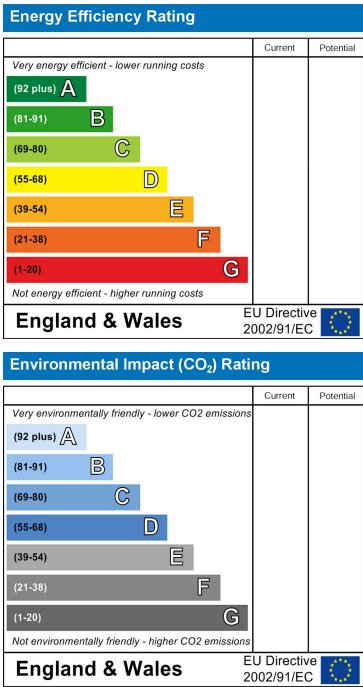

These particulars, whilst believed to be accurate are set out as a general outline only for guidance and do not constitute any part of an offer or contract. Intending purchasers should not rely on them as statements of representation of fact, but must satisfy themselves by inspection or otherwise as to their accuracy. No person in this firms employment has the authority to make or give any representation or warranty in respect of the property.