

Speakman Avenue, Leigh, WN7 2HQ
Offers Over £210,000

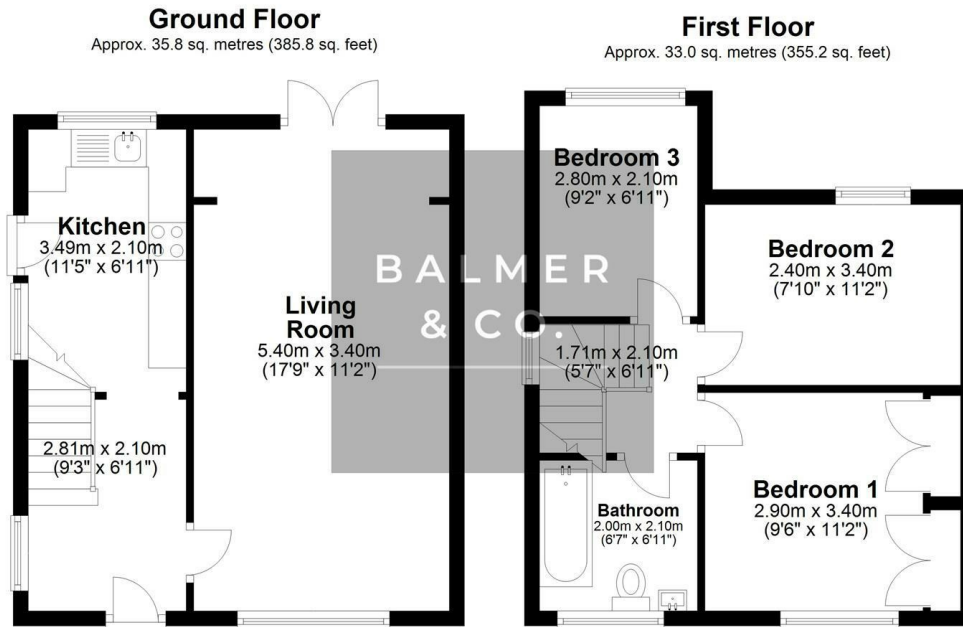

BALMER & CO in LEIGH are delighted to offer FOR SALE this fantastic three bedroom semi-detached house situated in the ever popular Holden Road area of Leigh. Very nicely presented throughout, this property comprises in brief of entrance hallway, large living/dining room with French doors leading to the rear garden, with a modern fitted kitchen completing the ground floor. To the first floor is a large master bedroom with fitted wardrobes, second double bedroom, third single bedroom, with three piece family bathroom completing the accommodation on offer. Externally the property occupies a generous plots with a large driveway to the front providing off-road parking, whilst to the rear there is a low maintenance garden, with a brick built shed. Early viewings highly recommended, all enquiries welcome.

Floor Plan



Total area: approx. 68.8 sq. metres (741.0 sq. feet)

Area Map

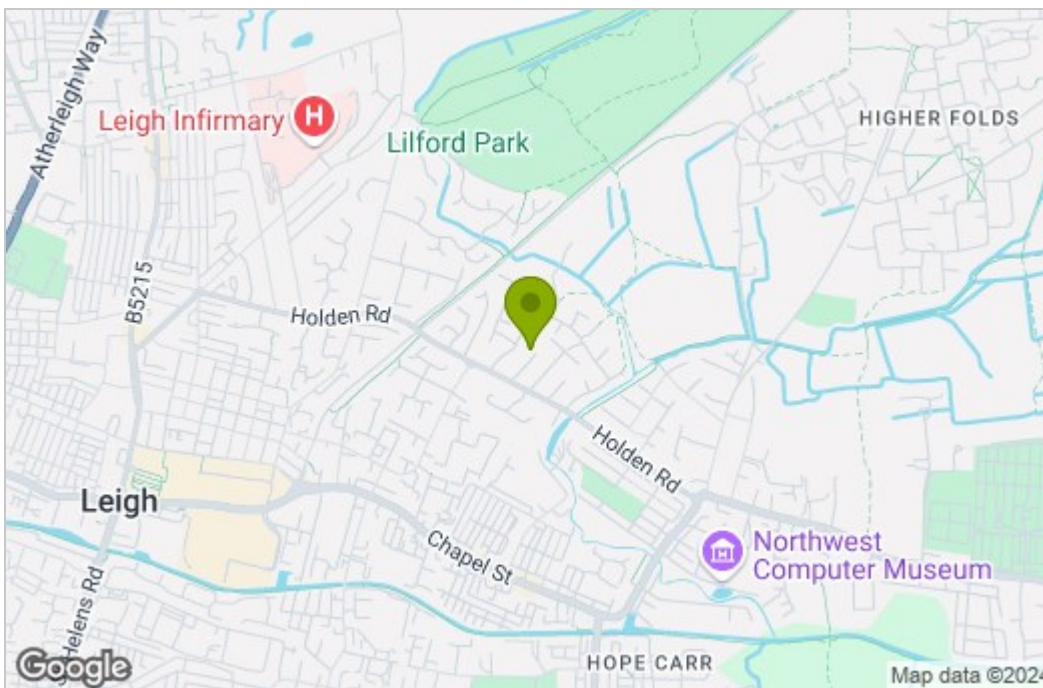

Energy Efficiency Graph

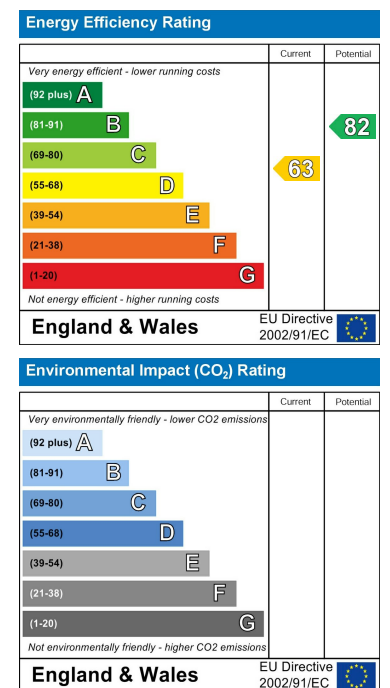

These particulars, whilst believed to be accurate are set out as a general outline only for guidance and do not constitute any part of an offer or contract. Intending purchasers should not rely on them as statements of representation of fact, but must satisfy themselves by inspection or otherwise as to their accuracy. No person in this firm's employment has the authority to make or give any representation or warranty in respect of the property.