



92 Links Road
, Gorleston, NR31 6JX

£695,000



92 Links Road

, Gorleston, NR31 6JX

This spectacular 4 bedroom chalet bungalow offers a unique opportunity to enjoy breathtaking views over the golf course and sea. Enjoy a very generously sized master bedroom with an en-suite, an upstairs balcony boasting glorious views, and a garden that backs directly onto the golf course. The property also benefits from air conditioning, off-road parking for multiple vehicles, and an open fireplace for cozy evenings.

The exterior features a maintainable rear garden with a dedicated sitting area, perfect for relaxing outdoors. With its prime location, the property is just a stone's throw from the beach, providing easy access to the seaside. This home is ideally situated for those seeking both comfort and convenience in a picturesque setting.

Entrance Hall

9'6" x 9'2" (2.9m x 2.8m)

Carpet floor, vaulted ceiling, double glazed window to front, radiator, stairs leading to first floor, access to study and inner hallway.

Bedroom/Study

10'9" x 6'2" (3.3m x 1.9m)

Carpet floor, built in under stairs cupboard, double glazed window to front, built in desk and cupboards.

Inner Hallway

Carpet floor, access to utility, lounge, 2 bedrooms and shower room, radiator.

Lounge

14'9" x 23'7" (4.5m x 7.2m)

Carpet floor, two radiators, double glazed windows to rear, double glazed sliding door to rear, air conditioning unit, decorative fireplace, access to sitting room and kitchen through opening.

Sitting Room/Dining Room

16'0" x 14'1" (max) (4.9m x 4.3 (max))

Carpet floor, double glazed bay window to rear, open fire place, air conditioning unit, radiator, fold away wall bed.

Kitchen

10'9" x 19'0" (3.3m x 5.8m)

Tile floor, double glazed windows to front and side, tiled counter tops with wall mounted and under counter cupboards, integrated oven and grill with gas hob opposite, space for American style fridge freezer, free standing dishwasher, radiator.

Utility

10'9" x 8'6" (3.3m x 2.6m)

Vinyl floor, laminate counter tops, space for washing machine and tumble dryer, under stairs cupboards, double glazed door to side, Vaillant gas combi boiler.

Bedroom 2

10'9" x 6'10" (3.3m x 2.1m)

Carpet floor, radiator, double glazed window to front.

Bedroom 3

10'9" x 8'10" (3.3m x 2.7m)

Carpet floor, double glazed window to side, built in storage, radiator.

Shower room

8'2" x 8'10" (max) (2.5m x 2.7m (max))

Tile floor, WC, basin and vanity unit, shower cubicle with wall mounted shower, double glazed window to front.

Study/Sitting Room

9'10" x 20'8" (3.0m x 6.3m)

Carpet floor, eaves storage, built in double wardrobe, radiator, double glazed window to side, double glazed sliding door to rear. Access to bedroom.





Balcony

Artificial grass, toughened glass boundary.

Bedroom 1

16'0" x 14'1" (4.9m x 4.3m)

Carpet floor, radiator, double glazed window to rear, air conditioning unit, access to en-suite and walk in wardrobe.

En-suite

10'9" x 8'10" (3.3m x 2.7m)

Laminate floor, corner bath tub, WC with hidden cistern, corner shower cubicle with wall mounted shower, basin with vanity unit, heated towel rail, double glazed window to side.

Outside Front

Partially covered brick weave double access driveway, brick wall boundary with decorative shrubs, access around the side to the rear.

Outside Rear

Brick weave floor throughout, concrete patio seating area, car port, with covered outside seating area, shingle area with decorative shrubbery. Short timber fence looking out onto the golf course. Access to buggy garage.

Buggy Garage

Electric roller doors, concrete floor, electric connection, work bench, double glazed window to front and side.

Tenure

Freehold

Services

Mains gas, water, electric, drainage.

Council Tax

Great Yarmouth Borough Council - Band D

Location

Gorleston on Sea is a coastal town 2 miles from Great Yarmouth centre and has a varied selection of local shops * Golf Course * Modern District hospital * Schools for all ages * Library * Regular bus services to the main shopping areas and a sandy beach.

Directions

From our Gorleston office head south along the High Street. At the traffic lights turn right onto Church Lane. At the roundabout turn left onto Middleton Road. At the next roundabout turn right onto Lowestoft Road and continue over two sets of traffic lights and at the next roundabout turn left in to Links Road. Where Links Road leads round to the left into Yallop Avenue, bear right onto the other section of Links Road.

What3Words

///crate.shiny.straying

Ref

G18327/06/25



Floor Plan

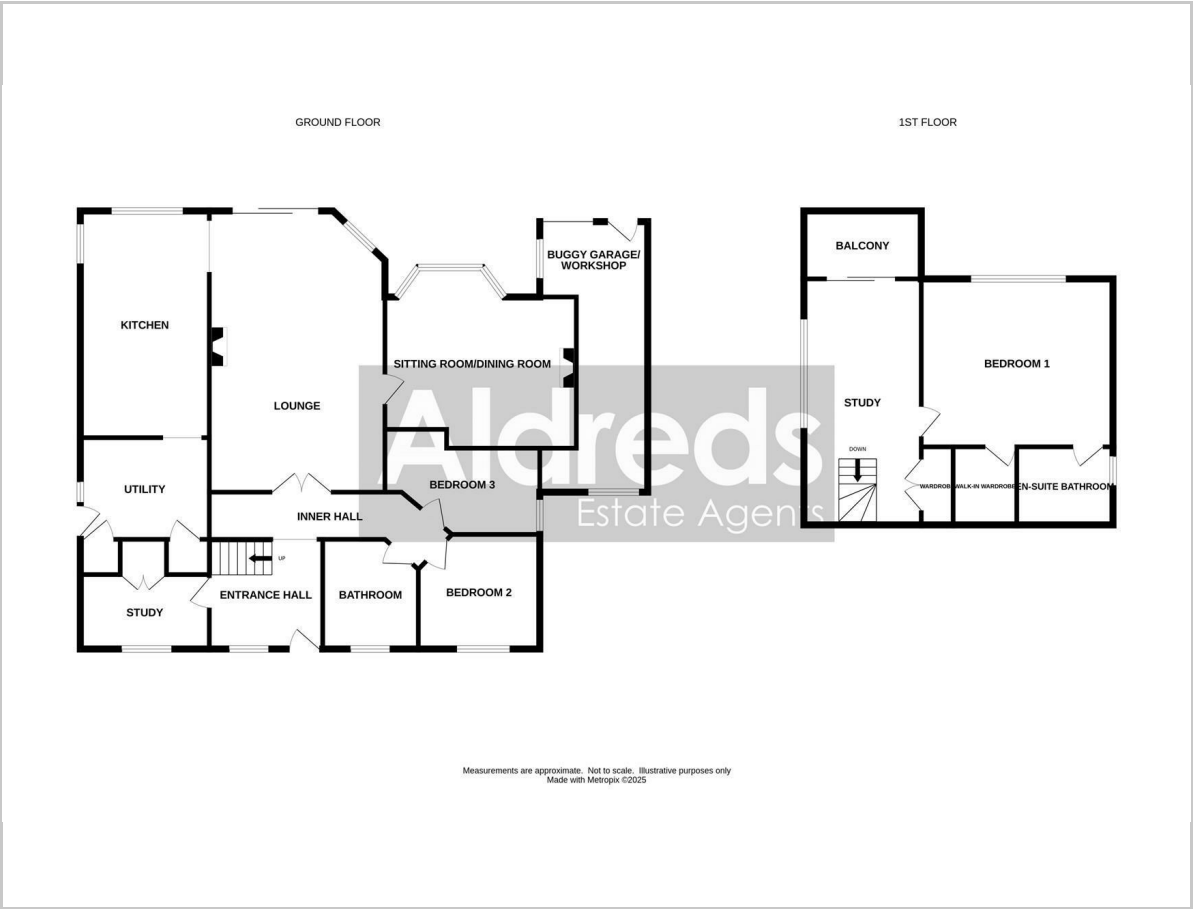

Viewing

Please contact our Aldreds Gorleston Office on 01493 664600 if you wish to arrange a viewing appointment for this property or require further information.

Disclaimer
These particulars are issued on an understanding that all negotiations shall be conducted through Messrs. Aldreds. Please note: Messrs. Aldreds for themselves and for the vendors or lessors of this property whose agents they are given notice that: 1. Particulars are set out as a general outline only for guidance of intending purchasers or lessees, and do not constitute nor constitute part of, an offer or contract. 2. All descriptions, dimensions, references to condition and necessary permissions for use and occupation, and other details are given without responsibility and any intending purchasers or tenants should not rely on them as statements or representations of fact but must satisfy themselves by inspection or otherwise as to the correctness of each of them. 3. No person in the employment of Messrs. Aldreds has any authority to make or give any representation or warranty whatever in relation to this property. 4. If you are proposing to visit the property and are travelling some distance please check with Aldreds on the issue of availability prior to travelling. 5. Aldreds Property Consultants and associated services may offer additional services to the prospective purchaser for which they will be entitled to receive a commission. Aldreds are pleased to be working with Mortgage Advice Bureau. They're an award-winning mortgage broker with over 1,400 advisers across the UK, and have access to over 12,000 mortgage products from over 90 lenders. Aldreds Estate Agents Ltd receive a commission of £200 on each completed case. Your home may be repossessed if you do not keep up repayments on your mortgage. There may be a fee for mortgage advice. The actual amount you pay will depend upon your circumstances. The fee is up to 1%, but a typical fee is 0.3% of the amount borrowed. Mortgage Advice Bureau is a trading name of Mortgage Seeker Limited which is an appointed representative of Mortgage Advice Bureau Limited and Mortgage Advice Bureau (Derby) Limited which are authorised and regulated by the Financial Conduct Authority. Mortgage Seeker Limited Registered Office: Lovewell Blake, Sixty Six North Quay, Great Yarmouth, Norfolk, NR30 1HE. Registered in England Number: 03721415. 6. Potential purchasers should check with their providers that the broadband and mobile phone coverage they would require is available.

Area Map



Energy Efficiency Graph

