

Aldreds
Estate Agents

21 West Avenue

Gorleston, Great Yarmouth, NR31 6JF

£170,000



21 West Avenue

Gorleston, Great Yarmouth, NR31 6JF

Offered with no chain we are pleased to offer this well presented and spacious two bedroom semi detached house. The property has a lounge, kitchen/diner, landing, two bedrooms and a bathroom. Gas central heating and double glazing. Rear garden. There is a brickweave forecourt to front

Lounge

13'10" max 7'0" min x 13'5" max (4.24 max 2.15 min x 4.1 max)

Stairs to landing, door to side, double glazed window to front aspect, radiator

Kitchen/Diner

13'9" x 8'3" (4.21 x 2.54)

Base & wall units with worktops, double glazed window to rear aspect, door to side, under stair cupboard, plumbing for washing machine, electric hob, electric oven, wall mounted gas boiler

Landing

Double glazed window to side aspect

Bedroom 1

13'10" max 7'0" min x 13'1" max (4.24 max 2.15 min x 4.01 max)

Built in wardrobes, loft access, double glazed window to front aspect, radiator

Bedroom 2

8'4" x 8'1" (2.55 x 2.47)

Double glazed window to rear aspect, radiator

Bathroom

5'4" x 5'2" (1.63 x 1.6)

Panel bath with shower over, hand basin, low level WC, part tiled walls, opaque double glazed window to rear aspect

Outside

Brickweave forecourt to front (no dropped kerb). To the rear there is a lawned garden with paved patio and timber shed





Tenure

Leasehold. Ground rent £3 per annum. Remainder of a 999 year lease from 1935

Services

Mains water, electricity, gas, drainage

Council Tax

Band A

Location

Gorleston-on-Sea is a coastal town 2 miles from Great Yarmouth centre and has a varied selection of local shops * Golf Course * Modern District hospital * Schools for all ages * Library * Regular bus services to the main shopping areas and a sandy beach.

Directions

From the Gorleston office head south along the High Street, at the traffic lights turn right into Church Lane, at the roundabout turn left into Middleton Road, continue passed the Water Works, turn left into Elmgrove Road, at the 'T' junction turn right into Lowestoft Road, turn right into West Avenue where the property can be found at the end of the cul-de-sac.

Ref G18296/04/25



Floor Plan

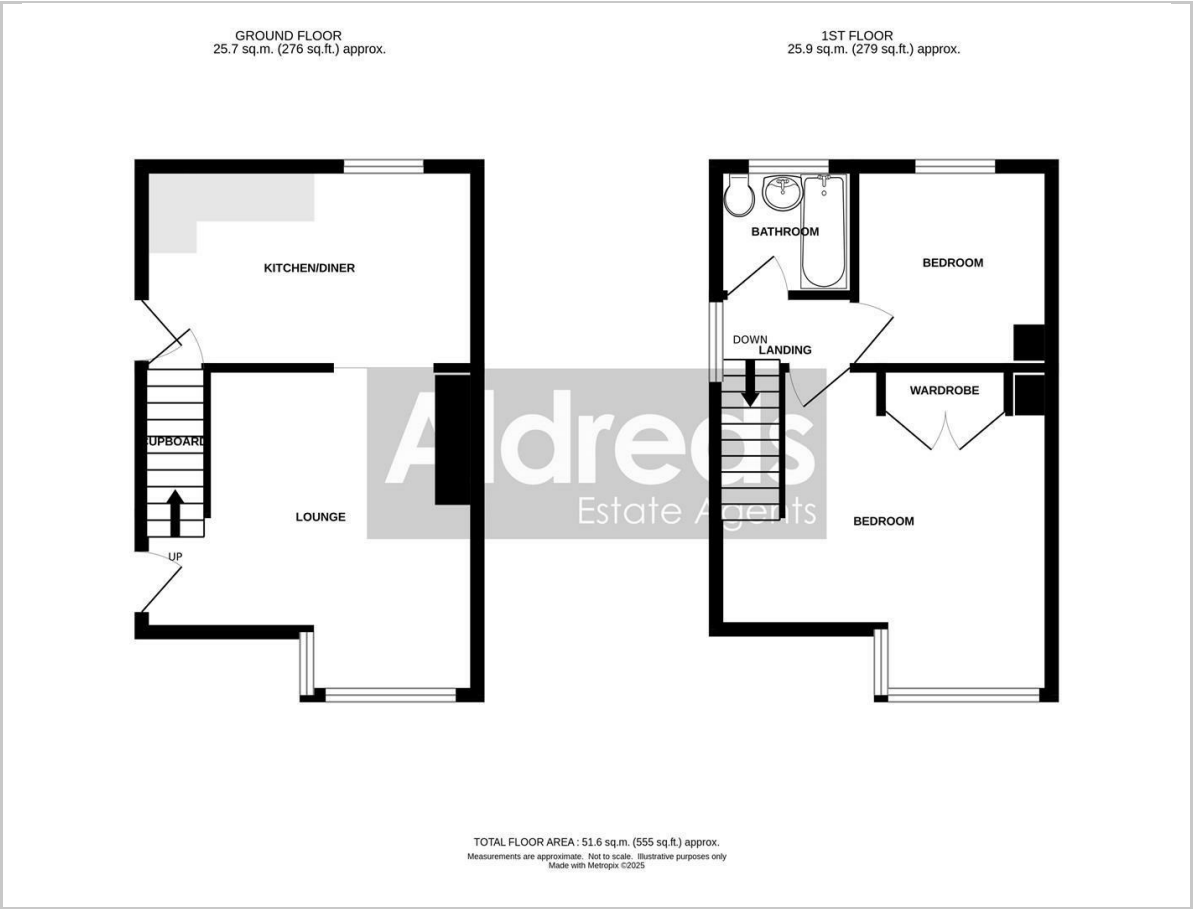

Area Map

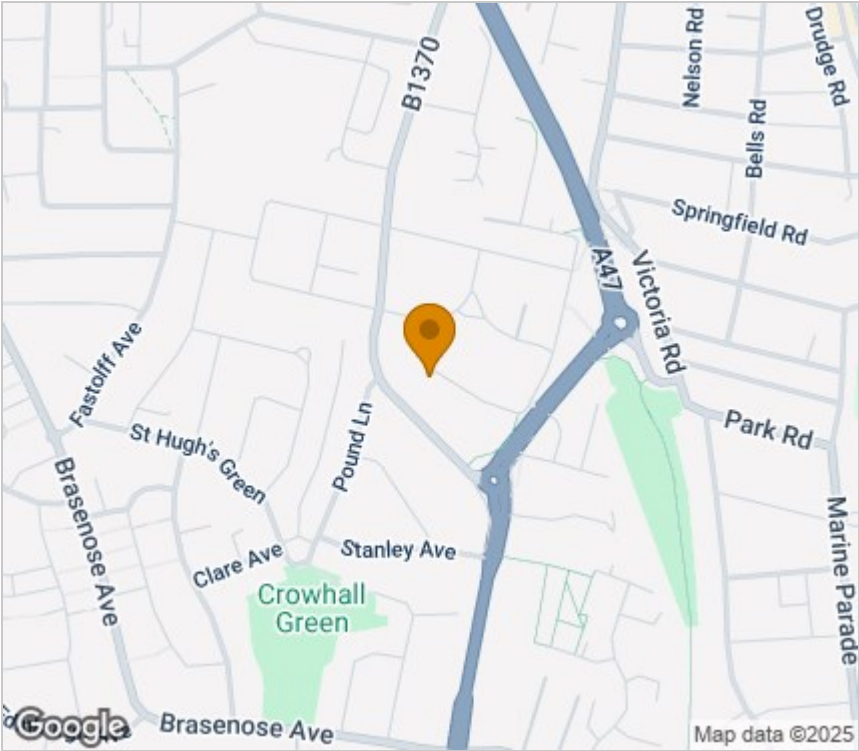

Energy Efficiency Graph

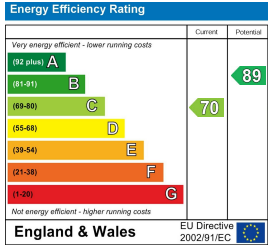

Viewing

Please contact our Aldreds Gorleston Office on 01493 664600 if you wish to arrange a viewing appointment for this property or require further information.

Disclaimer
These particulars are issued on an understanding that all negotiations shall be conducted through Messrs. Aldreds. Please note: Messrs. Aldreds for themselves and for the vendors or lessors of this property whose agents they are given notice that: 1. Particulars are set out as a general outline only for guidance of intending purchasers or lessees, and do not constitute nor constitute part of, an offer or contract. 2. All descriptions, dimensions, references to condition and necessary permissions for use and occupation, and other details are given without responsibility and any intending purchasers or tenants should not rely on them as statements or representations of fact but must satisfy themselves by inspection or otherwise as to the correctness of each of them. 3. No person in the employment of Messrs. Aldreds has any authority to make or give any representation or warranty whatever in relation to this property. 4. If you are proposing to visit the property and are travelling some distance please check with Aldreds on the issue of availability prior to travelling. 5. Aldreds Property Consultants and associated services may offer additional services to the prospective purchaser for which they will be entitled to receive a commission. Aldreds are pleased to be working with Mortgage Advice Bureau. They're an award-winning mortgage broker with over 1,400 advisers across the UK, and have access to over 12,000 mortgage products from over 90 lenders. Aldreds Estate Agents Ltd receive a commission of £200 on each completed case. Your home may be repossessed if you do not keep up repayments on your mortgage. There may be a fee for mortgage advice. The actual amount you pay will depend upon your circumstances. The fee is up to 1%, but a typical fee is 0.3% of the amount borrowed. Mortgage Advice Bureau is a trading name of Mortgage Seeker Limited which is an appointed representative of Mortgage Advice Bureau Limited and Mortgage Advice Bureau (Derby) Limited which are authorised and regulated by the Financial Conduct Authority. Mortgage Seeker Limited Registered Office: Lovewell Blake, Sixty Six North Quay, Great Yarmouth, Norfolk, NR30 1HE. Registered in England Number: 03721415. 6. Potential purchasers should check with their providers that the broadband and mobile phone coverage they would require is available.