

Aldreds
Estate Agents



9 Meadow Court Links Road
Gorleston, Great Yarmouth, NR31 6LB
Offers In Excess Of £300,000



9 Meadow Court Links

Gorleston, Great Yarmouth, NR31 6LB

With an amazing open plan lounge/diner/kitchen, Aldreds are delighted to offer this well presented and recently renovated two bedroom detached sitting on Meadow Court. For occupation by the over 55's. The property also has an entrance hall, bathroom and conservatory. Gas central heating and double glazing. Driveway to former garage now used for storage and approx. south facing garden.

Entrance Hall

Storage cupboard, radiator, door to front

Lounge/Diner/Kitchen

30'3"ax 14'5" in x 16'2" max 8'11" min (9.24max 4.41min x 4.95 max 2.72 min)

Inset ceiling lights, double glazed window to rear aspect, base & wall units with worktops, sink with drainer, plumbing for washing machine, induction hob, electric oven, walk in airing cupboard, wood burner, breakfast bar, solar powered skylight

Conservatory

9'9" x 7'4" (2.98 x 2.24)

Door to garden, sealed unit double glazing

Bedroom 1

11'10" x 10'11" (3.63 x 3.34)

Built in wardrobes, double glazed window to rear aspect, radiator

Bedroom 2

9'8" x 7'3" (2.97 x 2.22)

Double glazed window to front aspect, radiator

Bathroom

7'6" x 6'1" (2.31 x 1.86)

Panel bath, hand basin, low level WC, part tiled walls, opaque double glazed window to side aspect, heated towel rail





Outside

To the front there is a shingle garden. Driveway to former garage now used for storage 2.66m x 2.25m the garage has an up & over door and benefits from power & light. To the rear there is a lawned garden with bushes & shrubs, paved patio

Tenure

Freehold

Services

Mains water, electricity, gas, drainage

Council Tax

Band C

Location

Gorleston on Sea is a coastal town 2 miles from Great Yarmouth centre and has a varied selection of local shops * Golf Course * Modern District hospital * Schools for all ages * Library * Regular bus services to the main shopping areas and a sandy beach.

Directions

From the Gorleston office head south along the High Street, at the traffic lights turn right into Church Lane, at the roundabout turn left into Middleton Road, at the next roundabout turn right into Lowestoft Road, continue over two sets of traffic lights, turn left at the roundabout into Links Road, turn right into Meadow Court where the property can be found on the left hand side.

Ref G18278/04/25

Floor Plan

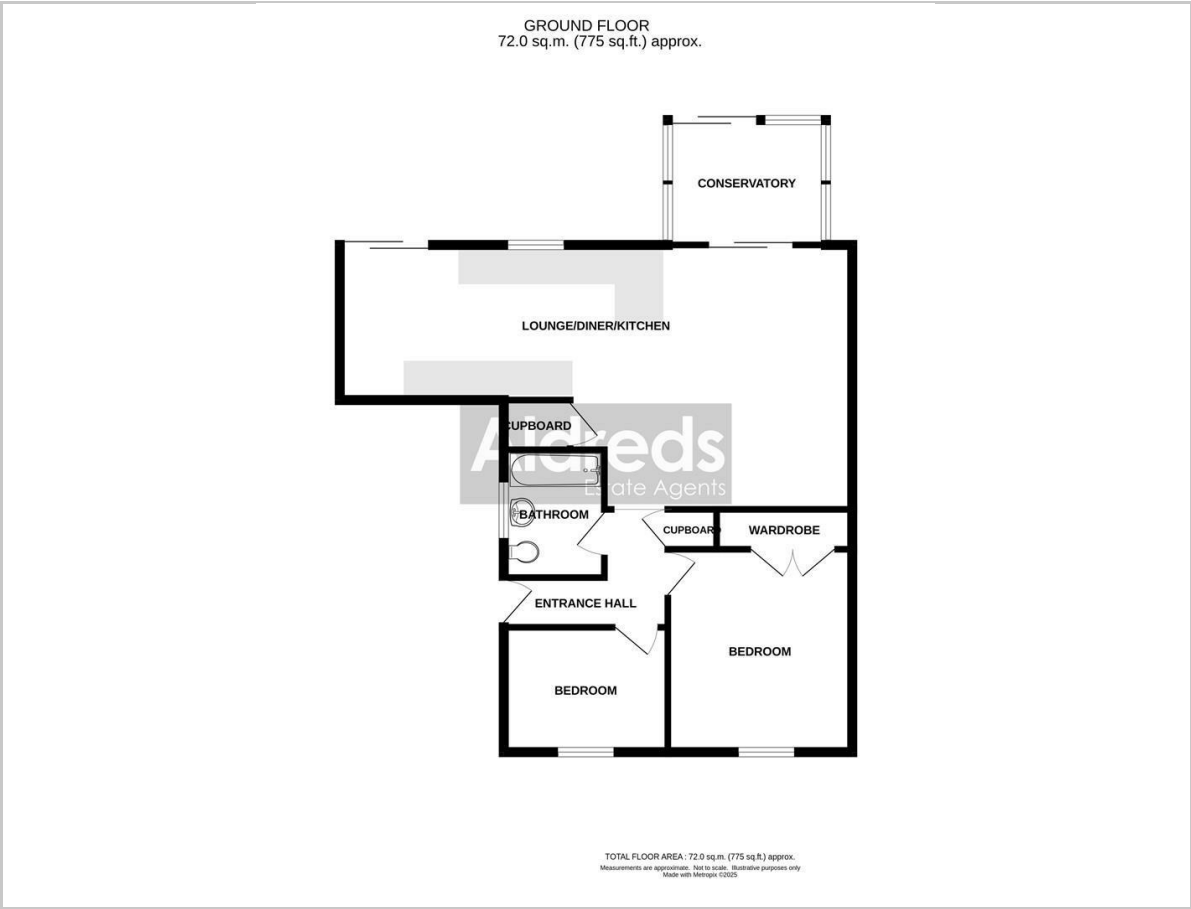

Viewing

Please contact our Aldreds Gorleston Office on 01493 664600 if you wish to arrange a viewing appointment for this property or require further information.

Disclaimer
These particulars are issued on an understanding that all negotiations shall be conducted through Messrs. Aldreds. Please note: Messrs. Aldreds for themselves and for the vendors or lessors of this property whose agents they are given notice that: 1. Particulars are set out as a general outline only for guidance of intending purchasers or lessees, and do not constitute nor constitute part of, an offer or contract. 2. All descriptions, dimensions, references to condition and necessary permissions for use and occupation, and other details are given without responsibility and any intending purchasers or tenants should not rely on them as statements or representations of fact but must satisfy themselves by inspection or otherwise as to the correctness of each of them. 3. No person in the employment of Messrs. Aldreds has any authority to make or give any representation or warranty whatever in relation to this property. 4. If you are proposing to visit the property and are travelling some distance please check with Aldreds on the issue of availability prior to travelling. 5. Aldreds Property Consultants and associated services may offer additional services to the prospective purchaser for which they will be entitled to receive a commission. Aldreds are pleased to be working with Mortgage Advice Bureau. They're an award-winning mortgage broker with over 1,400 advisers across the UK, and have access to over 12,000 mortgage products from over 90 lenders. Aldreds Estate Agents Ltd receive a commission of £200 on each completed case. Your home may be repossessed if you do not keep up repayments on your mortgage. There may be a fee for mortgage advice. The actual amount you pay will depend upon your circumstances. The fee is up to 1%, but a typical fee is 0.3% of the amount borrowed. Mortgage Advice Bureau is a trading name of Mortgage Seeker Limited which is an appointed representative of Mortgage Advice Bureau Limited and Mortgage Advice Bureau (Derby) Limited which are authorised and regulated by the Financial Conduct Authority. Mortgage Seeker Limited Registered Office: Lovewell Blake, Sixty Six North Quay, Great Yarmouth, Norfolk, NR30 1HE. Registered in England Number: 03721415. 6. Potential purchasers should check with their providers that the broadband and mobile phone coverage they would require is available.

Area Map



Energy Efficiency Graph

