

Aldreds
Estate Agents



Tree Tops Jews Lane

Bradwell, Great Yarmouth, NR31 8PU

£325,000



Tree Tops Jews Lane

Bradwell, Great Yarmouth, NR31 8PU

A well presented, extremely spacious, four bedroom detached bungalow situated in this highly desirable cul-de-sac in the village of Bradwell. The property offers the benefits of two reception rooms, spacious kitchen/breakfast room, four bedrooms (one with dressing room), bathroom and separate cloakroom. Gas central heating and sealed unit double glazing. Outside there are front & rear gardens and a driveway to front. Carpets as fitted are included in the asking price.

Entrance Hall

Entrance door, opaque double glazed window to side aspect, storage cupboard, radiator.

Lounge

23'4" x 12'0" (7.11 x 3.66 (7.12 x 3.65))

Double glazed window to front aspect, two double glazed windows to side aspect, radiator.

Dining Room

10'1" x 7'10" (3.07 x 2.39 (3.084 x 2.394))

Double glazed window to rear aspect, radiator.

Side Hallway

Door to front.

Kitchen/Breakfast Room

20'9" max x 8'4" (6.32 max x 2.54 (6.330 max x 2.55))

Base and wall mounted storage units with roll top work surfaces over, stainless steel sink and drainer with mixer tap over, integrated dishwasher, breakfast bar, gas cooker point, door to side, two double glazed windows to side aspect, radiator.

Cloakroom

Low level WC pedestal hand wash basin, opaque double glazed window to front aspect.

Bedroom 1

11'1" x 8'0" (3.38 x 2.44 (3.384 x 2.450))

Double glazed window to rear aspect, electric heater, walk in dressing room with two built in wardrobes

Bedroom 2

12'0" x 8'2" (3.66 x 2.49 (3.647 x 2.5))

Double glazed window to side aspect, storage cupboard, electric heater

Bedroom 3

11'7" x 8'1" (3.53 x 2.46 (3.524 x 2.456))

Double glazed window to side aspect, radiator.





Bedroom 4

11'7" x 7'8" (3.53 x 2.34 (3.52 x 2.348))

Double glazed window to front aspect, radiator.

Bathroom

7'8" x 7'5" (2.34 x 2.26)

Panel bath, pedestal hand wash basin, low level WC, storage cupboard, opaque double glazed window to rear aspect, radiator.

Outside

To the front of the property there is a shingle driveway. Enclosed front garden with decking and artificial grass. To the rear of the property there is a paved and decked garden, timber shed.

Tenure

Freehold.

Services

Mains water, electric, gas, drainage.

Council Tax

Great Yarmouth Borough Council - Band 'C'

Location

Bradwell is a popular residential area adjoining Gorleston 2 miles from Great Yarmouth Town centre * There are a variety of local shops * Schools * Medical centre * Regular bus services to the main shopping areas * Indoor swimming pool and recreation areas.

Directions

From the Gorleston office head south along the High Street, at the traffic lights turn right into Church Lane, continue over the roundabout and the next set of traffic lights into Crab Lane, at the 'T' junction turn left into Beccles Road, continue over the traffic lights past Primrose Way, turn left into Jews Lane where the property can be found on the right hand side.

Ref: G18148/09/24

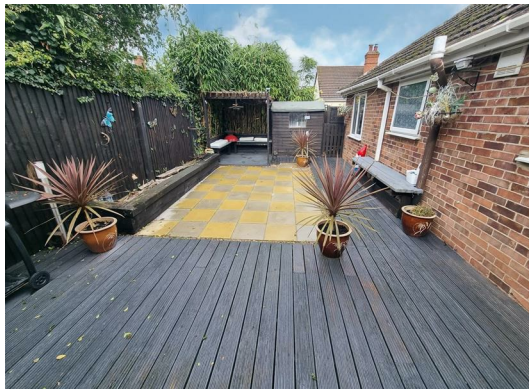

Floor Plan

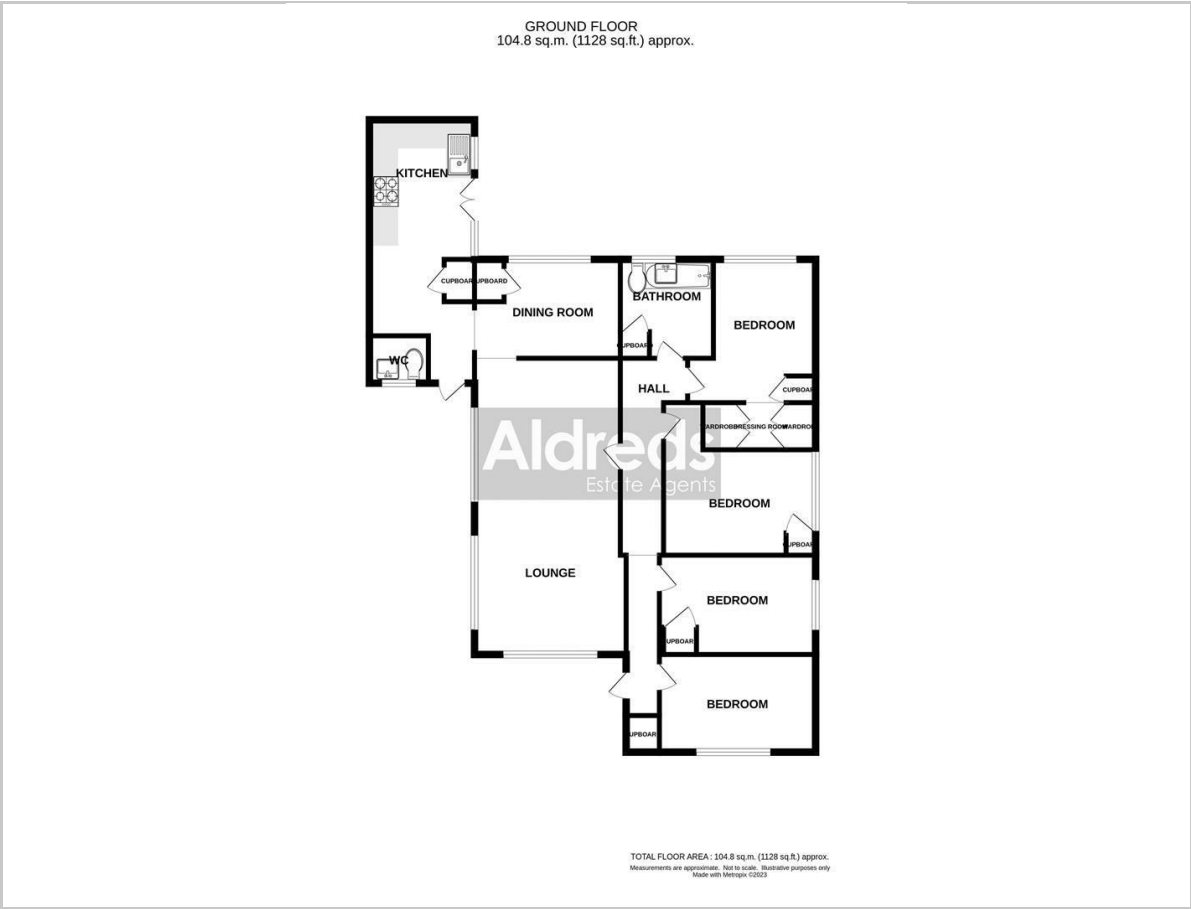

Viewing

Please contact our Aldreds Gorleston Office on 01493 664600 if you wish to arrange a viewing appointment for this property or require further information.

Disclaimer
These particulars are issued on an understanding that all negotiations shall be conducted through Messrs. Aldreds. Please note: Messrs. Aldreds for themselves and for the vendors or lessors of this property whose agents they are given notice that: 1. Particulars are set out as a general outline only for guidance of intending purchasers or lessees, and do not constitute nor constitute part of, an offer or contract. 2. All descriptions, dimensions, references to condition and necessary permissions for use and occupation, and other details are given without responsibility and any intending purchasers or tenants should not rely on them as statements or representations of fact but must satisfy themselves by inspection or otherwise as to the correctness of each of them. 3. No person in the employment of Messrs. Aldreds has any authority to make or give any representation or warranty whatever in relation to this property. 4. If you are proposing to visit the property and are travelling some distance please check with Aldreds on the issue of availability prior to travelling. 5. Aldreds Property Consultants and associated services may offer additional services to the prospective purchaser for which they will be entitled to receive a commission. Aldreds are pleased to be working with Mortgage Advice Bureau. They're an award-winning mortgage broker with over 1,400 advisers across the UK, and have access to over 12,000 mortgage products from over 90 lenders. Aldreds Estate Agents Ltd receive a commission of £200 on each completed case. Your home may be repossessed if you do not keep up repayments on your mortgage. There may be a fee for mortgage advice. The actual amount you pay will depend upon your circumstances. The fee is up to 1%, but a typical fee is 0.3% of the amount borrowed. Mortgage Advice Bureau is a trading name of Mortgage Seeker Limited which is an appointed representative of Mortgage Advice Bureau Limited and Mortgage Advice Bureau (Derby) Limited which are authorised and regulated by the Financial Conduct Authority. Mortgage Seeker Limited Registered Office: Lovewell Blake, Sixty Six North Quay, Great Yarmouth, Norfolk, NR30 1HE. Registered in England Number: 03721415. 6. Potential purchasers should check with their providers that the broadband and mobile phone coverage they would require is available.

Area Map

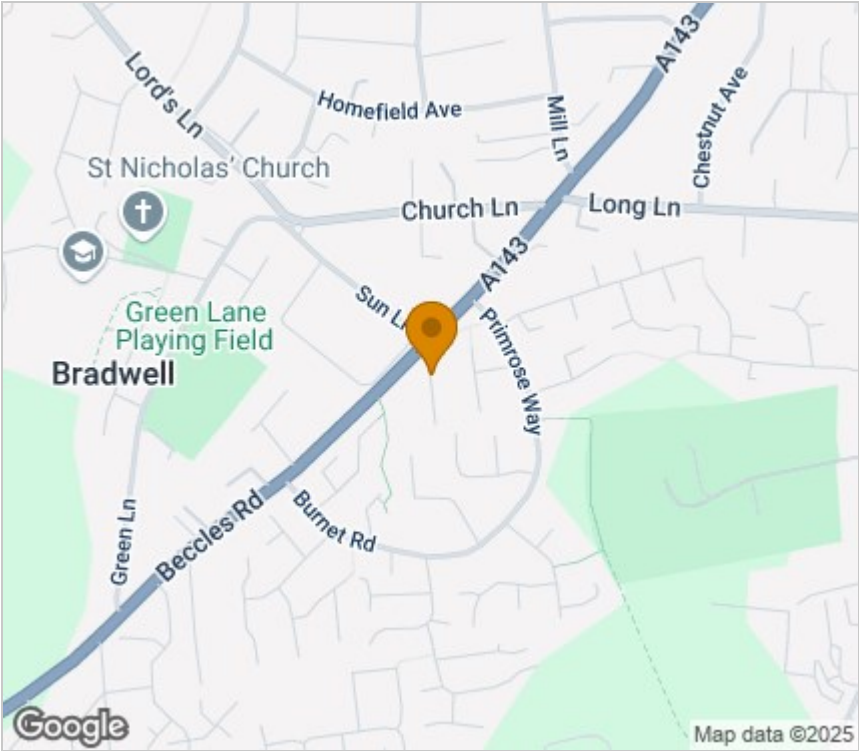

Energy Efficiency Graph

