



17 Caledonian Way

Belton, Great Yarmouth, NR31 9PQ

Guide Price £240,000 - £250,000



3



1



2



D

17 Caledonian Way

Belton, Great Yarmouth, NR31

Guide Price £240,000 - £250,000 With extensions to front & back and a driveway leading to garage Aldreds are delighted to offer this spacious, well presented three bedroom end terrace house. On the ground floor there is a large entrance hall, lounge and a spacious open plan sitting room/dining room/kitchen/study. The first floor has three good sized bedrooms and a bathroom leading off landing. Gas central heating and sealed unit double glazing. Front & rear gardens.

Entrance Hall

Stairs rising to landing, storage cupboard, door to front, radiator.

Lounge

12'9" x 10'1" (3.9 x 3.08)

Double glazed window to front aspect, radiator.

Sitting Room/Dining Room/Kitchen/Study

Sitting Room/Dining Room area

16'1" x 8'8" (4.92 x 2.66)

Radiator.

Study area

7'9" x 7'4" (2.38 x 2.24)

Double glazed French doors to rear garden, radiator.

Kitchen area

10'9" x 7'4" (3.29 x 2.24)

Base & wall units with worktops, double glazed window to rear aspect, stainless steel sink with drainer, electric hob, electric oven, inset ceiling lights, plumbing for washing machine, integrated fridge freezer, integrated dishwasher.

Landing

Loft access, airing cupboard with wall mounted gas boiler, double glazed window to side aspect.

Bedroom 1

12'9" x 8'0" (3.9 x 2.44)

Double glazed window to front aspect, radiator.

Bedroom 2

12'8" x 7'8" (3.87 x 2.36)

Double glazed window to front aspect, radiator.





Bedroom 3

9'2" x 8'10" (2.8 x 2.7)

Double glazed window to rear aspect, radiator.

Bathroom

6'6" x 5'4" (2 x 1.65)

Panel bath, hand basin, low level WC, opaque double glazed window to rear aspect, radiator.

Outside

To the front there is a garden and a driveway leading to garage. To the rear there is a paved garden with bushes and shrubs.

Tenure

Freehold

Services

Mains water, electricity, gas, drainage.

Council Tax

Band B

EPC

D Rating - 59

Location

Belton is situated 3 miles west of Gorleston and 5 miles from Great Yarmouth * There are a selection of local shops * Primary and Middle schools * The River Waveney runs through the adjoining village of Burgh Castle with its historic Roman site and Marina * There are regular bus services to Great Yarmouth.

Directions

Leave Gorleston on the A143 Beccles Road, continue through Bradwell turning right at the roundabout into New Road, continue into Belton, continue over the mini roundabout, at the 'T' junction turn right into Bracon Road, turn right into Heather Road, turn right into Caledonian Way.

Ref G18085/05/24



Floor Plan

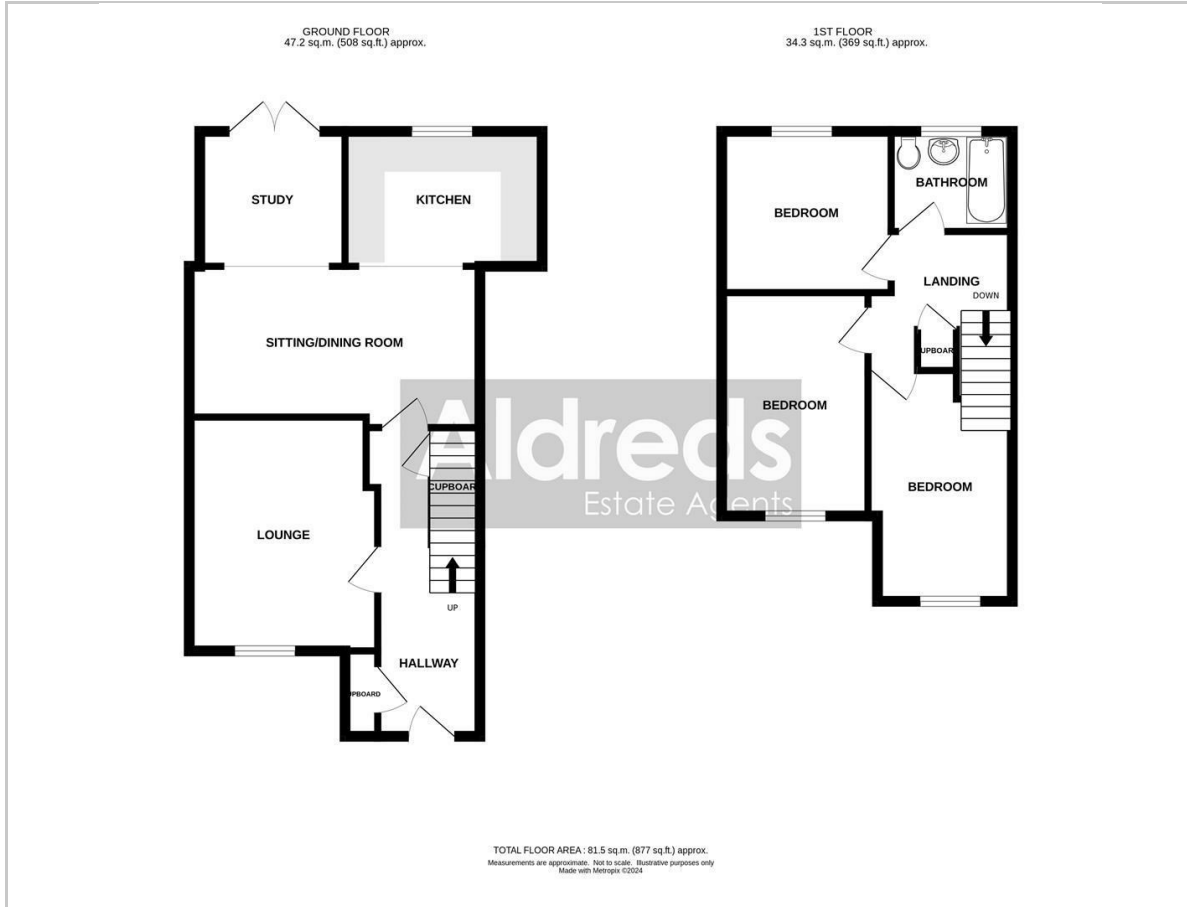

Viewing

Please contact our Aldreds Gorleston Office on 01493 664600 if you wish to arrange a viewing appointment for this property or require further information.

Disclaimer

These particulars are issued on an understanding that all negotiations shall be conducted through Messrs. Aldreds. Please note: Messrs. Aldreds for themselves and for the vendors or lessors of this property whose agents they are given notice that: 1. Particulars are set out as a general outline only for guidance of intending purchasers or lessees, and do not constitute nor constitute part of, an offer or contract. 2. All descriptions, dimensions, references to condition and necessary permissions for use and occupation, and other details are given without responsibility and any intending purchasers or tenants should not rely on them as statements or representations of fact but must satisfy themselves by inspection or otherwise as to the correctness of each of them. 3. No person in the employment of Messrs. Aldreds has any authority to make or give any representation or warranty whatever in relation to this property. 4. If you are proposing to visit the property and are travelling some distance please check with Aldreds on the issue of availability prior to travelling. 5. Aldreds Property Consultants and associated services may offer additional services to the prospective purchaser for which they will be entitled to receive a commission. Aldreds are pleased to be working with Mortgage Advice Bureau. They're an award-winning mortgage broker with over 1,400 advisers across the UK, and have access to over 12,000 mortgage products from over 90 lenders. Aldreds Estate Agents Ltd receive a commission of £200 on each completed case. Your home may be repossessed if you do not keep up repayments on your mortgage. There may be a fee for mortgage advice. The actual amount you pay will depend upon your circumstances. The fee is up to 1%, but a typical fee is 0.3% of the amount borrowed. Mortgage Advice Bureau is a trading name of Mortgage Seeker Limited which is an appointed representative of Mortgage Advice Bureau Limited and Mortgage Advice Bureau (Derby) Limited which are authorised and regulated by the Financial Conduct Authority. Mortgage Seeker Limited Registered Office: Lovewell Blake, Sixty Six North Quay, Great Yarmouth, Norfolk, NR30 1HE. Registered in England Number: 03721415. 6. Potential purchasers should check with their providers that the broadband and mobile phone coverage they would require is available.

Area Map

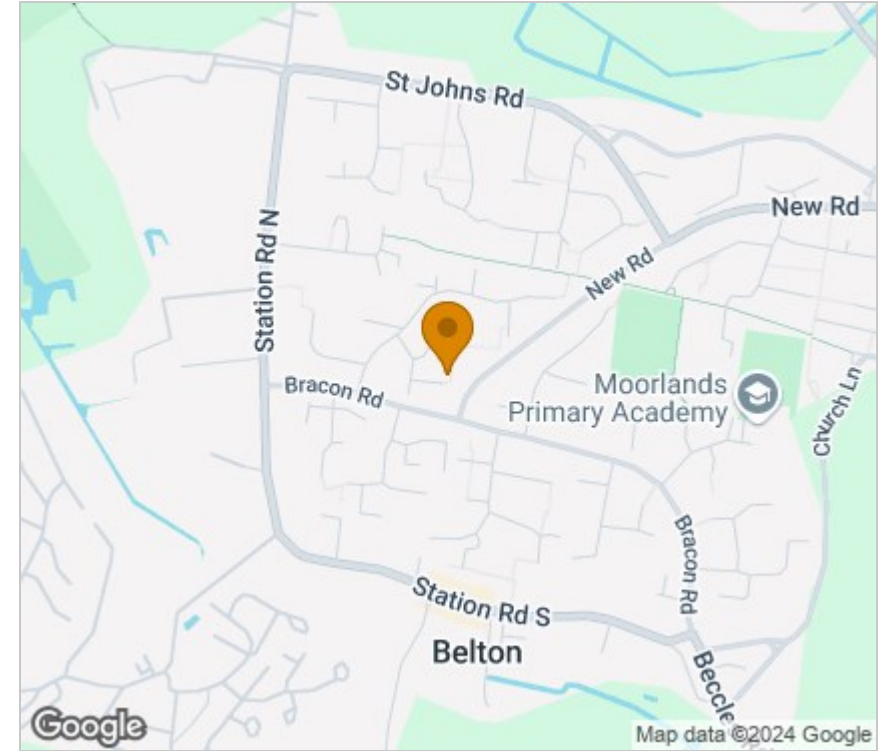

Energy Efficiency Graph

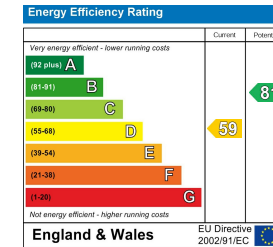

149 High Street, Gorleston, Norfolk, NR31 6RB
Tel: 01493 664600 Email: gorleston@aldreds.co.uk <https://www.aldreds.co.uk/>

Registered in England Reg. No. 08945751 Registered Office: 66 North Quay, Great Yarmouth, Norfolk NR30 1HE Directors: Mark Duffield B.S.c. FRICS. Dan Crawley MNAEA Paul Lambert MNAEA