

Aldreds
Estate Agents



74 Middleton Road

Gorleston, Great Yarmouth, NR31 7AH

Guide Price £260,000 - £270,000



3



1



2



D

74 Middleton Road

Gorleston, Great Yarmouth,

** GUIDE PRICE £260,000 - £270,000** A spacious, extended and well positioned bay fronted three bedroom semi detached house sitting on Middleton Road. On the ground floor there is an entrance porch, entrance hall, lounge, dining room, extended kitchen/breakfast room and a cloakroom. On the first floor there are three bedrooms, a bathroom and WC. Gas central heating (boiler installed 2022) and sealed unit double glazing. Driveway. Gardens to front & rear.

Entrance Porch

Door to front.

Entrance Hall

Stairs to landing, under stair cupboard, radiator.

Lounge

11'10" x 11'5" (3.62 x 3.5)

Bay double glazed window to front aspect, radiator.

Dining Room

12'1" x 11'0" (3.7 x 3.37)

Fully working traditional feature fireplace, double glazed window to rear aspect, radiator.

Cloakroom

Hand basin, low level WC, opaque double glazed window to front aspect.

Kitchen/Breakfast Room

19'9" x 10'0" (6.02 x 3.05)

Base & wall units with worktops, double glazed window to side aspect, double glazed window to rear aspect, gas hob, electric oven, sink with drainer, plumbing for washing machine, part tiled walls, wall mounted gas boiler.

Landing

Double glazed window to front aspect, radiator.

Bedroom 1

11'11" x 11'6" (3.64 x 3.51)

Double glazed window to front aspect, radiator.





Bedroom 2

12'2" x 11'0" (3.72 x 3.37)

Double glazed window to rear aspect radiator.

Bedroom 3

10'0" x 8'3" (3.06 x 2.52)

Double glazed window to rear aspect, radiator.

Bathroom

Panel bath, hand basin, opaque double glazed window to side aspect, radiator.

WC

Low level WC, opaque double glazed window to side aspect.

Outside

To the front there is a brickweave driveway and a lawned garden. To the rear there is a decked patio and astroturf garden.

Tenure

Freehold.

Services

Mains water, electricity, gas, drainage.

Council Tax

Band C

EPC

D rating - 66

Location

Gorleston on Sea is a coastal town 2 miles from Great Yarmouth centre and has a varied selection of local shops * Golf Course * Modern District hospital * Schools for all ages * Library * Regular bus services to the main shopping areas and a sandy beach which is a short walk away.

Direction

From the Gorleston office head south along the High Street, at the traffic lights turn right, at the roundabout turn left in to Middleton Road where the property is on the right.

Ref G18038/04/24



Floor Plan

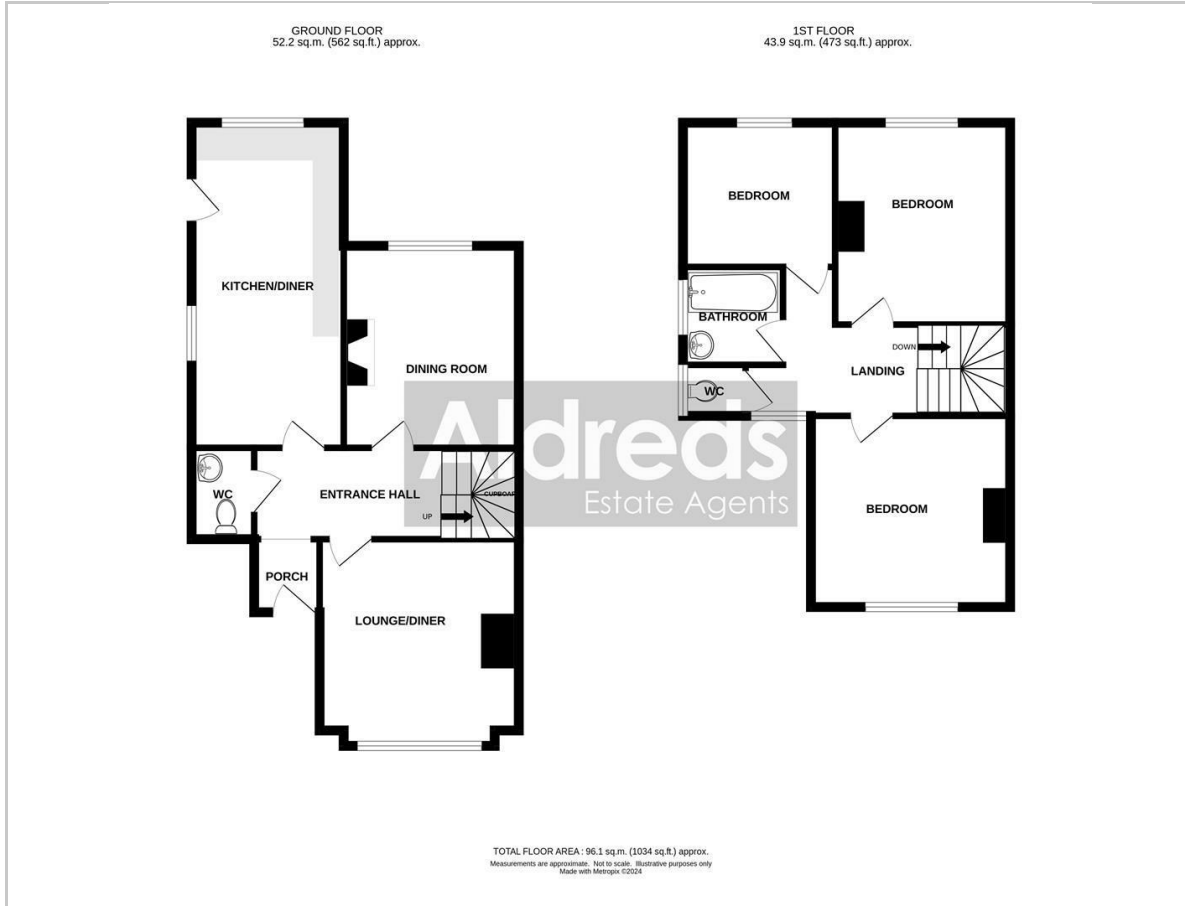

Viewing

Please contact our Aldreds Gorleston Office on 01493 664600 if you wish to arrange a viewing appointment for this property or require further information.

Disclaimer

These particulars are issued on an understanding that all negotiations shall be conducted through Messrs. Aldreds. Please note: Messrs. Aldreds for themselves and for the vendors or lessors of this property whose agents they are given notice that: 1. Particulars are set out as a general outline only for guidance of intending purchasers or lessees, and do not constitute nor constitute part of, an offer or contract. 2. All descriptions, dimensions, references to condition and necessary permissions for use and occupation, and other details are given without responsibility and any intending purchasers or tenants should not rely on them as statements or representations of fact but must satisfy themselves by inspection or otherwise as to the correctness of each of them. 3. No person in the employment of Messrs. Aldreds has any authority to make or give any representation or warranty whatever in relation to this property. 4. If you are proposing to visit the property and are travelling some distance please check with Aldreds on the issue of availability prior to travelling. 5. Aldreds Property Consultants and associated services may offer additional services to the prospective purchaser for which they will be entitled to receive a commission.

Aldreds are pleased to be working with Mortgage Advice Bureau. They're an award-winning mortgage broker with over 1,400 advisers across the UK, and have access to over 12,000 mortgage products from over 90 lenders. Aldreds Estate Agents Ltd receive a commission of £200 on each completed case. Your home may be repossessed if you do not keep up repayments on your mortgage. The actual amount you pay will depend upon your circumstances. The fee is up to 1%, but a typical fee is 0.3% of the amount borrowed. Mortgage Advice Bureau is a trading name of Mortgage Seeker Limited which is an appointed representative of Mortgage Advice Bureau Limited and Mortgage Advice Bureau (Derby) Limited which are authorised and regulated by the Financial Conduct Authority. Mortgage Seeker Limited Registered Office: Lovewell Blake, Sixty Six North Quay, Great Yarmouth, Norfolk, NR30 1HE. Registered in England Number: 03721415. 6. Potential purchasers should check with their providers that the broadband and mobile phone coverage they would require is available.

Area Map



Energy Efficiency Graph

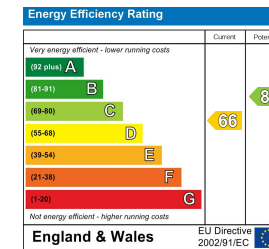

149 High Street, Gorleston, Norfolk, NR31 6RB
Tel: 01493 664600 Email: gorleston@aldreds.co.uk <https://www.aldreds.co.uk/>

Registered in England Reg. No. 08945751 Registered Office: 66 North Quay, Great Yarmouth, Norfolk NR30 1HE Directors: Mark Duffield B.S.c. FRICS. Dan Crawley MNAEA Paul Lambert MNAEA