

Aldreds
Estate Agents



291 El Alamein Way

Bradwell, Great Yarmouth, NR31 8TX

Offers In Excess Of £325,000



3



2



2



D

291 El Alamein Way

Bradwell, Great Yarmouth, NR31

A very spacious and well presented executive style three bedroom detached bungalow. The property offers an entrance hall, lounge, dining room, kitchen, utility room, conservatory, master bedroom with ensuite, two further bedrooms and a bathroom. Gas central heating and sealed unit double glazing. Gardens and a driveway leading to a large garage.

Entrance Hall

Door to front, radiator, loft access.

Lounge

15'9" x 13'3" (4.82 x 4.04)

Double glazed window to front aspect, radiator.

Dining Room

10'11" x 9'11" (3.34 x 3.03)

Radiator, double glazed patio doors to :-

Conservatory

11'1" x 8'3" (3.4 x 2.52)

Brick based with sealed unit double glazing, double glazed French doors to garden.

Kitchen

10'10" x 9'8" (3.32 x 2.95)

Base & wall units with worktops, double glazed window to rear aspect, electric hob, electric oven, sink with drainer and mixer tap, part tiled walls, tiled floor.

Utility Room

8'5" x 5'9" (2.57 x 1.76)

Base units with worktops, door to rear, stainless steel sink with drainer, tiled floor.

Master Bedroom

Double glazed window to rear aspect, radiator, door to :-

Ensuite Shower Room

Shower in cubicle, hand basin, low level WC, opaque double glazed window to side aspect, radiator.

Bedroom 2

11'6" x 10'4" (3.52 x 3.16)

Double glazed window to front aspect, radiator.

Bedroom 3

10'0" x 9'9" (3.05 x 2.99)

Double glazed window to front aspect, radiator.





Bathroom

9'11" x 6'9" (3.04 x 2.07)

Panel bath, hand basin, low level WC opaque double glazed window to side aspect, radiator.

Outside

To the front of the property there is a brick weave garden with driveway leading to garage. The garage is larger than average measuring 8.72 x 3.1 with power & light. To the rear there is a good sized lawned garden with paved and brick weave patios.

Tenure

Freehold

Council Tax

Band E

Services

Mains water, electricity, gas, drainage

EPC

D Rating - 65

Location

Bradwell is a popular residential area adjoining Gorleston 2 miles from Great Yarmouth Town centre * There are a variety of local shops * Schools * Medical centre * Regular bus services to the main shopping areas * Indoor swimming pool and recreation areas.

Directions

From our Gorleston office head north along the High Street, continue in to High Road, turn left in to Beccles Road, at the roundabout turn right in to Burgh Road, continue into Bradwell, continue over the mini roundabout, at the next roundabout turn left in and turn right after the doctors in to Mill Lane, turn left in to El Alamein Way, take the first turning on the right and turn right at the T junction where the property is on the left.

Ref G18027/03/24



Floor Plan

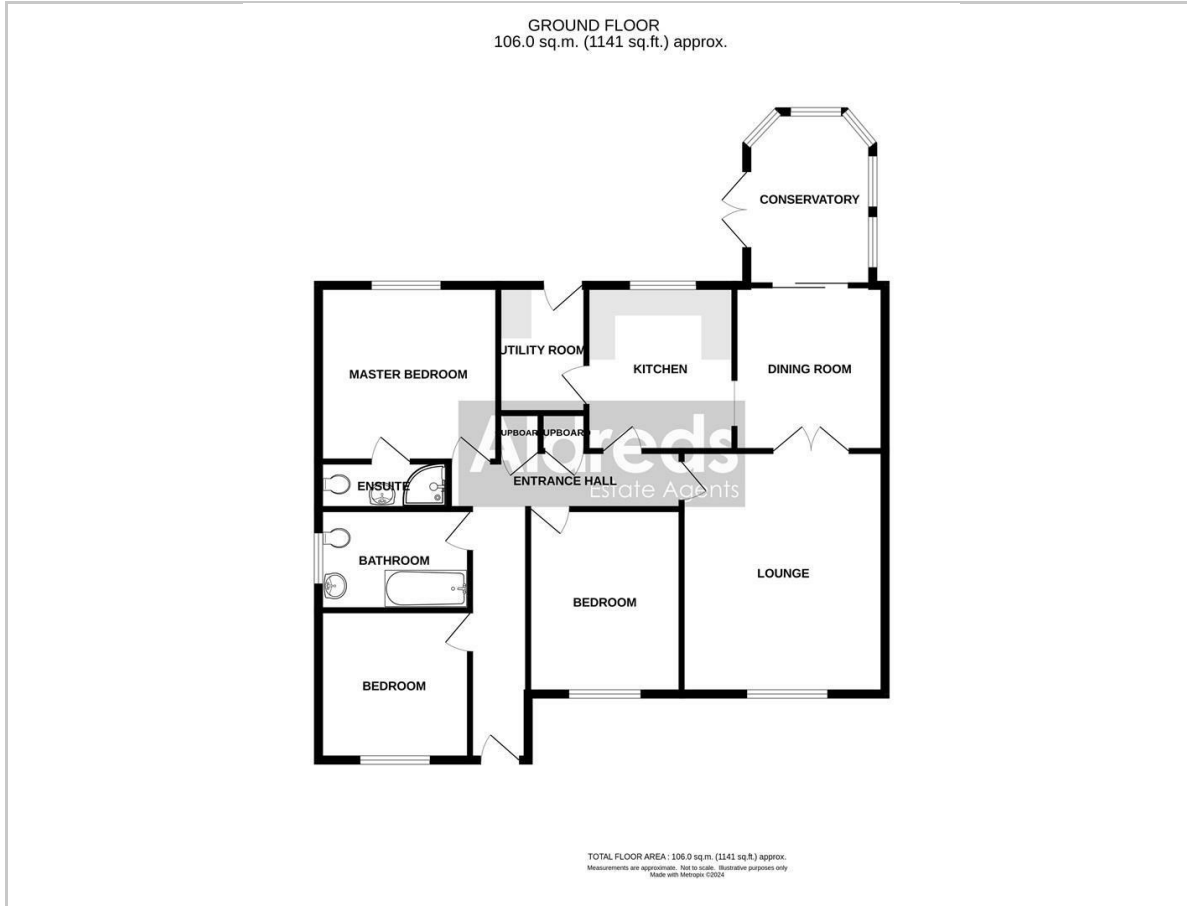

Viewing

Please contact our Aldreds Gorleston Office on 01493 664600 if you wish to arrange a viewing appointment for this property or require further information.

Disclaimer

These particulars are issued on an understanding that all negotiations shall be conducted through Messrs. Aldreds. Please note: Messrs. Aldreds for themselves and for the vendors or lessors of this property whose agents they are given notice that: 1. Particulars are set out as a general outline only for guidance of intending purchasers or lessees, and do not constitute nor constitute part of, an offer or contract. 2. All descriptions, dimensions, references to condition and necessary permissions for use and occupation, and other details are given without responsibility and any intending purchasers or tenants should not rely on them as statements or representations of fact but must satisfy themselves by inspection or otherwise as to the correctness of each of them. 3. No person in the employment of Messrs. Aldreds has any authority to make or give any representation or warranty whatever in relation to this property. 4. If you are proposing to visit the property and are travelling some distance please check with Aldreds on the issue of availability prior to travelling. 5. Aldreds Property Consultants and associated services may offer additional services to the prospective purchaser for which they will be entitled to receive a commission.

Aldreds are pleased to be working with Mortgage Advice Bureau. They're an award-winning mortgage broker with over 1,400 advisers across the UK, and have access to over 12,000 mortgage products from over 90 lenders. Aldreds Estate Agents Ltd receive a commission of £200 on each completed case. Your home may be repossessed if you do not keep up repayments on your mortgage. There may be a fee for mortgage advice. The actual amount you pay will depend upon your circumstances. The fee is up to 1%, but a typical fee is 0.3% of the amount borrowed. Mortgage Advice Bureau is a trading name of Mortgage Seeker Limited which is an appointed representative of Mortgage Advice Bureau Limited and Mortgage Advice Bureau (Derby) Limited which are authorised and regulated by the Financial Conduct Authority. Mortgage Seeker Limited Registered Office: Lovewell Blake, Sixty Six North Quay, Great Yarmouth, Norfolk, NR30 1HE. Registered in England Number: 03721415. 6. Potential purchasers should check with their providers that the broadband and mobile phone coverage they would require is available.

Area Map

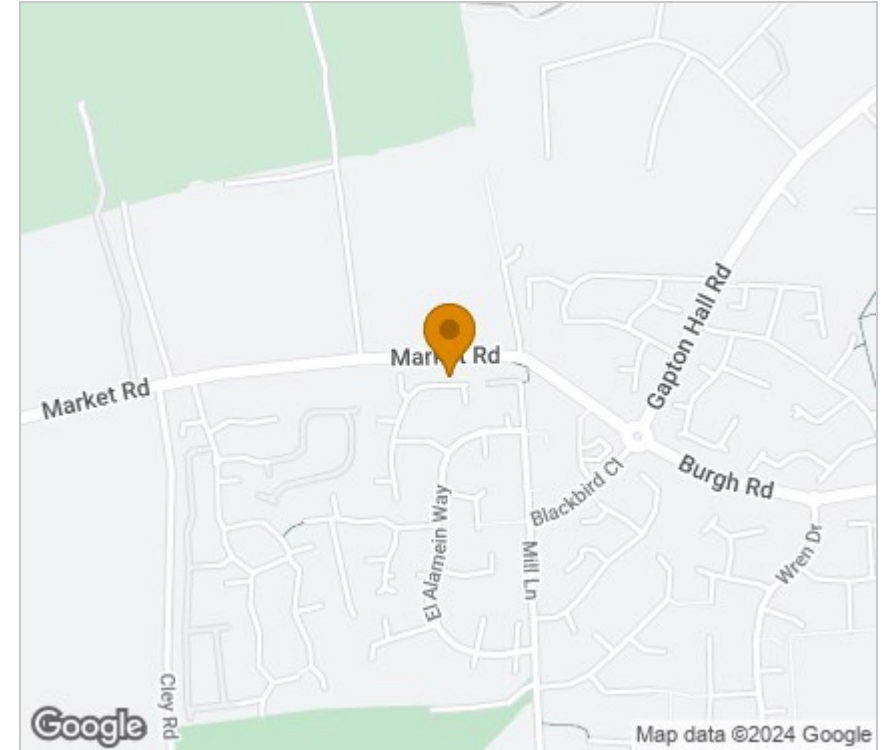

Energy Efficiency Graph

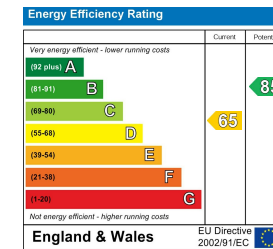

149 High Street, Gorleston, Norfolk, NR31 6RB
Tel: 01493 664600 Email: gorleston@aldreds.co.uk <https://www.aldreds.co.uk/>

Registered in England Reg. No. 08945751 Registered Office: 66 North Quay, Great Yarmouth, Norfolk NR30 1HE Directors: Mark Duffield B.S.c. FRICS. Dan Crawley MNAEA Paul Lambert MNAEA