



10 Noel Close

Hopton, Great Yarmouth, NR31 9RT

£320,000



10 Noel Close

Hopton, Great Yarmouth, NR31 9RT

Sitting in the popular coastal village of Hopton-on-Sea, with a large conservatory and good size garden to rear, Aldreds are pleased to offer this well presented modern three bedroom detached bungalow. The property has an entrance hall, large lounge/dining room, kitchen, conservatory, utility room, three bedrooms, shower room, separate WC. Gas central heating and sealed unit double glazing. To the front of the property there is a driveway leading to garage. To the rear of the property there is a good size garden with large patio area. Carpets as fitted are included in the asking price. The property is offered with no upward chain.

Entrance Hall

Door to front, loft access, radiator.

Lounge/Dining Room

21'0" x 13'10" (6.40 x 4.22)

Double glazed window to rear aspect, radiator, double glazed patio doors to:-

Conservatory

14'5" x 9'6" (4.39 x 2.90)

Sealed unit double glazing, double glazed patio doors to rear garden.

Kitchen

9'9" x 8'0" (2.97 x 2.44)

Base and wall mounted storage units with roll top work surfaces over, double glazed window to rear aspect, sink with drainer with mixer tap over, electric hob, electric oven, integrated washing machine, integrated fridge/freezer, door to:-

Utility Room

16'0" max x 5'7" max (max x max) (4.88 max x 1.70 max (4.87 max x max))

Door to front, door to garden.

Bedroom 1

13'1" x 9'11" (3.99 x 3.02)

Double glazed window to front aspect, radiator.

Bedroom 2

9'7" x 9'1" (2.92 x 2.77)

Double glazed window to front aspect, radiator.





Bedroom 3

9'7" x 7'5" (2.92 x 2.26)

Double glazed window to front aspect, radiator.

Shower Room

9'9" x 5'3" (2.97 x 1.60)

Shower in cubicle, hand basin, low level WC, opaque double glazed window to side aspect, radiator.

Separate WC

Low level WC, hand basin, opaque double glazed window to side aspect, part tiled walls, radiator.

Outside

To the front of the property there is a garden, driveway leading to garage, the garage has an up and over door. To the rear of the property there is a good size well kept lawned garden with bushes shrubs and plants, large patio area, greenhouse, shed.

Tenure

Freehold

Services

Mains water, electricity, gas and drainage.

Council Tax

Great Yarmouth Borough Council - Band C

Location

Part of the beautiful south Norfolk coast, Hopton on Sea is a village and seaside resort found on east coast of Norfolk just 5 miles south of Great Yarmouth and 3 miles north of Lowestoft in Suffolk. Hopton-on-Sea is perhaps best known for being the host of the World Indoor Bowls Championships offering a well catered for tourist industry, visitors and locals alike can enjoy the village amenities which include leisure facilities, pubs and restaurants, primary school, village hall, church, post office and local shops. Bus links provide access to the Cathedral City of Norwich, Great Yarmouth and Lowestoft.

Directions

Leave Gorleston heading South along the A47, at the Hopton roundabout turn left, at the 'T' junction turn left into Lowestoft Road, continue up the hill and past the playing field, turn right into Noel Close where the property can be found on the left hand side.

Ref: G17882/06/23



Floor Plan

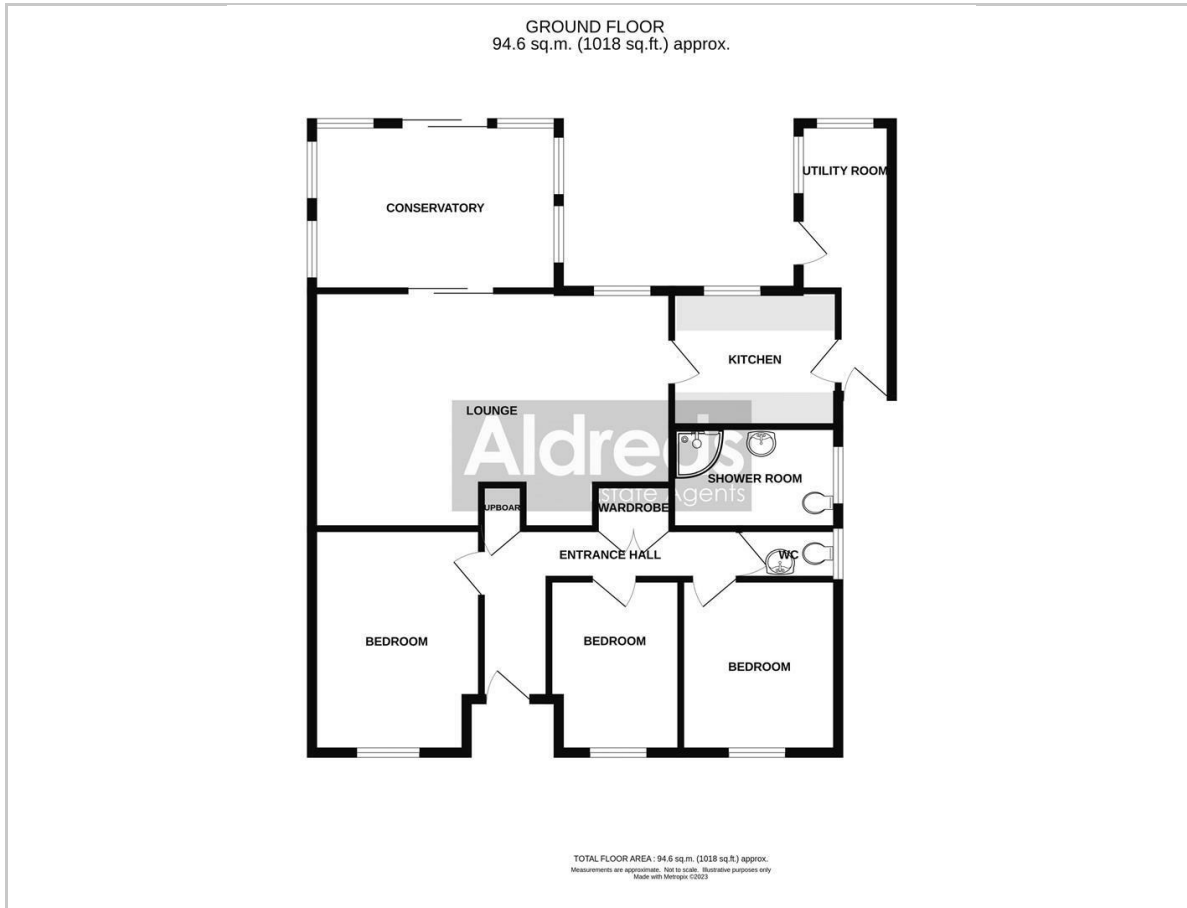

Viewing

Please contact our Aldreds Gorleston Office on 01493 664600 if you wish to arrange a viewing appointment for this property or require further information.

Disclaimer

These particulars are issued on an understanding that all negotiations shall be conducted through Messrs. Aldreds. Please note: Messrs. Aldreds for themselves and for the vendors or lessors of this property whose agents they are given notice that: 1. Particulars are set out as a general outline only for guidance of intending purchasers or lessees, and do not constitute nor constitute part of, an offer or contract. 2. All descriptions, dimensions, references to condition and necessary permissions for use and occupation, and other details are given without responsibility and any intending purchasers or tenants should not rely on them as statements or representations of fact but must satisfy themselves by inspection or otherwise as to the correctness of each of them. 3. No person in the employment of Messrs. Aldreds has any authority to make or give any representation or warranty whatever in relation to this property. 4. If you are proposing to visit the property and are traveling some distance please check with Aldreds on the issue of availability prior to traveling. 5. Aldreds Property Consultants and associated services may offer additional services to the prospective purchaser for which they will be entitled to receive a commission.

Aldreds are pleased to be working with Mortgage Advice Bureau. They're an award-winning mortgage broker with over 1,400 advisers across the UK, and have access to over 12,000 mortgage products from over 90 lenders. Aldreds Estate Agents Ltd receive a commission of £200 on each completed case. Your home may be repossessed if you do not keep up repayments on your mortgage. There may be a fee for mortgage advice. The actual amount you pay will depend upon your circumstances. The fee is up to 1%, but a typical fee is 0.3% of the amount borrowed. Mortgage Advice Bureau is a trading name of Mortgage Seeker Limited which is an appointed representative of Mortgage Advice Bureau Limited and Mortgage Advice Bureau (Derby) Limited which are authorised and regulated by the Financial Conduct Authority. Mortgage Seeker Limited Registered Office: Lovewell Blake, Sixty Six North Quay, Great Yarmouth, Norfolk, NR30 1HE. Registered in England Number: 372141.

Area Map

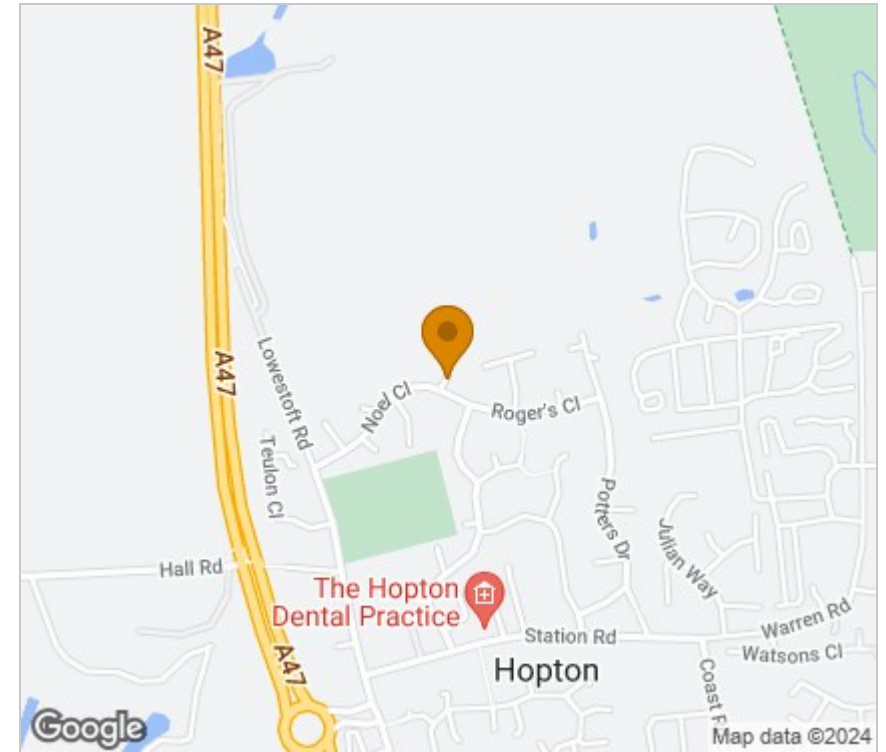

Energy Efficiency Graph

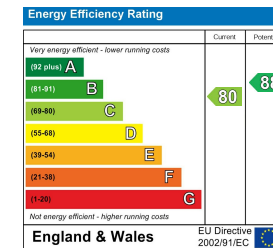

149 High Street, Gorleston, Norfolk, NR31 6RB
Tel: 01493 664600 Email: gorleston@aldreds.co.uk <https://www.aldreds.co.uk/>

Registered in England Reg. No. 08945751 Registered Office: 66 North Quay, Great Yarmouth, Norfolk NR30 1HE Directors: Mark Duffield B.S.c. FRICS. Dan Crawley MNAEA Paul Lambert MNAEA